

GROUP 12 - FENDERS AND SHEET METAL

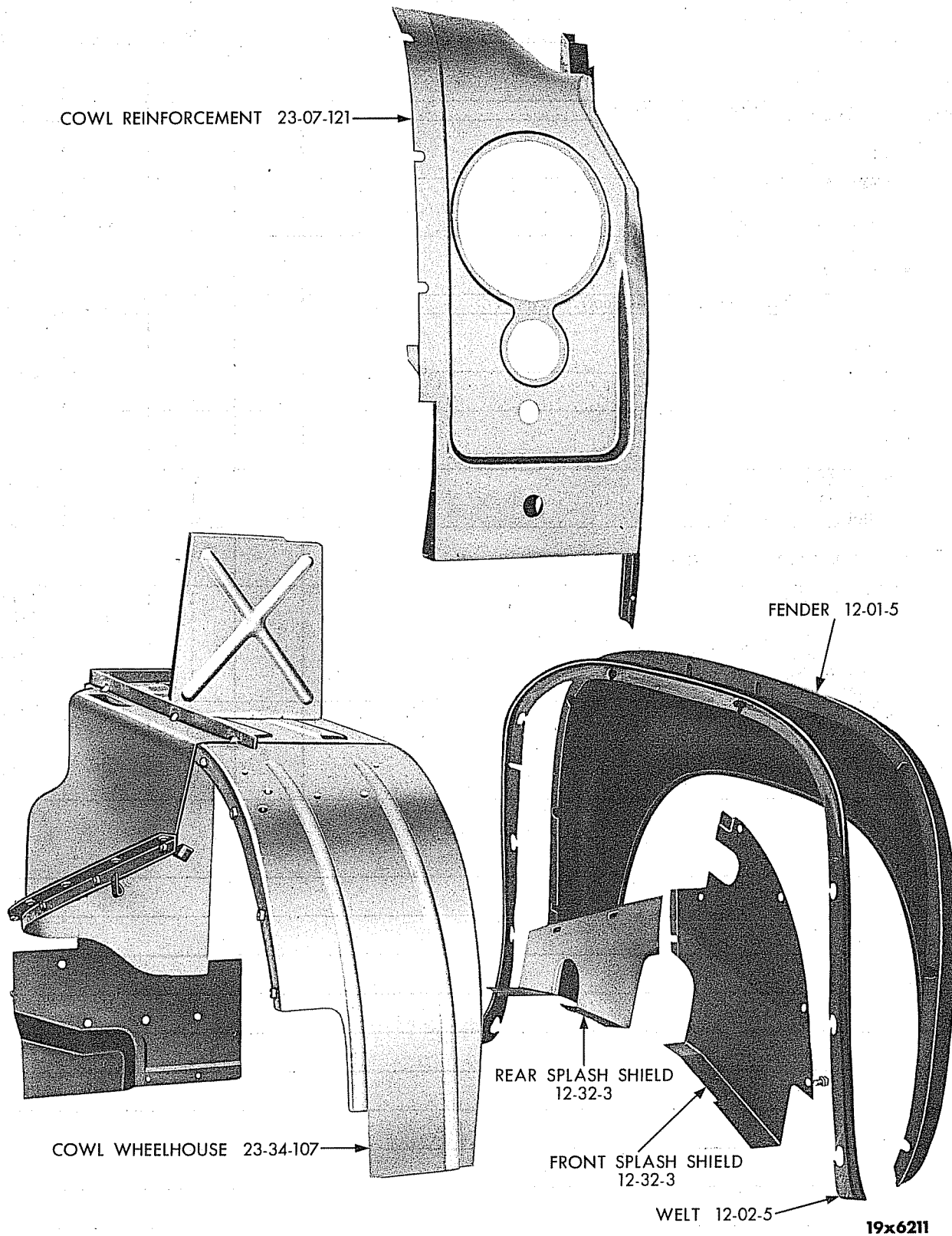

Plate 12-1

FRONT FENDER AND SHIELDS (EXPLODED VIEW)

CODE	PART NAME AND DESCRIPTION	SERIES NO.	MODEL CODES		PART NO.
			DU	EU	
FRONT FENDERS					
12-01-5	FENDER, Right	-	1	1	1199 846
	Left	-	1	1	1199 847
	Bolt, 5/16" -18 x 1" (to body).	-	24	24	122 017
FRONT FENDER WELT					
12-02-5	WELT, to Body (specify by the foot).	-	★	★	356 513
REAR FENDERS					
12-18-5	FENDER, Right	-	1	1	1199 850
	Left	-	1	1	1199 851
	Bolt, 5/16" -18 x 1" (to body)	-	20	20	122 017
REAR FENDER WELT					
12-20-4	WELT, to Body (specify by the foot).	-	★	★	356 513
REAR FENDER STONE SHIELD					
12-23-4	SHIELD, Right	-	1	1	1199 820
	Left	-	1	1	1199 821
ENGINE DUST PAN					
12-31-2	PAN, Right	-	1	1	1262 197
	Left	-	1	1	1264 633
	Bolt, 5/16" -18 x 5/8"	-	★	★	120 228
COWL WHEELHOUSE SPLASH SHIELD					
12-32-3	SHIELD, Right	-	1	1	1275 138
	Front	-	1	1	1198 755
	Rear Left	-	1	1	1199 394
	Rear Left (Special Van)	-	1	1	1275 894
12-32-5	HOUSING, Shock Absorber, Right	-	1	1	1198 810
	Bolt, 1/4" -28 x 1"	-	4	4	123 461
12-32-6	NUT, Weld	-	1	1	657 412
12-32-7	SCREW, w/WASHER	-	19	19	1093 704
	To Frame, w/WASHER	-	2	2	1093 704
12-32-8	FELT (specify by the foot)	-	★	★	313 073

NOTES

★Indicates use as required. Prices and specifications subject to change without notice.
 □Indicates parts not listed in any previous parts books.
 Series No. (1 indicates B-1 Series) (2 indicates B-2 Series) (3 indicates B-3 Series) (4 indicates B-4 Series)
 Where no Series No. is shown part is for B-1, B-2, B-3 and B-4 Series.
 March 30, 1953 Page 12-2 Printed in U.S.A.

GROUP 13 - FRAME

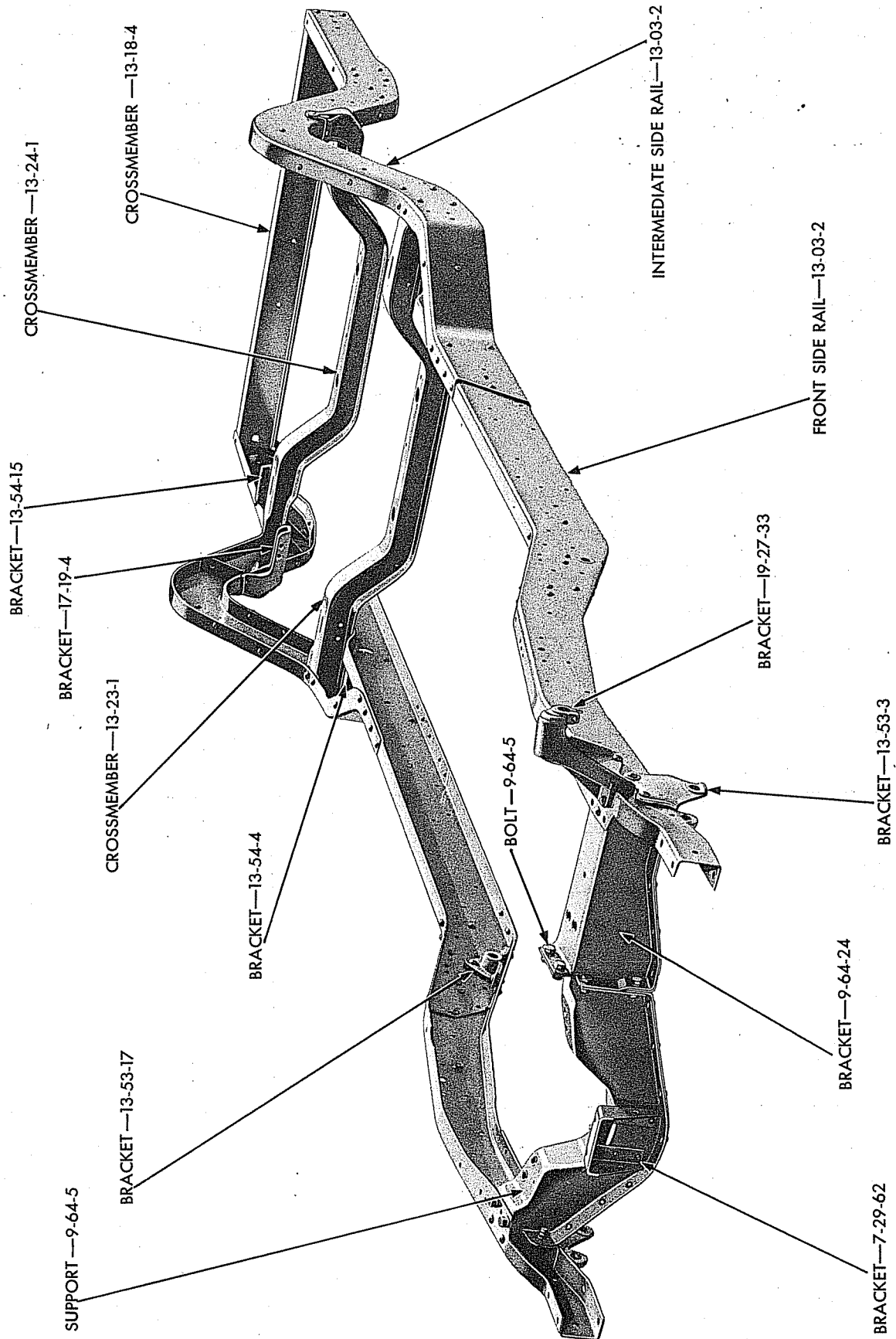

19x6248

FRAME

Plate 13-1

CODE	PART NAME AND DESCRIPTION	SERIES NO.	MODEL CODES		PART NO.
			DU	EU	
FRAME ASSEMBLY					
13-01-1	FRAME (102" W.B.)	1	1	-	1261 952
	(102" W.B.)	3,4	1	-	1270 330
	(102" W.B.)	1	-	1	1261 955
	(102" W.B.)	3	-	1	1270 332
	(117" W.B.)	1	1	-	1261 953
	(117" W.B.)	3,4	1	-	1270 331
	(117" W.B.)	1	-	1	1261 956
	(117" W.B.)	3	-	1	1270 333
	(142" W.B.)	1	-	1	1261 957
	(142" W.B.)	3,4	-	1	1270 334
FRAME SIDE RAILS					
Note: Side Rails not listed are serviced in frame assembly.					
13-03-2	RAIL, Front, Right (102" W.B.)	-	1	1	1266 772
	Left (102" W.B.)	-	1	1	1266 773
	Intermediate, Right (102" W.B.)	-	1	1	1266 782
	Left (102" W.B.)	-	1	1	1266 783
13-03-7	RAIL, Engine Front Support to Intermediate Crossmember	-	1	1	1261 811
	(for use with Fluid Drive)	-	1	1	1262 578
	Bolt, 3/8" -24 x 1"	-	2	2	120 647
	Nut	-	2	2	120 369
	Washer, lock	-	2	2	120 382
13-03-12	REINFORCEMENT, Steering Gear Bracket	-	1	1	1262 513
FRAME PROPELLER SHAFT CENTER BEARING CROSSMEMBER					
13-05-1	CROSSMEMBER (142" W.B.)	-	-	1	1261 633
FRAME INTERMEDIATE CROSSMEMBER					
13-16-2	CROSSMEMBER	1	1	1	1261 785
	Bolt, 3/8" -24 x 1"	3,4	1	1	1268 356
	Nut	-	3	3	120 647
	Washer, lock	-	3	3	120 369
		-	3	3	120 382
FRAME REAR CROSSMEMBER					
13-18-4	CROSSMEMBER (117" W.B.)	-	1	-	1261 869
	(117" W.B. and 142" W.B.)	-	-	1	1261 869
BATTERY TRAY					
13-33-61	TRAY	-	1	1	957 777
	Bolt, 5/16" -18 x 5/8"	-	3	3	120 228
BATTERY HOLD-DOWN COVER					
13-34-3	COVER	-	1	1	1189 198
	Nut	-	2	2	120 377
	Pin, cotter	-	2	2	103 373
	Washer, lock	-	2	2	120 382
	Washer, plain	-	2	2	120 394
13-34-6	BOLT	-	2	2	589 496
BODY BRACKET					
13-39-1	BRACKET, Hold-Down, Front Right	-	1	1	1262 074
	Left	-	1	1	1262 075
	Rear Intermediate	-	2	2	1262 080
	Support, Rear Right	-	1	1	1262 082
	Left	-	1	1	1262 083

★ Indicates use as required.

Prices and specifications subject to change without notice.

☐ Indicates parts not listed in any previous parts books.

Series No. (1 indicates B-1 Series) (2 indicates B-2 Series) (3 indicates B-3 Series) (4 indicates B-4 Series)

Where no Series No. is shown part is for B-1, B-2, B-3 and B-4 Series.

March 30, 1953

CODE	PART NAME AND DESCRIPTION	SERIES NO.	MODEL CODES		PART NO.
			DU	EU	
BODY BRACKET - Cont'd					
13-39-1	BRACKET, Hold-Down, Rear Right	-	1	1	1262 084
	Left	-	1	1	1262 085
	Bolt, 3/8" -16 x 3/4" (support bracket)	-	4	4	122 119
	Bolt, 3/8" -24 x 1 1/4" (hold-down bracket)	-	★	★	121 615
	Nut	-	★	★	120 369
	Washer, lock	-	★	★	120 382
	Rivet	-	4	4	104 113
	Rivet	-	★	★	108 684
13-39-53	BRACKET, Stepwell, Front Right	-	1	1	1262 076
	Left	-	1	1	1262 077
	Rear Right	-	1	1	1262 078
	Left	-	1	1	1262 079
	Bolt, 3/8" -24 x 1 1/4" (front bracket)	-	8	8	121 615
	Nut	-	8	8	120 369
	Washer, lock	-	8	8	120 382
	Rivet (142" W.B.)	-	-	8	108 684
	Rivet (102" and 117" W.B.)	-	6	6	104 113
FRAME GUSSETS					
13-46-7	GUSSET, Intermediate Crossmember, Right (use w/o Fluid Drive)	-	1	1	1273 680
	(use with Fluid Drive)	-	1	1	1273 688
	Left (use w/o Fluid Drive)	-	1	1	1273 681
	(use with Fluid Drive)	-	1	1	1273 689
	Bolt, 3/8" -24 x 1 1/4"	-	3	3	121 615
	Bolt, 3/8" -24 x 1"	-	3	3	120 647
	Nut	-	★	★	120 369
	Washer, lock	-	★	★	120 382
13-46-11	GUSSET, Propeller Shaft Center Bearing Crossmember, Front Right and Rear Left (142" W.B.)	-	-	1	548 011
	Front Left and Rear Right (142" W.B.)	-	-	1	548 010
13-46-16	GUSSET, Rear Spring Rear Bracket Crossmember, Right	-	2	2	1261 812
	Left	-	2	2	1261 813
13-46-17	GUSSET, Rear Spring Front Bracket Crossmember, Right	-	2	2	1261 813
	Left	-	2	2	1261 812
FRONT SPRING BRACKET					
13-53-3	BRACKET, Front Spring Front	-	2	2	1261 634
13-53-17	Rear	-	2	2	1261 635
13-53-22	BUSHING, Front Spring Rear Bracket	-	2	2	595 524
FRAME REAR SPRING BRACKETS					
13-54-4	BRACKET, Spring Front, Right	-	1	-	1263 404
	Left	-	1	-	1263 405
	Right	-	-	1	1263 406
	Left	-	-	1	1263 407
13-54-15	BRACKET, Spring Rear, Right	-	1	1	1261 324
	Left	-	1	1	1261 325
FRONT BUMPER					
13-64-3	BUMPER	-	1	1	1263 119
13-64-9	SPACER, to Frame	-	2	2	663 994
13-64-20	GUSSET, to Frame Upper	-	2	2	1262 209
	Lower, Right	-	1	1	1262 212
	Left	-	1	1	1262 213
	Bolt, 1/2" -20 x 1 1/4"	-	16	16	120 424
	Nut	-	16	16	120 371
	Washer, lock	-	16	16	120 384

★Indicates use as required.

□Indicates parts not listed in any previous parts books.

Series No. (1 indicates B-1 Series) (2 indicates B-2 Series) (3 indicates B-3 Series) (4 indicates B-4 Series)

Where no Series No. is shown part is for B-1, B-2, B-3 and B-4 Series.

Prices and specifications subject to change without notice.

CODE	PART NAME AND DESCRIPTION	SERIES NO.	MODEL CODES		PART NO.
			DU	EU	
REAR BUMPER					
13-66-3	BUMPER	-	1	1	1262 223
13-66-64	BRACKET, Right (102" and 117" W.B.) (16" long)	1	1	-	1262 284
	(102" and 117" W.B.) (18" long)	1	1	-	1265 968
	(102", 117" and 142" W.B.) (16" long)	1	-	1	1262 284
	(102", 117" and 142" W.B.) (18" long)	1	-	1	1265 968
	Left (102" and 117" W.B.) (16" long)	1	1	-	1262 285
	(102" and 117" W.B.) (18" long)	1	1	-	1265 969
	(102", 117" and 142" W.B.) (16" long)	1	-	1	1262 285
	Left (102", 117" and 142" W.B.) (18" long)	1	-	1	1265 969
	(102" and 117" W.B.)	3	2	-	1270 282
	(102", 117" and 142" W.B.)	3	-	2	1270 282
	Right (with rear folding doors) (Special Van)	-	1	1	1268 594
	Left (with rear folding doors) (Special Van)	-	1	1	1268 595
	Bolt, 7/16" -14 x 1 1/4" (to bar)	-	4	4	1264 442
	Nut	-	4	4	124 573
	Washer, lock	-	4	4	120 383
	Washer, plain	-	4	4	120 395
FRONT BUMPER BUFFER PLATES					
13-68-6	PLATE	-	3	3	1263 302
13-68-8	BOLT, Plate	-	3	3	1260 592
	Nut	-	3	3	124 573
	Washer, lock	-	3	3	120 384

NOTES

★ Indicates use as required. Prices and specifications subject to change without notice.
 □ Indicates parts not listed in any previous parts books.
 Series No. (1 indicates B-1 Series) (2 indicates B-2 Series) (3 indicates B-3 Series) (4 indicates B-4 Series)
 Where no Series No. is shown part is for B-1, B-2, B-3 and B-4 Series.
 March 30, 1953 Page 13-4 Printed in U.S.A.

GROUP 14 - FUEL

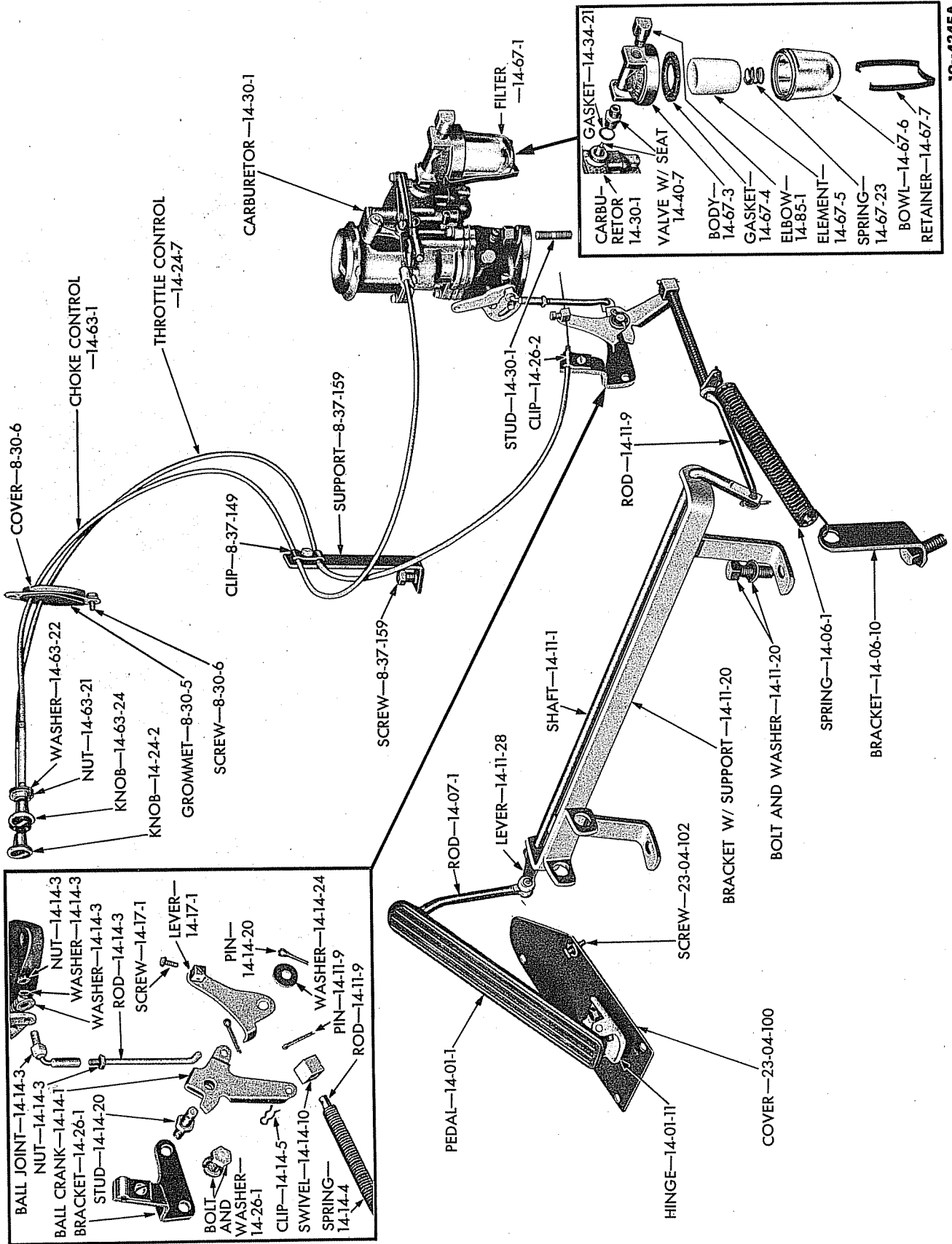

19x4345A

THROTTLE CONTROL LINKAGE

Plate 14-1

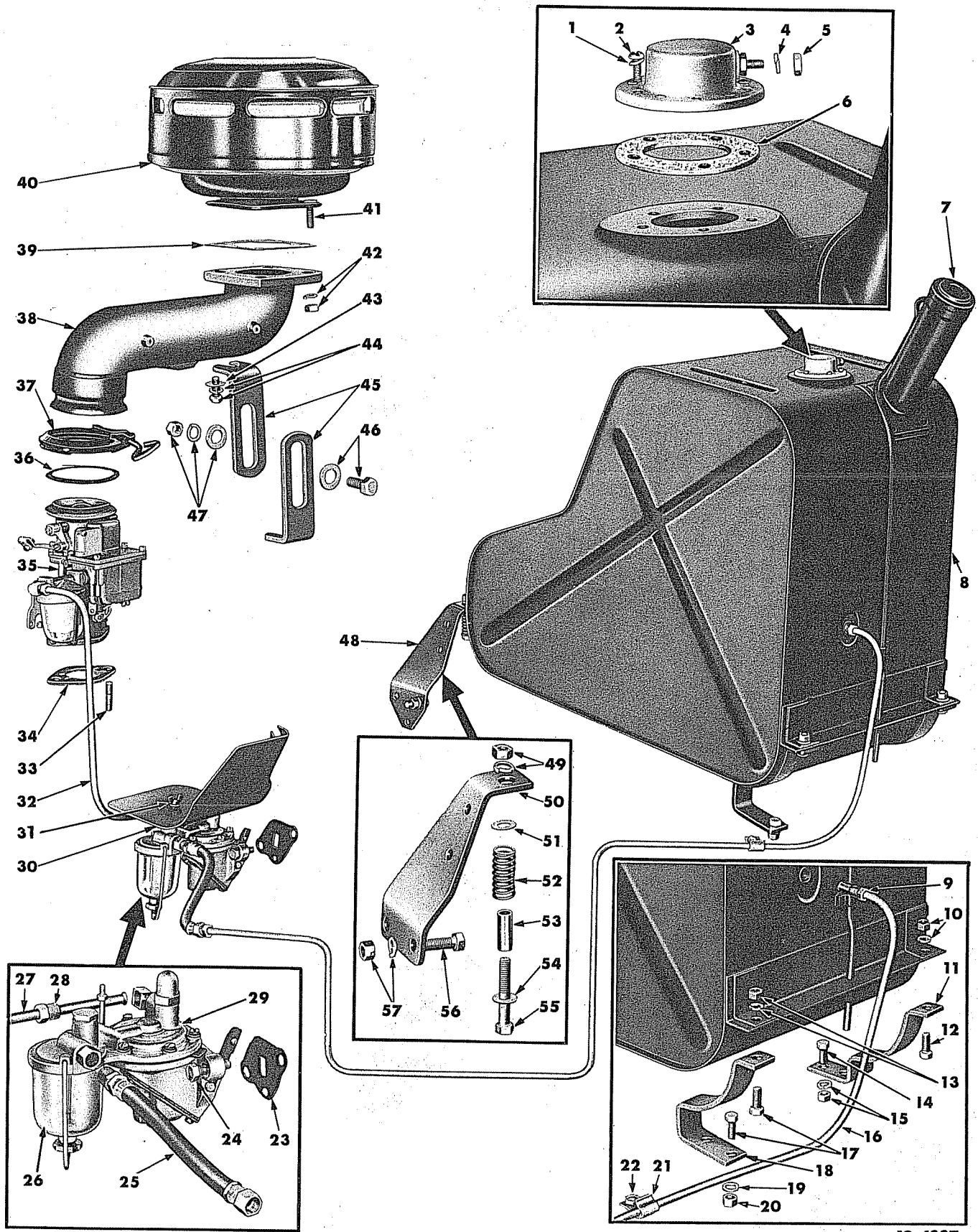

19L4337

Plate 14-2

FUEL SYSTEM

Plate 14-2

		FUEL SYSTEM		
REF. NO.	NAME	PART TYPE CODE		
1	Washer.....	14-72-1		
2	Screw.....	14-72-1		
3	Tank Unit.....	14-72-1		
4	Washer.....	14-72-1		
5	Nut.....	14-72-1		
6	Gasket.....	14-72-9		
7	Cap.....	14-86-35		
8	Tank.....	14-86-1		
9	Nut.....	14-89-1		
10	Nut and Washer.....	14-88-2		
11	Support.....	14-88-2		
12	Bolt.....	14-88-2		
13	Nut and Washer.....	14-88-2		
14	Bolt.....	14-88-2		
15	Nut and Washer.....	14-88-2		
16	Tube.....	14-89-1		
17	Bolt.....	14-88-2		
18	Support.....	14-88-2		
19	Washer.....	14-88-2		
20	Nut.....	14-88-2		
21	Clip.....	14-90-1		
22	Screw.....	14-90-1		
23	Gasket.....	14-74-1		
24	Screw.....	14-73-2		
25	Hose.....	14-89-57		
26	Bowl.....	14-80-4		
27	Tube.....	14-85-1		
28	Nut.....	14-85-1		
29	Pump.....	14-73-2		
30	Shield.....	14-81-1		
31	Nut.....	14-81-1		
32	Tube.....	14-85-1		
33	Stud.....	14-31-1		
34	Gasket.....	14-34-2		
35	Carburetor.....	14-30-1		
36	Gasket.....	14-29-5		
37	Clamp.....	14-29-25		
38	Elbow, w/Sleeve.....	14-29-20		
39	Gasket.....	14-29-5		
40	Air Cleaner.....	14-29-2		
41	Bolt.....	14-29-2		
42	Nut and Washer.....	14-29-2		
43	Washer.....	14-29-27		
44	Bolt and Washer.....	14-29-27		
45	Bracket.....	14-29-27		
46	Bolt and Washer.....	14-29-27		
47	Washers and Nut.....	14-29-27		
48	Support.....	14-88-2		
49	Nut and Washer.....	14-88-2		
50	Support.....	14-88-2		
51	Washer.....	14-88-2		
52	Spring.....	14-88-10		
53	Spacer.....	14-88-14		
54	Washer.....	14-88-2		
55	Bolt.....	14-88-2		
56	Bolt.....	14-88-2		
57	Nut and Washer.....	14-88-2		

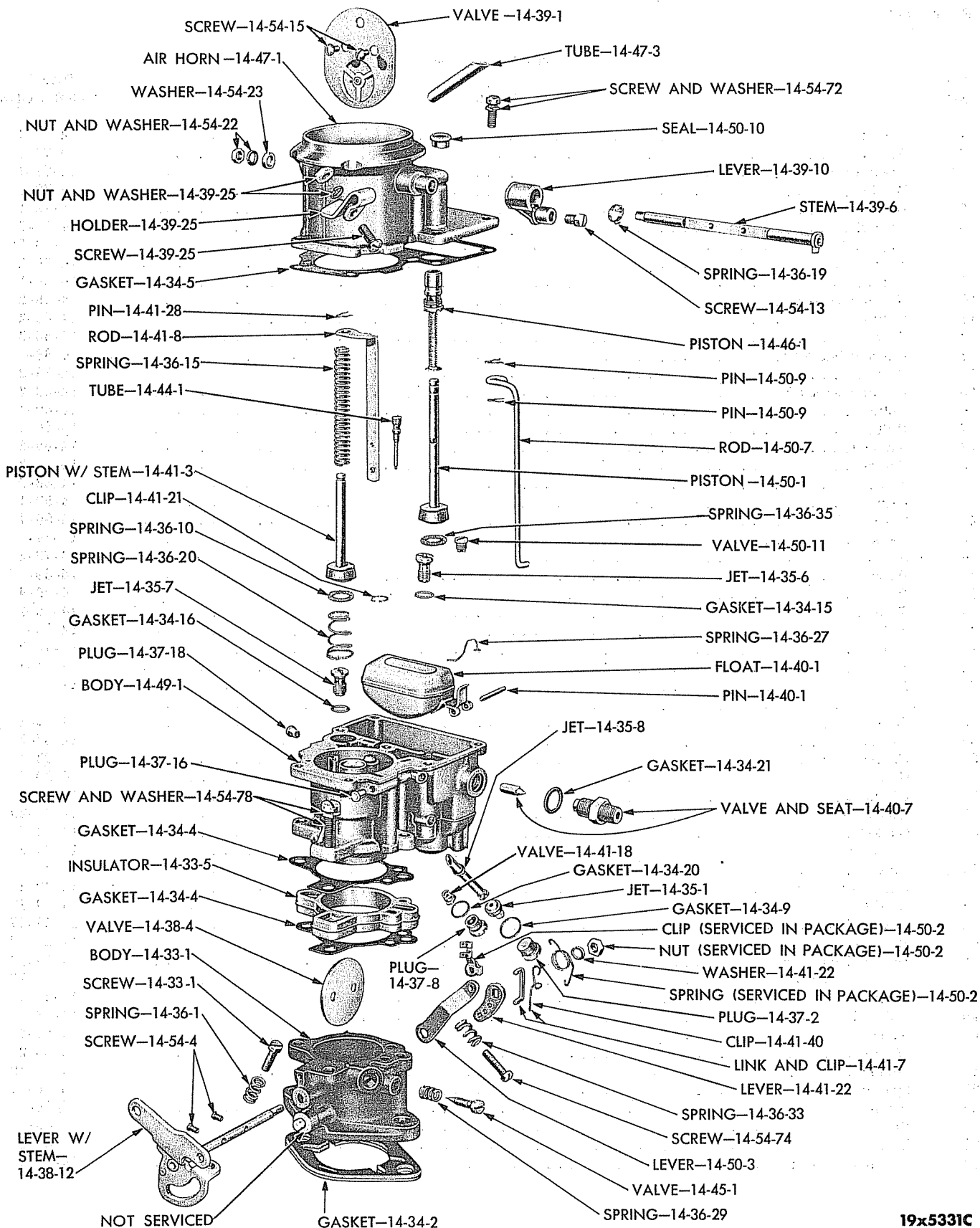

19x5331C

Plate 14-3

CARBURETOR (EXPLODED VIEW)

CODE	PART NAME AND DESCRIPTION	SERIES NO.	MODEL CODES		PART NO.
			DU	EU	
ACCELERATOR PEDAL					
14-01-1	PEDAL	-	1	1	1161 776
14-01-8	CLIP, Hinge Pin	-	1	1	1162 194
14-01-11	HINGE, Toe Board	1	1	1	1279 226
	Toe Board	3,4	1	1	1279 226
	Screw or Bolt, 1/4"-28 x 5/8"	-	2	2	151 374
	Nut	-	2	2	120 367
	Washer, lock	-	2	2	120 380
14-01-12	PIN, Hinge	1	1	1	1162 193
		3,4	1	1	1279 227
THROTTLE PEDAL RETURN SPRING					
14-06-1	SPRING, Lever	-	1	1	695 436
	SPRING	-	1	1	1088 169
14-06-10	BRACKET	-	1	1	1262 154
ACCELERATOR PEDAL ROD					
14-07-1	ROD	-	1	1	1262 151
	Pin, clevis	-	1	1	138 083
	Pin, cotter	-	1	1	112 726
	Washer, plain	-	1	1	120 392
ACCELERATOR SHAFT					
14-11-1	SHAFT	-	1	1	1262 150
14-11-9	ROD, to Throttle Control Bell Crank	-	1	1	1262 152
	Pin, cotter	-	2	2	103 373
14-11-20	BRACKET, w/SUPPORT	-	1	1	1262 145
	Bolt, 7/16"-14 x 1 1/4"	-	2	2	122 267
	Washer, lock	-	2	2	120 383
14-11-28	LEVER, to Pedal	-	1	1	642 265
	Pin, taper	-	1	1	103 563
THROTTLE CONTROL BELL CRANK					
14-14-1	BELL CRANK	-	1	1	922 418
	(w/governors)	-	1	1	1262 585
	Ball Joint, non-adjustable	-	1	1	116 425
	Nut	-	1	1	120 614
	Washer, plain	-	1	1	120 391
14-14-3	ROD, to Carburetor (w/o governors)	-	1	1	929 852
14-14-4	SPRING, Rod (to accelerator shaft)	-	1	1	920 735
14-14-5	CLIP, to Accelerator Shaft	-	1	1	695 310
14-14-10	SWIVEL	-	1	1	1261 312
14-14-11	CLIP, Swivel	-	1	1	639 174
14-14-20	STUD, Lever	-	1	1	602 071
	Washer, lock	-	1	1	120 214
14-14-24	WASHER, Lever Stud	-	1	1	391 888
THROTTLE CONTROL LEVER					
14-17-1	LEVER	-	1	1	602 068
	Screw, No. 8-32 x 5/16"	-	1	1	431 943
THROTTLE CONTROL RETURN SPRING EXTENSION					
14-23-8	EXTENSION	-	1	1	1264 351
THROTTLE CONTROL BUTTON AND WIRE					
14-24-2	KNOB	-	1	1	1191 534
14-24-7	THROTTLE CONTROL, w/WIRE and HOUSING	-	1	1	1261 045

★Indicates use as required.

Prices and specifications subject to change without notice.

☐Indicates parts not listed in any previous parts books.

Series No. (1 indicates B-1 Series) (2 indicates B-2 Series) (3 indicates B-3 Series) (4 indicates B-4 Series)

Where no Series No. is shown part is for B-1, B-2, B-3 and B-4 Series.

Printed in U.S.A.

CODE	PART NAME AND DESCRIPTION	SERIES NO.	MODEL CODES		PART NO.
			DU	EU	
THROTTLE CONTROL WIRE TUBE BRACKET					
14-26-1	BRACKET	-	1	1	602 069
	Bolt, 5/16" -18 x 3/4"	-	1	1	122 007
	Washer, lock	-	1	1	120 214
14-26-2	CLIP	-	1	1	389 413
	Throttle and Choke Control	-	1	1	1261 735
	Bolt, 1/4"-28 x 1"	-	1	1	123 461
	Screw, No. 10-24 x 1/2"	-	1	1	120 221
	Nut	-	1	1	120 361
	Washer, lock	-	1	1	138 479
CARBURETOR AIR CLEANER					
14-29-2	AIR CLEANER	-	1	1	1265 352
	Bolt, 5/16"-24 x 3/4"	-	4	4	120 741
	Nut	-	4	4	120 368
	Washer, lock	-	4	4	120 214
14-29-5	GASKET	-	1	1	925 232
	Sleeve to Carburetor	-	1	1	952 062
14-29-20	ELBOW, w/SLEEVE	-	1	1	1262 425
14-29-25	CLAMP, Elbow Sleeve	-	1	1	1262 429
14-29-27	BRACKET, Elbow	-	2	2	1262 428
	Bolt, 3/8"-16 x 1" (upper)	-	1	1	120 233
	Bolt, 3/8"-24 x 3/4" (lower)	-	1	1	123 520
	Bolt, 3/8"-24 x 1 1/4"	-	1	1	121 615
	Nut	-	1	1	120 369
	Washer, lock	-	3	3	120 382
	Washer, plain	-	4	4	120 394
CARBURETOR					
14-30-1	CARBURETOR (B-1-DU after engine No. T164-3667, B-1-EU after engine No. T165-2119) (w/o Fluid Drive)	-	1	1	1317 261
	(B-1-DU up to engine No. T164-3810, B-1-EU up to engine No. T165-2199) (w/Fluid Drive) (1142 988 carburetor cancelled - service detail parts-use 1317 260 carburetor)	-	1	1	---- --
	(B-1-DU after engine No. T164-3810, B-1-EU after engine No. T165-2199) (w/Fluid Drive)	-	1	1	1317 260
	Stud	-	2	2	113 247
	Nut	-	2	2	120 369
14-30-5	CARBURETOR PACKAGE (B-1-DU up to engine No. T164-3667, B-1-EU up to engine No. T165-2119) (w/o Fluid Drive)	-	1	1	1241 507
	Stud	-	2	2	113 247
	Nut	-	2	2	120 369

★Indicates use as required.

☐Indicates parts not listed in any previous parts books.

Series No. (1 indicates B-1 Series) (2 indicates B-2 Series) (3 indicates B-3 Series) (4 indicates B-4 Series)

Where no Series No. is shown part is for B-1, B-2, B-3 and B-4 Series.

Prices and specifications subject to change without notice.

Printed in U.S.A.

CODE	CARBURETOR	1317 261	1142 988	1317 260	1241 507
------	----------------------	----------	----------	----------	----------

Note: All quantities are one (1) unless otherwise indicated in parenthesis.

CARBURETOR BODY FLANGE OR THROTTLE BODY

14-33-1	BODY	1318 523	1314 519	1318 524	920 754
14-33-5	INSULATOR	1318 521	1138 696	1318 521	698 853

CARBURETOR GASKETS

14-34-2	GASKET, Flange	637 191	637 191	637 191	637 191
14-34-4	GASKET, Main Body	1318 520	698 857	1318 520	698 857
14-34-5	GASKET, Air Horn	861 128	861 128	861 128	861 128
14-34-9	GASKET, Main Metering Jet Plug	959 238	959 238	959 238	959 238
14-34-15	GASKET, Power By-Pass Jet	662 431	662 431	662 431	662 431
14-34-16	GASKET, Pump By-Pass Jet	662 431	662 431	662 431	662 431
14-34-20	GASKET, Check Valve Jet Plug	959 239	959 239	959 239	959 239
14-34-21	GASKET, Float Needle Valve Seat	647 093	647 093	647 093	647 093

CARBURETOR JETS

14-35-1	JET, Main Metering	957 321	957 321	957 321	957 321
14-35-6	JET, Power By-Pass	1323 833	1323 833	1323 833	691 200
14-35-7	JET, Pump By-Pass	698 872	698 872	698 872	698 872
14-35-8	JET, Main Discharge	957 323	957 323	957 323	957 323

CARBURETOR SPRINGS

14-36-1	SPRING, Idle Adjusting Screw	647 120	647 120	647 120	647 120
14-36-10	SPRING, Pump Piston Expansion	647 123	647 123	647 123	647 123
14-36-15	SPRING, Pump Stem	1317 513	698 884	1317 513	698 884
14-36-19	SPRING, Manual Choke Lever	698 879	698 879	698 879	698 879
14-36-27	SPRING, Float Fulcrum Pin	698 850	698 850	698 850	698 850
14-36-29	SPRING, Idle Needle Valve	647 070	647 070	647 070	647 070
14-36-33	SPRING, Dash Pot Control Lever Adjusting Screw	----	647 120	647 120	----
14-36-35	SPRING, Dash Pot Piston Expansion	----	647 123	647 123	----

CARBURETOR PLUGS AND LEAD BALLS

14-37-2	PLUG, Main Discharge Jet	698 855	698 855	698 855	698 855
14-37-9	PLUG, Pump Check Valve Channel	869 668	869 668	869 668	869 668
14-37-15	PLUG, Idle Discharge Hole	650 043	650 043	650 043	650 043
14-37-18	PLUG, Vacuum Spark Hole	650 043	650 043	650 043	650 043
14-37-26	BALL, Air Horn Lead	650 038	650 038	650 038	650 038
14-37-27	BALL, Main Body Lead	650 038	650 038	650 038	650 038

CARBURETOR THROTTLE VALVE AND PARTS

14-38-4	VALVE	698 869	698 869	698 869	698 869
14-38-12	LEVER, w/STEM	1138 695	1138 695	1138 695	1138 695
	Screw, No. 10-24 x 3/4" (idle adjusting)	132 051	132 051	132 051	132 051

CARBURETOR CHOKE

14-39-1	VALVE	698 864	698 864	698 864	698 864
14-39-6	LEVER, Contact, w/STEM	957 333	957 333	957 333	957 333
14-39-10	LEVER, Manual Choke	698 880	698 880	698 880	698 880

★ Indicates use as required.

☐ Indicates parts not listed in any previous parts books.

Series No. (1 indicates B-1 Series) (2 indicates B-2 Series) (3 indicates B-3 Series) (4 indicates B-4 Series)

Where no Series No. is shown part is for B-1, B-2, B-3 and B-4 Series.

Prices and specifications subject to change without notice.

CODE	CARBURETOR - Cont'd	1317 261	1142 988	1317 260	1241 507
------	---------------------	----------	----------	----------	----------

Note: All quantities are one (1) unless otherwise indicated in parenthesis.

CARBURETOR CHOKE - Cont'd

14-39-25	HOLDER, Choke Tube	698 882	698 882	698 882	698 882
	Screw, No. 10-24 x 3/4"	132 105	132 105	132 105	132 105
	Nut	120 614	120 614	120 614	120 614
	Washer, lock	120 217	120 217	120 217	120 217

CARBURETOR FLOAT AND PARTS

14-40-1	FLOAT, w/LEVER	869 685	869 685	869 685	869 685
	Pin, stght.	103 694	103 694	103 694	103 694
14-40-7	VALVE, Needle, w/Needle SEAT	957 325	957 325	957 325	957 325

CARBURETOR PUMP

14-41-3	PISTON, w/STEM	1312 284	1312 284	1312 284	1312 284
14-41-7	LINK, w/CLIP	1121 121	1121 121	1121 121	1121 121
14-41-8	ROD	861 131	861 131	861 131	861 131
14-41-18	VALVE, Check	645 635	645 635	645 635	645 635
14-41-20	SCREEN, Strainer	698 847	698 847	698 847	698 847
14-41-21	CLIP, Strainer Screen Spring	698 848	698 848	698 848	698 848
14-41-22	LEVER	698 841	698 841	698 841	698 841
	Nut	120 614	120 614	120 614	120 614
	Washer, lock	120 217	120 217	120 217	120 217
14-41-28	PIN, Stem Cotter	653 414	653 414	653 414	653 414
14-41-40	CLIP, Link Spring	1121 122	1121 122	1121 122	1121 122

CARBURETOR TUBES

14-44-1	TUBE, Idle, w/HOLDER	698 842	698 842	698 842	698 842
---------	----------------------	---------	---------	---------	---------

CARBURETOR IDLING PARTS

14-45-1	VALVE, Needle	676 115	676 115	676 115	676 115
---------	---------------	---------	---------	---------	---------

CARBURETOR VACUUM ECONOMIZER

14-46-1	PISTON, Power	698 891	698 891	698 891	698 891
---------	---------------	---------	---------	---------	---------

CARBURETOR AIR HORN

14-47-1	AIR HORN	-----	1314 518	1314 518	957 334
	Screw, No. 10-24 x 7/8"	132 056	132 056	132 056	132 056
	Washer, lock	120 217	120 217	120 217	120 217
14-47-3	TUBE, Vent	698 863	698 863	698 863	698 863

CARBURETOR MAIN BODY

14-49-1	BODY	1318 522	1141 770	1318 522	957 326
---------	------	----------	----------	----------	---------

★Indicates use as required.

Prices and specifications subject to change without notice.

ⓁIndicates parts not listed in any previous parts books.

Series No. (1 indicates B-1 Series) (2 indicates B-2 Series) (3 indicates B-3 Series) (4 indicates B-4 Series)

Where no Series No. is shown part is for B-1, B-2, B-3 and B-4 Series.

Printed in U.S.A.

March 30, 1953

Page 14-8

CODE	CARBURETOR - Cont'd	1317 261	1142 988	1317 260	1241 507
------	-------------------------------	----------	----------	----------	----------

Note: All quantities are one (1) unless otherwise indicated in parenthesis.

CARBURETOR DASH POT

14-50-1	PISTON, w/STEM	----	869 688	869 688	----
14-50-2	CLIP and SPRING and NUT PACKAGE	----	1141 759	1141 759	----
14-50-3	LEVER, Control	----	869 693	869 693	----
14-50-7	ROD	----	953 825	953 825	----
14-50-9	PIN, Rod Stem Cotter	----	653 414	653 414	----
14-50-10	SEAL	----	1138 694	1138 694	----
14-50-11	VALVE, Check	----	645 635	645 635	----

CARBURETOR SCREWS AND NUTS AND WASHERS

14-54-4	SCREW, Throttle Valve Attaching (2)	1141 767	1141 767	1141 767	1141 767
14-54-13	SCREW, Manual Choke Lever Wire Clamp	677 655	677 655	677 655	677 655
14-54-15	SCREW, Choke Valve Attaching (2)	698 845	698 845	698 845	698 845
14-54-22	NUT, Choke Stem Spacer Washer Attaching	698 837	698 837	698 837	698 837
	Washer, lock	120 217	120 217	120 217	120 217
14-54-23	WASHER, Choke Stem Spacer	862 134	862 134	862 134	862 134
14-54-28	SCREW, Choke Tube Holder, w/WASHER	1314 520	----	1314 520	----
14-54-72	SCREW, Air Horn Attaching, w/WASHER (5)	1138 698	1138 698	1138 698	1138 698
14-54-74	SCREW, Dash Pot Control Lever Adjusting	----	1116 311	1116 311	----
14-54-78	SCREW, Main Body Attaching, w/WASHER (2)	----	1138 699	1138 699	----

★ Indicates use as required.

☐ Indicates parts not listed in any previous parts books.

Series No. (1 indicates B-1 Series) (2 indicates B-2 Series) (3 indicates B-3 Series) (4 indicates B-4 Series)

Where no Series No. is shown part is for B-1, B-2, B-3 and B-4 Series.

Prices and specifications subject to change without notice.

CODE	PART NAME AND DESCRIPTION	SERIES NO.	MODEL CODES		PART NO.
			DU	EU	
CHOKE CONTROL					
14-63-1	CHOKE	-	1	1	1261 045
14-63-21	NUT, Mounting	-	1	1	1189 496
14-63-22	WASHER, Mounting Nut	-	1	1	1194 598
14-63-24	KNOB	-	1	1	1191 537
FUEL FILTER					
14-67-1	FILTER, Complete (w/inlet 1/2" x 20 Tap and Outlet 1/8" pipe tap thread)	-	1	1	⊠1402 141
	(w/inlet and outlet 1/8" pipe tap thread)	-	1	1	⊠1402 139
14-67-4	GASKET, Bowl	-	1	1	1320 527
14-67-5	FILTER or ELEMENT	-	1	1	1138 687
14-67-6	BOWL	-	1	1	⊠1402 615
14-67-7	BAIL or RETAINER	-	1	1	⊠1402 617
14-67-23	SPRING	-	1	1	1142 993
VARIABLE SPEED GOVERNOR					
Note: To insure against delay in shipment of governors, do not send orders to Chrysler Corporation. Enter orders for governors direct with the following: King-Seeley Corp. 316 S. 1st. St., Ann Arbor, Mich.					
14-68-3	GASKET (to manifold) (to carburetor)	-	★	★	637 191
14-68-20	SEAL, w/WIRE	-	1	1	1067 209
FUEL GAUGE TANK UNIT					
14-72-1	GAUGE	-	1	1	1261 467
	Screw, No. 8-32 x 5/8" (mounting)	-	5	5	132 764
	Nut (terminal)	-	1	1	120 622
	Washer, lock (terminal)	-	1	1	138 479
14-72-9	GASKET	-	1	1	55 985
14-72-11	WASHER, Mounting Screw	-	5	5	312 941
FUEL PUMP					
14-73-2	PUMP (B-1-DU up to engine No. T164-4125, B-1-EU up to engine No. T165-2447)	-	1	1	1318 995
	(B-1-DU after engine No. T164-4125, B-1-EU after engine No. T165-2447)	-	1	1	⊠1407 909

★Indicates use as required.

Prices and specifications subject to change without notice.

⊠Indicates parts not listed in any previous parts books.

Series No. (1 indicates B-1 Series) (2 indicates B-2 Series) (3 indicates B-3 Series) (4 indicates B-4 Series)

Where no Series No. is shown part is for B-1, B-2, B-3 and B-4 Series.

Printed in U.S.A.

CODE	FUEL PUMP - Cont'd	1318 995	1407 909
------	------------------------------	----------	----------

Note: All quantities are one (1) unless otherwise indicated in parenthesis.

14-73-5	DIAPHRAGM REPAIR KIT	1321 275	1326 102
14-73-7	ARM REPAIR KIT, Rocker	1321 279	1326 103

FUEL PUMP MOUNTING

14-74-1	GASKET	1117 482	1117 482
---------	------------------	----------	----------

FUEL PUMP COVER

14-76-1	COVER, Assembly	639 091	----
	Screw, No. 10 -32 x 5/8" (★)	132 121	----
	Washer, lock (★)	120 217	----
14-76-4	AIR DOME	1322 732	----
14-76-5	COVER, Bottom	639 147	----
	Screw, No. 10 -32 x 3/8"	132 105	----
14-76-6	GASKET, Bottom Cover	639 148	----

FUEL PUMP DIAPHRAGM

14-77-5	SPRING	959 240	----
14-77-10	CAP, Spring	639 138	----
14-77-15	PROTECTOR, Upper	699 771	----
	PROTECTOR, Lower	639 113	----
14-77-16	WASHER, Alignment	639 115	----
14-77-20	GASKET, Pull Rod	639 123	----

FUEL PUMP VALVE

14-78-4	PLUG	639 097	----
14-78-5	GASKET, Plug and Air Dome (2)	639 099	----

FUEL PUMP ROCKER ARM

14-79-4	SPRING	639 116	----
14-79-5	CAP, Spring	639 138	----
14-79-7	LINK (2)	639 142	----
14-79-8	PIN, Link (2)	639 145	----
14-79-11	CLIP, Link Pin (4)	639 146	----

FUEL PUMP STRAINER

14-80-1	BOWL and GASKET PACKAGE	1321 282	1321 282
14-80-2	SCREEN	639 104	639 104
14-80-4	BOWL (glass)	639 106	----
14-80-5	GASKET, Bowl (cork)	1322 695	----
14-80-6	BAIL and SCREW	639 108	1321 681
14-80-7	NUT, Bail Screw	639 109	----
14-80-8	SEAT, Bowl	639 107	----

FUEL PUMP HEAT SHIELD

14-81-1	SHIELD (LHD.)	1316 587	----
	Nut	110 330	110 330
	Washer, lock	120 217	120 217
14-81-2	STUD	608 138	608 138
	Washer, lock	120 217	120 217

★Indicates use as required.

⊠Indicates parts not listed in any previous parts books.

Series No. (1 indicates B-1 Series) (2 indicates B-2 Series) (3 indicates B-3 Series) (4 indicates B-4 Series)

Where no Series No. is shown part is for B-1, B-2, B-3 and B-4 Series.

CODE	PART NAME AND DESCRIPTION	SERIES NO.	MODEL CODES		PART NO.
			DU	EU	
FUEL PUMP TUBE AND HOSE					
14-85-1	TUBE (to carburetor) (w/governors)	-	1	1	861 827
	(to carburetor) (w/filter) (B-1-DU up to engine No. T164-3846, B-1-EU up to engine No. T165-2240)	-	1	1	861 830
	(to carburetor) (w/filter) (B-1-DU after engine No. T164-3846, B-1-EU after engine No. T165-2240)	-	1	1	861 827
	Elbow	-	★	★	137 422
	Nut	-	2	2	137 398
FUEL TANK					
14-86-1	TANK	-	1	1	1270 502
	Plug, pipe (drain)	-	1	1	143 932
14-86-14	BUSHING, Drain Plug	-	1	1	428 891
14-86-16	SHUT-OFF COCK, Fuel Tube	-	1	1	1270 654
14-86-35	CAP, Filler (B-1-DU up to serial No. 84204065, B-1-EU up to serial No. 84000755)	-	1	1	1262 418
14-86-35	CAP, Filler (B-1-DU after serial No. 84204065, B-1-EU after serial No. 84000755) (painted black)	-	1	1	547 645
	(painted red)	-	1	1	1267 613
14-86-36	GASKET, Filler Cap	-	1	1	556 514
FUEL TANK SUPPORT					
14-88-2	SUPPORT, Front Right (B-1-DU up to serial No. 84205863, B-1-EU up to serial No. 84001284)	-	1	1	1262 262
	(B-1-DU after serial No. 84205863, B-1-EU after serial No. 84001284)	-	1	1	1273 064
	Left (B-1-DU up to serial No. 84205863, B-1-EU up to serial No. 84001284)	-	1	1	1262 263
	(B-1-DU after serial No. 84205863, B-1-EU after serial No. 84001284)	-	1	1	1273 065
	Intermediate (spring mounted)	-	2	2	1273 918
	Rear, Right	-	1	1	1262 266
	Left	-	1	1	1262 267
	Bolt, 3/8"-24 x 2 1/2"	-	★	★	120 640
	Bolt, 3/8"-24 x 1"	-	★	★	120 647
	Nut	-	★	★	120 369
	Washer, lock	-	★	★	120 382
	Washer, plain	-	★	★	120 394
14-88-10	SPRING, Bolt	-	★	★	590 032
14-88-14	SPACER, Bolt	-	★	★	590 034
14-88-33	LINING, Front (4 1/2" long)	-	★	★	48 004
	Intermediate (12 3/4" long)	-	★	★	48 004
FUEL TANK TUBING					
14-89-15	TUBE (to fuel pump) (w/o intermediate support)	-	1	1	861 842
	(to fuel pump) (w/intermediate support)	-	1	1	861 840
14-89-57	HOSE (to fuel pump)	-	1	1	1188 258
FUEL TUBE OR LINE CLIPS					
14-90-1	CLIP	-	2	2	1263 079
	Bolt, 5/16" -18 x 5/8"	-	2	2	120 228

NOTES

★ Indicates use as required.

Prices and specifications subject to change without notice.

☐ Indicates parts not listed in any previous parts books.

Series No. (1 indicates B-1 Series) (2 indicates B-2 Series) (3 indicates B-3 Series) (4 indicates B-4 Series)

Where no Series No. is shown part is for B-1, B-2, B-3 and B-4 Series.

Printed in U.S.A.

GROUP 16 - PROPELLER SHAFT AND UNIVERSAL JOINT

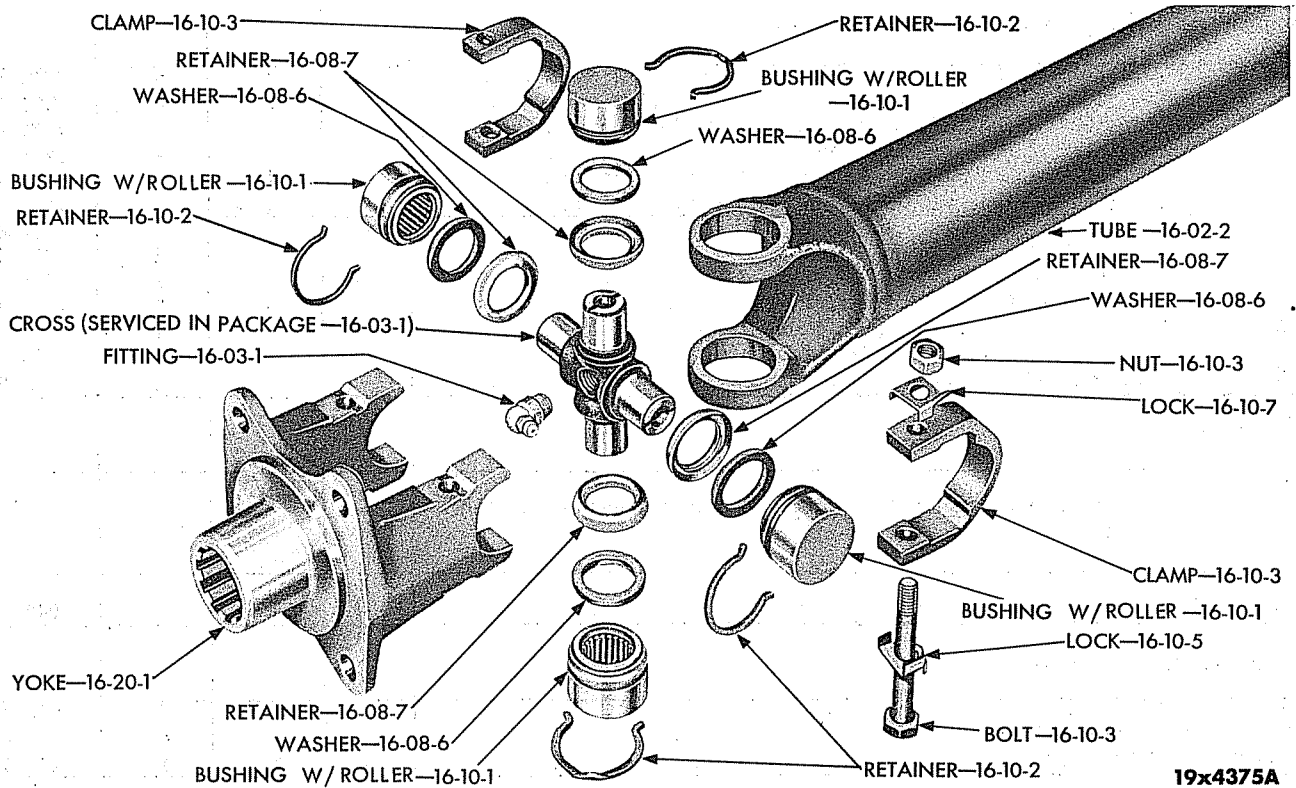

19x4375A

Plate 16-1

UNIVERSAL JOINT (EXPLODED VIEW)

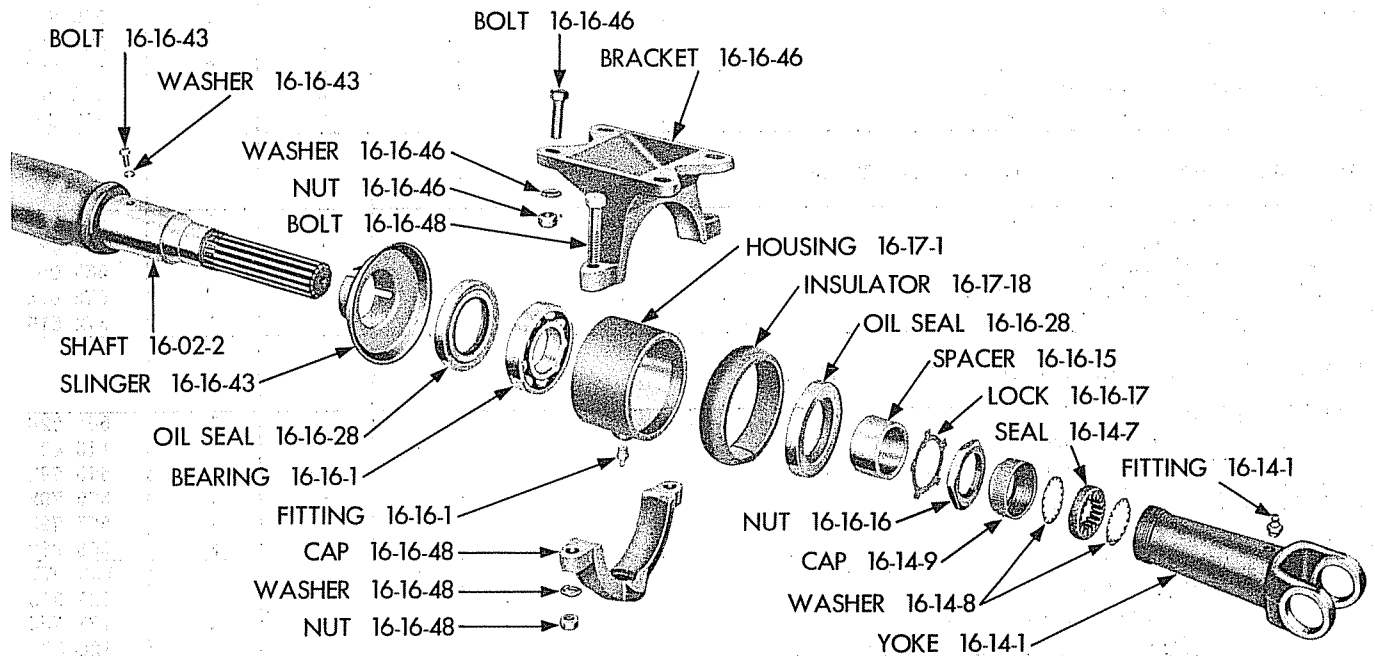

19x6243

Plate 16-2

CENTER BEARING (EXPLODED VIEW)

CODE	PART NAME AND DESCRIPTION	SERIES NO.	MODEL CODES		PART NO.
			DU	EU	
PROPELLER SHAFT - LESS UNIVERSAL JOINT					
16-02-1	TUBE (102" W.B.) (w/o Fluid Drive)	-	1	-	1261 805
	(102" W.B.) (w/3 Speed Trans. and Fluid Drive)	-	1	-	1262 483
	(102" W.B.) (w/4 Speed Trans. and Fluid Drive)	-	1	-	1262 491
	(117" W.B.) (w/o Fluid Drive)	-	1	-	1261 806
	(117" W.B.) (w/3 Speed Trans. and Fluid Drive)	-	1	-	1262 484
	(117" W.B.) (w/4 Speed Trans. and Fluid Drive)	-	1	-	1262 492
	(102" W.B.) (w/o Fluid Drive)	-	-	1	1261 807
	(102" W.B.) (w/Fluid Drive)	-	-	1	1262 491
	(117" W.B.) (w/o Fluid Drive)	-	-	1	1261 808
	(117" W.B.) (w/Fluid Drive)	-	-	1	1262 492
16-02-2	TUBE, Front (142" W.B.) (w/o Fluid Drive)	-	-	1	1261 798
	Front (142" W.B.) (w/Fluid Drive)	-	-	1	1262 488
16-02-4	TUBE, Rear (142" W.B.)	-	-	1	1261 800
UNIVERSAL JOINT					
Note: Quantities are for one Universal Joint-not quantities used per truck.					
16-03-1	UNIVERSAL JOINT PACKAGE	-	1	1	947 556
UNIVERSAL JOINT CROSS					
16-08-6	WASHER	-	4	4	575 785
16-08-7	RETAINER, Washer	-	4	4	599 252
16-08-19	FITTING, Lubricant	-	1	1	145 435
UNIVERSAL JOINT CROSS-ROLLER AND BUSHING					
16-10-1	BUSHING, w/ROLLERS	-	4	4	575 787
16-10-2	RETAINER	-	4	4	575 790
16-10-3	CLAMP	-	2	2	575 723
	Bolt, 5/16"-24 x 3"	-	2	2	120 038
	Nut	-	2	2	120 368
16-10-5	LOCK, Clamp Bolt	-	2	2	572 604
16-10-7	LOCK, Clamp Bolt Nut	-	2	2	572 603
PROPELLER SHAFT SPLINED OR SLIDING YOKE					
16-14-1	YOKE	-	1	1	925 035
	Fitting, lubricant	-	1	1	145 433
16-14-7	OIL SEAL, Spline	-	1	1	563 099
16-14-8	WASHER, Spline Oil Seal	-	2	2	572 485
16-14-9	CAP, Spline Oil Seal	-	1	1	572 515
PROPELLER SHAFT CENTER BEARING (142" W.B.)					
16-16-1	BEARING	-	-	1	564 728
	Fitting, lubricant	-	-	1	145 433
16-16-15	SPACER, Retainer	-	-	1	575 791
16-16-16	NUT, Retainer	-	-	1	575 792
16-16-17	LOCK, Retainer Nut	-	-	1	575 793
16-16-28	OIL SEAL	-	-	2	556 939
16-16-43	MUD SLINGER	-	-	1	509 977
	Bolt, 1/4"-28 x 1/2"	-	-	1	123 316
	Washer, lock	-	-	1	121 753
	Washer, plain	-	-	1	120 392
16-16-46	BRACKET, Housing	-	-	1	562 120
	Bolt, 7/16"-20 x 1 1/2"	-	-	4	123 852
	Nut	-	-	4	120 370
	Washer, lock	-	-	4	120 383

★ Indicates use as required.

Prices and specifications subject to change without notice.

☐ Indicates parts not listed in any previous parts books.

Series No. (1 indicates B-1 Series) (2 indicates B-2 Series) (3 indicates B-3 Series) (4 indicates B-4 Series)

Where no Series No. is shown part is for B-1, B-2, B-3 and B-4 Series.

March 30, 1953

CODE	PART NAME AND DESCRIPTION	SERIES NO.	MODEL CODES		PART NO.
			DU	EU	
PROPELLER SHAFT CENTER BEARING (142" W.B.) - Cont'd					
	Washer, plain	-	-	4	120 395
16-16-48	CAP, Housing Bracket	-	-	1	562 117
	Bolt, 7/16"-20 x 2"	-	-	2	124 133
	Nut	-	-	2	120 370
	Washer, lock	-	-	2	120 383
PROPELLER SHAFT CENTER BEARING HOUSING					
16-17-1	HOUSING	-	-	1	564 721
16-17-18	INSULATOR	-	-	1	562 119
PROPELLER SHAFT YOKE OR FLANGE					
16-20-1	YOKE, Rear Axle Drive Pinion	-	1	1	1195 494
	Trans. Shaft (3 Speed Trans.)	-	1	-	1195 463
	(4 Speed Trans.)	-	1	1	598 930
16-20-2	WASHER, Rear Axle Drive Pinion Yoke Nut	-	1	-	308 466
	Trans. Shaft Yoke Nut (3 Speed Trans.)	-	1	-	308 466
	(4 Speed Trans.)	-	1	1	578 994
16-20-3	NUT, Rear Axle Drive Pinion Yoke	-	1	-	855 094
		-	-	1	926 228
	Trans. Shaft Yoke (3 Speed Trans.)	-	1	-	600 366
	(4 Speed Trans.)	-	1	1	562 536
	Pin, cotter	-	2	2	119 209

NOTES

★ Indicates use as required. Prices and specifications subject to change without notice.
 □ Indicates parts not listed in any previous parts books.
 Series No. (1 indicates B-1 Series) (2 indicates B-2 Series) (3 indicates B-3 Series) (4 indicates B-4 Series)
 Where no Series No. is shown part is for B-1, B-2, B-3 and B-4 Series.
 Page 16-3
 Printed in U.S.A.
 March 30, 1953

CODE	PART NAME AND DESCRIPTION	SERIES NO.	MODEL CODES		PART NO.
			DU	EU	

NOTES

★ Indicates use as required.

⊠ Indicates parts not listed in any previous parts books.

Series No. (1 indicates B-1 Series) (2 indicates B-2 Series) (3 indicates B-3 Series) (4 indicates B-4 Series)

Where no Series No. is shown part is for B-1, B-2, B-3 and B-4 Series.

March 30, 1953

Prices and specifications subject to change without notice.

Printed in U.S.A.

GROUP 17 - SPRINGS

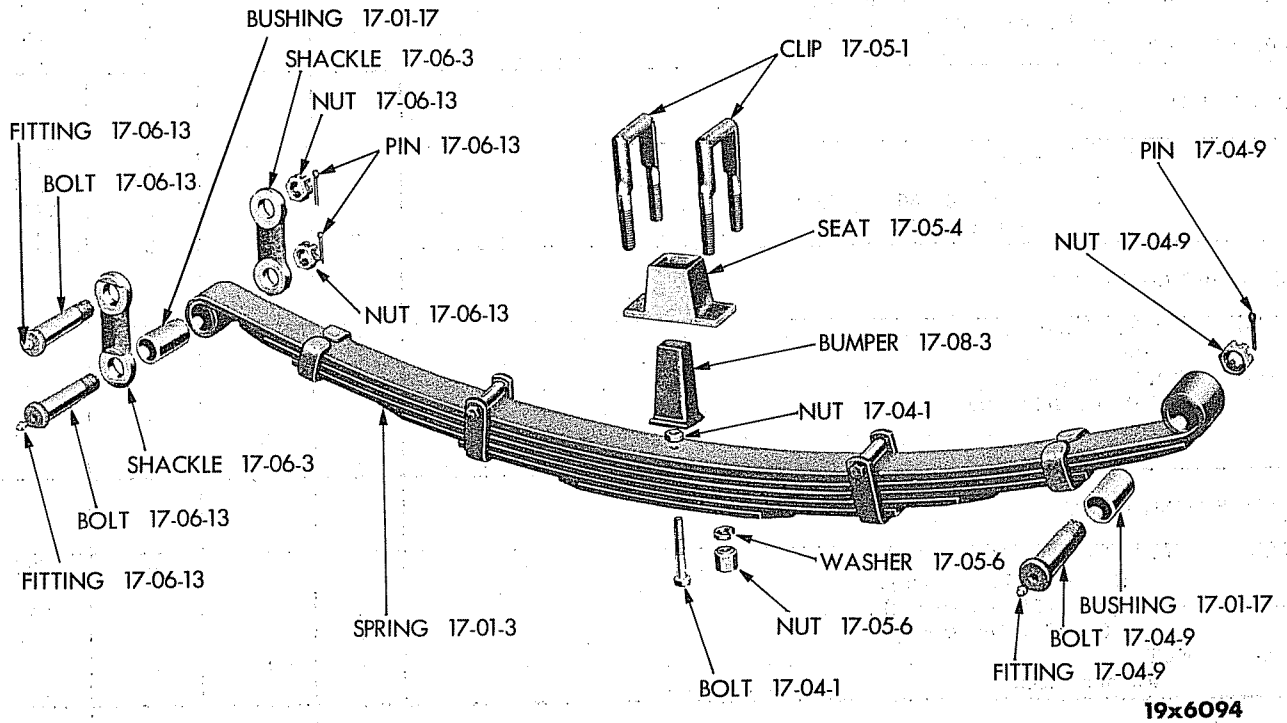

19x6094

Plate 17-1

FRONT SPRING (EXPLODED VIEW)

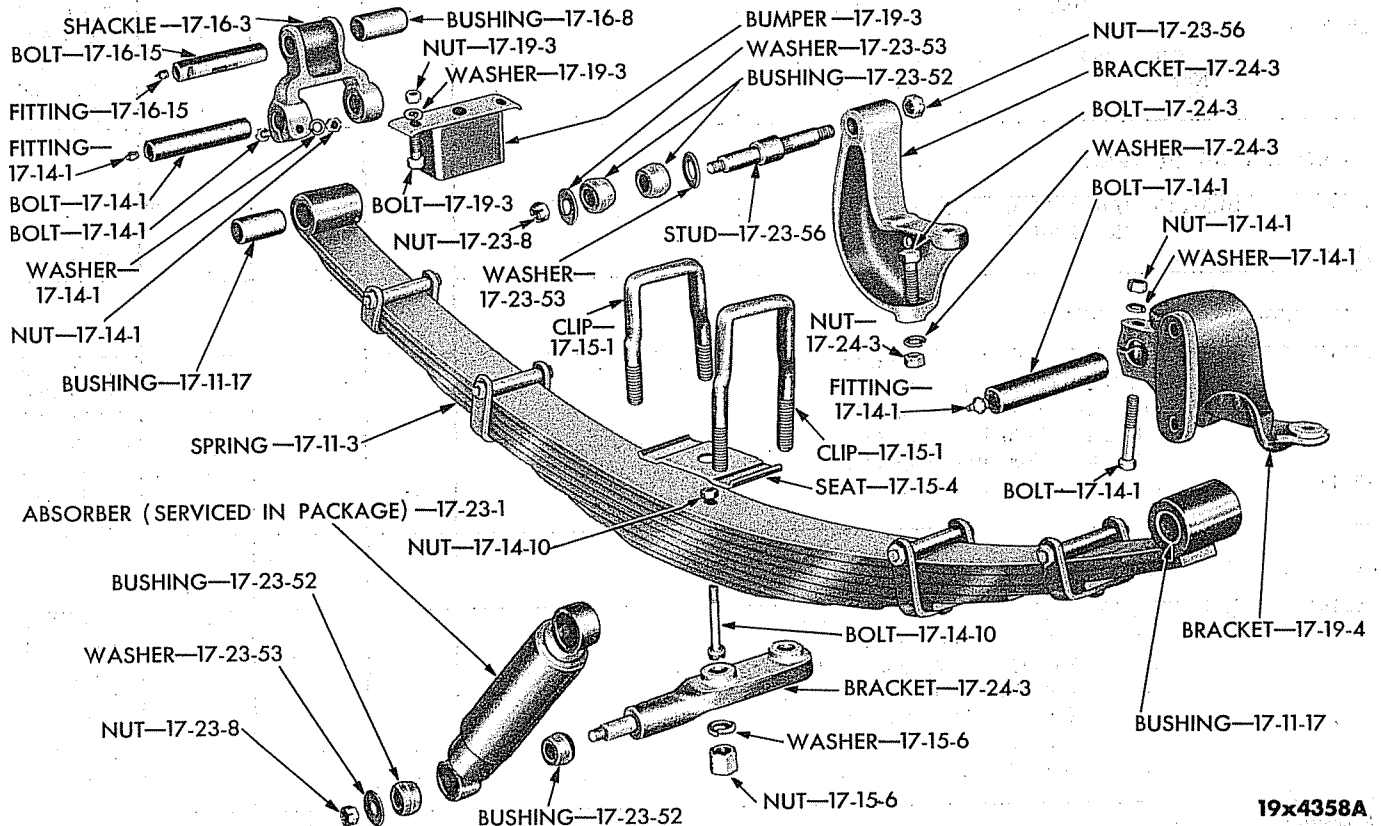

19x4358A

Plate 17-2

REAR SPRING (EXPLODED VIEW)

CODE	PART NAME AND DESCRIPTION	SERIES NO.	MODEL CODES		PART NO.
			DU	EU	
FRONT SPRING AND BUSHINGS					
17-01-3	SPRING (6 leaf) (1200 lbs. capacity)	-	2	2	1261 765
	(8 leaf) (1600 lbs. capacity)	-	2	2	1261 669
17-01-17	BUSHING	-	4	4	595 528
FRONT SPRING LEAF					
17-02-5	LEAF, No. 1	-	2	2	1261 670
	No. 2	-	2	2	1261 671
	No. 3 (for 1261 669 spring)	-	2	2	1262 641
	No. 3 (for 1261 765 spring)	-	2	2	1261 768
FRONT SPRING BOLTS					
17-04-1	BOLT, Center	-	2	2	593 805
	Nut	-	2	2	120 369
17-04-9	BOLT, Rear	-	2	2	595 529
	Fitting, lubricant	-	2	2	110 347
	Nut	-	2	2	128 180
	Pin, cotter	-	2	2	119 209
FRONT SPRING CLIPS					
17-05-1	CLIP (for 1261 669 spring)	-	4	4	527 160
	(for 1261 765 spring)	-	4	4	537 206
17-05-4	SEAT (for 1261 669 spring)	-	2	2	564 749
	(for 1261 765 spring)	-	2	2	1261 632
17-05-6	NUT	-	8	8	55 481
	Washer, lock	-	8	8	120 898
FRONT SPRING SHACKLE					
17-06-3	SHACKLE (inner)	-	2	2	1261 562
	(outer)	-	2	2	1261 563
17-06-13	BOLT	-	4	4	595 529
	Fitting, lubricant	-	4	4	110 347
	Nut	-	4	4	128 180
	Pin, cotter	-	4	4	119 209
FRONT SPRING BUMPER					
17-08-3	BUMPER (for 1261 669 spring)	-	2	2	1089 536
	(for 1261 765 spring)	-	2	2	1262 099
17-08-8	BLOCK	-	2	2	1267 843
REAR SPRING AND BUSHINGS					
17-11-3	SPRING (8 leaf) (2400 lbs. capacity)	-	2	-	1261 990
	(8 leaf) (1900 lbs. capacity)	-	2	-	E1393 058
	(8 leaf) (2400 lbs. capacity)	-	-	2	1261 983
	(8 leaf) (2700 lbs. capacity)	-	-	2	E1393 439
	(7 leaf) (3200 lbs. capacity)	-	-	2	1261 262
17-11-17	BUSHING	-	4	-	1261 542
		-	-	4	1261 547
REAR SPRING LEAF					
17-12-4	LEAF, No. 1	-	2	-	1261 991
	No. 1 (for 1261 983 spring)	-	-	2	1261 984
	No. 1 (for 1261 262, and 1939 439 spring)	-	-	2	1261 664
	No. 2 (for 1261 990 spring)	-	2	-	1261 992
	No. 2 (for 1393 058 spring)	-	2	-	E1393 059
	No. 2 (for 1261 983 spring)	-	-	2	1263 335
	No. 2 (for 1261 262, and 1393 439 spring)	-	-	2	1261 665

★ Indicates use as required.

E Indicates parts not listed in any previous parts books.

Series No. (1 indicates B-1 Series) (2 indicates B-2 Series) (3 indicates B-3 Series) (4 indicates B-4 Series)

Where no Series No. is shown part is for B-1, B-2, B-3 and B-4 Series.

March 30, 1953

Page 17-2

Prices and specifications subject to change without notice.

Printed in U.S.A.

CODE	PART NAME AND DESCRIPTION	SERIES NO.	MODEL CODES		PART NO.
			DU	EU	
REAR SPRING LEAF - Cont'd					
17-12-4	LEAF, No. 3 (for 1261 990 spring)	-	2	-	1261 993
	No. 3 (for 1393 058 spring)	-	2	-	E1393 060
	No. 3 (for 1261 983 spring)	-	-	2	1261 985
	No. 3 (for 1261 262 spring)	-	-	2	1261 666
	No. 3 (for 1393 439 spring)	-	-	2	E1393 440
REAR SPRING BOLTS					
17-14-1	BOLT, Front and Rear	-	4	4	1261 538
	Bolt, 3/8"-24 x 2 1/2"	-	4	4	120 640
	Nut	-	4	4	120 369
	Washer, lock	-	4	4	120 382
	Fitting, lubricant	-	4	4	145 433
17-14-10	BOLT, Center	-	2	2	593 808
	Nut	-	2	2	120 370
REAR SPRING CLIPS					
17-15-1	CLIP (w/o shock absorbers)	-	4	-	1261 668
	(w/shock absorbers)	-	2	-	1261 668
	(w/shock absorbers)	-	2	-	1262 704
	(w/o shock absorbers)	-	-	4	1261 179
	(w/shock absorbers)	-	-	2	1261 179
	(w/shock absorbers)	-	-	2	1262 705
17-15-4	SEAT	-	2	-	1261 539
		-	-	2	1261 188
17-15-6	NUT	-	8	8	510 855
	Washer, lock	-	8	8	121 574
REAR SPRING SHACKLE					
17-16-3	SHACKLE, w/BUSHING (use with steel floor panel)	-	2	-	1261 540
	(use with plywood and steel floor panel)	-	2	-	1267 841
	(use with steel floor panel)	-	-	2	1261 637
	(use with plywood and steel floor panel)	-	-	2	1270 264
17-16-8	BUSHING	-	2	2	588 223
17-16-15	BOLT	-	2	2	588 224
	Bolt, 3/8"-24 x 2 1/2"	-	2	2	120 640
	Nut	-	2	2	120 369
	Washer, lock	-	2	2	120 382
	Fitting, lubricant	-	2	2	145 433
REAR SPRING BUMPER					
17-19-3	BUMPER	-	2	2	1263 375
	Bolt, 7/16"-20 x 1-1/4"	-	4	4	123 841
	Nut	-	4	4	120 370
	Washer, lock	-	4	4	120 383
17-19-4	BRACKET (right)	-	1	1	1261 230
	(left)	-	1	1	1261 231
	Bolt, 3/8"-24 x 1 1/4"	-	4	4	121 615
	Nut	-	4	4	120 369
	Washer, lock	-	4	4	120 382
17-19-11	SPACER (for 1393 058 and 1393 439 springs)	-	2	-	1270 393
SHOCK ABSORBERS					
17-23-3	ABSORBER and BUSHING PACKAGE (front and rear)	-	4	4	E1326 075
	(Oriflow type)	-	2	2	E1316 206
	(front) (1 3/8" diam.)	-	2	2	E1316 170
	(rear) (1" diam.)	-	2	2	E1450 064
	(rear) (1 3/8" diam.)	-	2	2	126 022
	Nut	-	8	8	

★Indicates use as required.

EIndicates parts not listed in any previous parts books.

Series No. (1 indicates B-1 Series) (2 indicates B-2 Series) (3 indicates B-3 Series) (4 indicates B-4 Series)

Where no Series No. is shown part is for B-1, B-2, B-3 and B-4 Series.

Prices and specifications subject to change without notice.

CODE	PART NAME AND DESCRIPTION	SERIES NO.	MODEL CODES		PART NO.
			DU	EU	
SHOCK ABSORBERS - Cont'd					
17-23-4	FLUID (quart)	-	★	★	680 177
	(gallon)	-	★	★	830 672
17-23-52	BUSHING, Pivot (47/64" lgh.) (2 required per eye)	-	16	16	668 164
	(1 17/32" lgh., 1 1/4" O.D.) (1 required per eye)	-	8	8	1314 840
	(1 1/2" lgh., 1 3/8" O.D.) (1 required per eye)	-	8	8	1325 181
17-23-53	WASHER, Pivot Bushing (inner) (1 1/4" O.D.)	-	4	4	855 917
	(inner) (1 1/2" O.D.) (flat type)	-	4	4	1325 183
	(inner) (1 1/2" O.D.) (cup type)	-	4	4	1142 547
	(outer) (1 1/4" O.D.)	-	4	4	855 004
	(outer) (1 1/2" O.D.) (flat type)	-	4	4	1325 182
	(outer) (1 1/2" O.D.) (cup type)	-	4	4	1142 548
17-23-56	STUD, Axle (front)	-	2	-	912 427
	(front)	-	-	2	1262 024
	(rear)	-	2	2	912 427
	Nut	-	2	2	126 016
SHOCK ABSORBER BRACKET					
17-24-3	BRACKET, Rear Axle	-	2	-	1262 702
	Frame (right front) (use with steel floor panel)	-	-	2	1262 703
	(right front) (use with plywood and steel floor panel)	-	1	1	1262 022
	(left front) (use with floor panel)	-	1	1	1267 844
	(left front) (use plywood and steel floor panel)	-	1	1	1262 023
	Bolt, 7/16-20 x 1 3/4" (long)	-	2	2	120 919
	Bolt, 7/16"-20 x 1 1/4" (short)	-	2	2	123 841
	Nut	-	4	4	120 370
	Washer, lock	-	4	4	120 383
	Washer, plain	-	4	4	120 395
	BRACKET, Frame (right rear)	-	1	1	1262 700
	(left rear)	-	1	1	1262 701
	Bolt, 7/16"-20 x 1 1/2"	-	6	6	123 852
	Nut	-	6	6	120 370
	Washer, lock	-	6	6	120 383

★Indicates use as required.

Prices and specifications subject to change without notice.

☐Indicates parts not listed in any previous parts books.

Series No. (1 indicates B-1 Series) (2 indicates B-2 Series) (3 indicates B-3 Series) (4 indicates B-4 Series)

Where no Series No. is shown part is for B-1, B-2, B-3 and B-4 Series.

March 30, 1953

CODE	PART NAME AND DESCRIPTION	SERIES NO.	MODEL CODES		PART NO.		
			DU	EU			
SHOCK ABSORBER COMPONENT PARTS							
		SHOCK ABSORBER PART NO. STAMPED ON DIRT SHIELD					
PART TYPE CODE	SHOCK ABSORBER	1262 020	1262 699	1265 830	1265 831	1266 648	1266 649
17-26-2	VALVE, Compression.	1262 055	1265 829	1266 419	1266 420	1266 419	1266 420
17-26-6	TUBE, Cylinder.	----	----	1274 202	1274 202	----	----
17-26-11	PISTON.	689 784	689 784	1313 661	1313 661	689 784	689 784
17-26-12	NUT, Piston.	1122 610	1122 610	1314 336	1314 336	1122 610	1122 610
17-26-14	WASHER, Piston, w/PIN	689 787	689 787	689 787	689 787	689 787	689 787
17-26-15	SPACER, Piston Washer	689 790	689 790	689 790	689 790	689 790	689 790
17-26-16	VALVE, Piston Intake.	689 785	689 785	689 785	689 785	689 785	689 785
17-26-18	SPRING, Intake Valve Spider	689 786	689 786	689 786	689 786	689 786	689 786
17-26-19	GUIDE, Piston Rod, w/SEAL.	960 011	960 011	----	----	960 011	960 011
	GUIDE, Piston Rod	----	----	1313 740	1313 740	----	----
17-26-20	SPRING, Guide Seal.	----	----	1313 737	1313 737	----	----
17-26-22	NUT, Guide Retainer	----	----	1313 741	1313 741	----	----
17-26-23	GASKET, Guide Reservoir	958 375	958 375	----	----	958 375	958 375
	GASKET, Guide Seal	----	----	1313 738	1313 738	----	----
17-26-24	RETAINER, Reservoir Gasket	958 376	958 376	----	----	----	958 376
	RETAINER, Guide Seal	----	----	1313 736	1313 736	----	----
17-26-25	SEAL, Rod Guide	----	----	1313 739	1313 739	----	----
17-26-28	CAP, Rod Guide Seal	----	----	1313 735	1313 735	----	----
17-26-31	SPRING, Rebound Valve.	----	----	677 860	698 483	677 860	698 483
17-26-32	DISC, Rebound Valve Spring	689 791	1266 439	689 792	1266 439	689 792	1266 439
17-26-33	WASHER, Rebound Valve Spring Disc.	689 793	689 793	689 793	689 793	689 793	689 793
17-26-36	SEAT, Rebound Valve Spring.	689 794	689 794	689 794	689 794	689 794	689 794
17-26-38	PLATE, Rebound Valve Orifice.	853 065	853 065	853 065	853 065	⊠1405 028	⊠1405 028
17-26-40	BAFFLE, Reservoir	----	----	1314 331	1314 331	----	----

NOTES

★Indicates use as required. Prices and specifications subject to change without notice.
 ⊠Indicates parts not listed in any previous parts books.
 Series No. (1 indicates B-1 Series) (2 indicates B-2 Series) (3 indicates B-3 Series) (4 indicates B-4 Series)
 Where no Series No. is shown part is for B-1, B-2, B-3 and B-4 Series.
 Page 17-5 Printed in U.S.A. March 30, 1953

GROUP 18 - STANDARD PARTS

STANDARD PARTS

Standard Parts, such as Bolts, Nuts, Screws, Rivets, Plainwashers, Lockwashers, etc., are listed in this Parts List immediately under the part which they attach. For further information see Standard Parts List D-11171.

GROUP 19 - STEERING

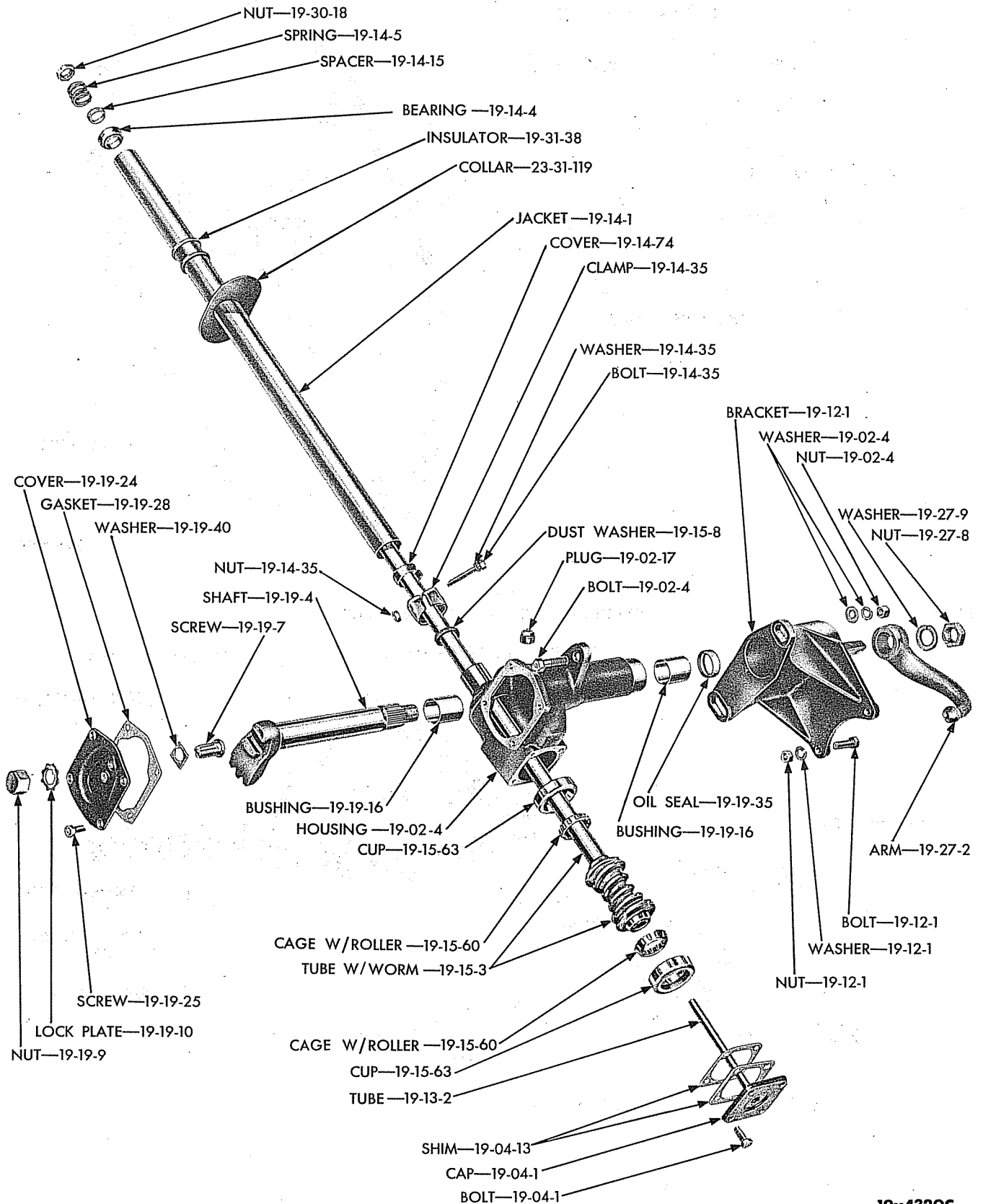

19x4320C

Plate 19-1

STEERING GEAR (EXPLODED VIEW)

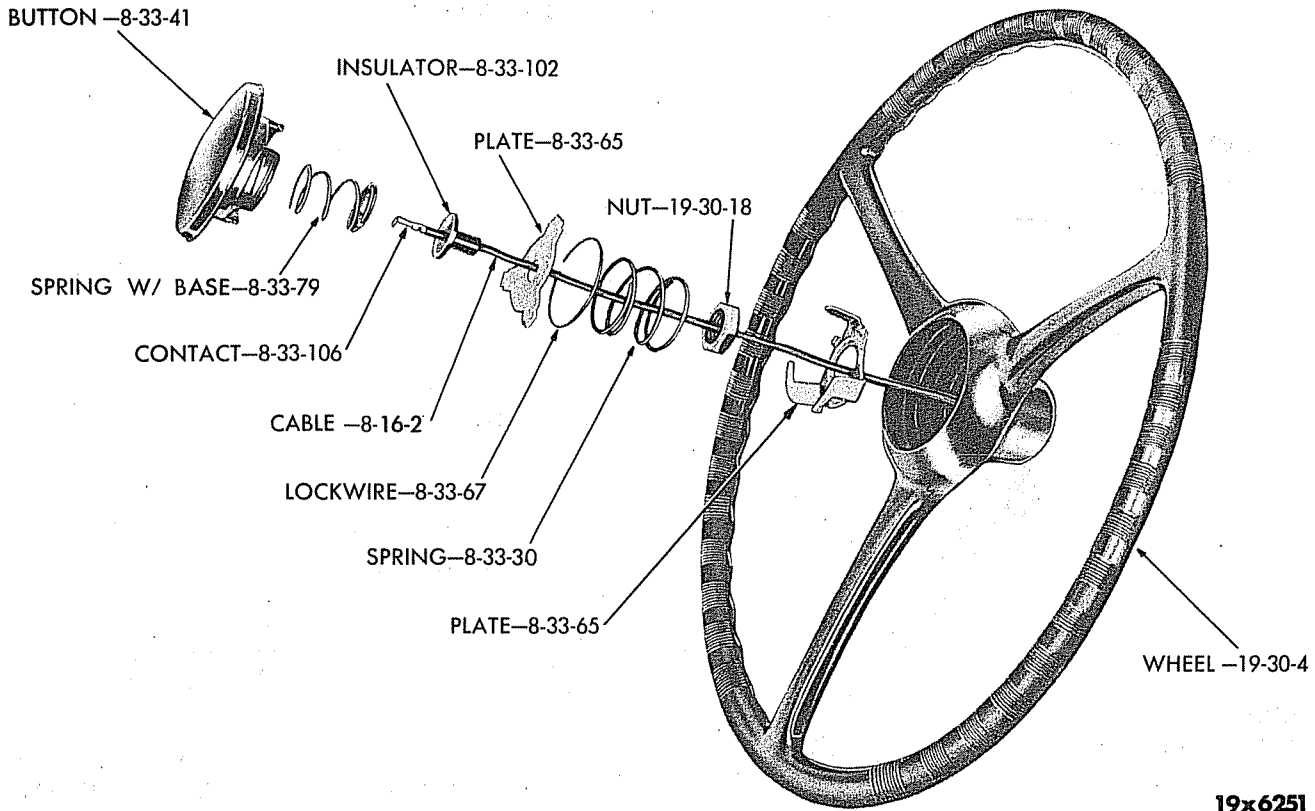

19x6251

Plate 19-2

STEERING WHEEL (EXPLODED VIEW)

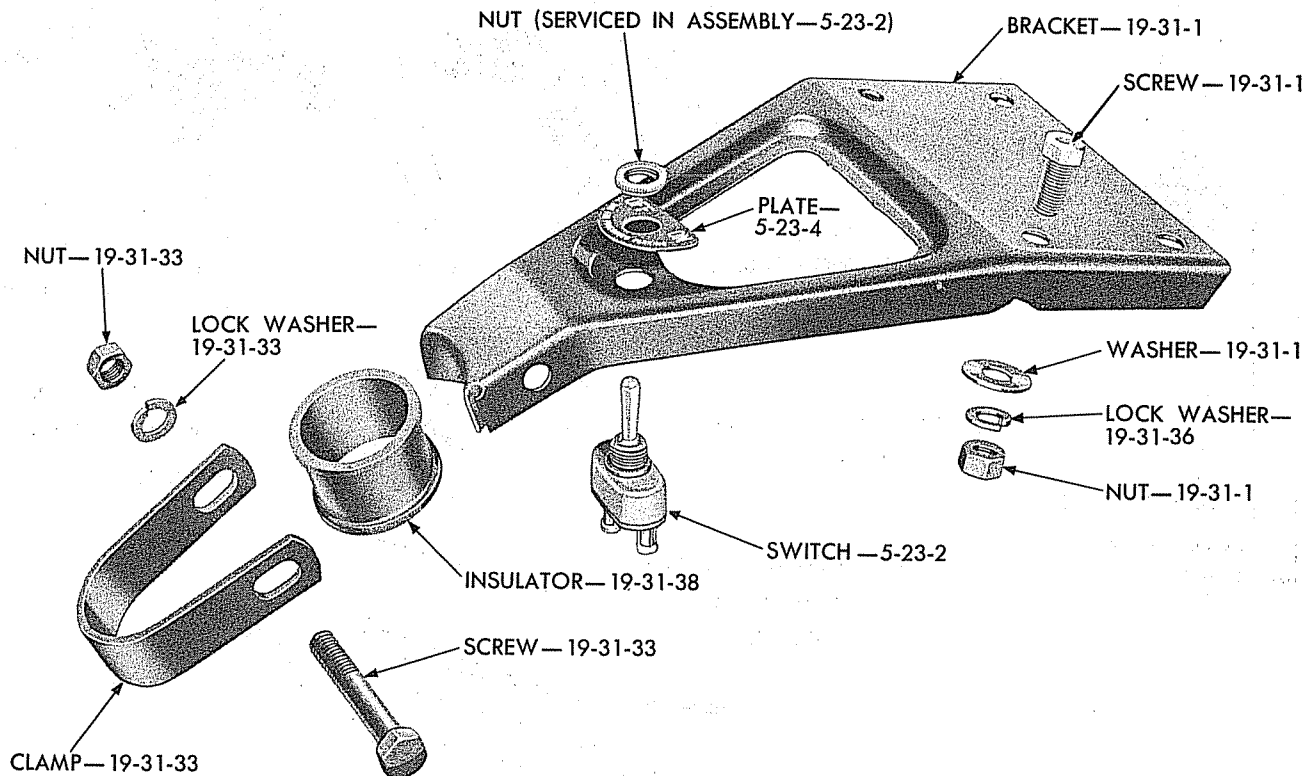

19x6250

Plate 19-3

STEERING POST BRACKET (EXPLODED VIEW)

CODE	PART NAME AND DESCRIPTION	SERIES NO.	MODEL CODES		PART NO.
			DU	EU	
STEERING GEAR ASSEMBLY					
19-01-8	CHUCK	-	1	-	1262 110
		-	-	1	1262 120
STEERING GEAR HOUSING					
19-02-4	HOUSING, w/BUSHING.	-	1	-	1262 111
	Bolt, 7/16"-14 x 1-1/4" (to frame bracket)	-	-	1	1262 121
	7/16"-20 x 1-3/4" (to frame bracket)	-	2	1	122 267
	Nut	-	2	1	120 919
	Washer, lock	-	2	2	120 370
	Washer, plain	-	2	2	120 383
19-02-17	PLUG, Oil Filter.	-	1	1	120 395
1142					221
STEERING GEAR HOUSING LOWER COVER					
19-04-1	CAP	-	1	-	1092 193
	Bolt, 5/16"-18 x 5/8"	-	4	-	120 228
	Washer, lock	-	4	-	120 214
	COVER	-	-	1	1189 861
19-04-2	GASKET	-	-	1	1188 667
19-04-5	SCREW, Lower Cover (5/16"-18 x 3/4")	-	-	4	1188 669
19-04-13	SHIM, Cap	-	★	-	1142 261
	Cover, Thin (.003)	-	-	★	1188 675
	(.006)	-	-	★	620 180
	Thick (.011)	-	-	★	620 181
STEERING GEAR TO FRAME BRACKET					
19-12-1	BRACKET	-	1	1	1262 512
	Bolt, 7/16"-20 x 1 1/2"	-	4	4	123 852
	Nut	-	4	4	120 370
	Washer, lock	-	4	4	120 383
STEERING GEAR GREASE RETAINING TUBE					
19-13-2	TUBE	-	1	-	618 317
		-	-	1	918 358
STEERING COLUMN JACKET					
19-14-1	JACKET, w/BEARING	-	1	1	1262 785
19-14-4	BEARING	-	1	1	1188 659
19-14-5	SPRING, Bearing	-	1	-	1189 247
		-	-	1	1188 660
19-14-15	SPACER, Bearing	-	1	-	1189 246
		-	-	1	1188 661
19-14-35	CLAMP	-	1	1	386 699
	Bolt, 5/16"-24 x 2"	-	1	1	121 783
	Nut	-	1	1	120 368
	Washer, lock	-	1	1	120 214
19-14-74	COVER, Oil Hole.	-	1	-	386 701
STEERING GEAR TUBE AND WORM					
19-15-3	TUBE, w/WORM	-	1	-	1262 116
		-	-	1	1262 126
19-15-4	TUBE	-	-	1	1262 127
19-15-8	WASHER, Tube and Housing Dust	-	1	-	1192 696
		-	-	1	1192 693
19-15-60	CAGE, Thrust Bearing, w/ROLLERS	-	2	-	669 077
	w/ROLLERS, Upper	-	-	1	376 749
	w/ROLLERS, Lower	-	-	1	640 086

★Indicates use as required.

Prices and specifications subject to change without notice.

□Indicates parts not listed in any previous parts books.

Series No. (1 indicates B-1 Series) (2 indicates B-2 Series) (3 indicates B-3 Series) (4 indicates B-4 Series)

Where no Series No. is shown part is for B-1, B-2, B-3 and B-4 Series.

CODE	PART NAME AND DESCRIPTION	SERIES NO.	MODEL CODES		PART NO.
			DU	EU	
STEERING GEAR TUBE AND WORM - Cont'd					
19-15-63	CUP, Thrust Bearing, Lower	-	1	-	632 685
	Lower	-	-	1	637 539
	Upper	-	1	-	618 311
	Upper	-	-	1	376 751
STEERING GEAR SHAFT ASSEMBLY					
19-19-4	SHAFT, Assembly	-	1	-	1262 185
		-	-	1	1262 187
19-19-7	SCREW, Adjusting (1/2"-20 x 1 1/4")	-	1	-	682 905
	(5/16"-18 x 1 5/16")	-	-	1	1188 652
19-19-9	NUT, Adjusting Screw	-	1	-	682 906
		-	-	1	1188 655
19-19-10	PLATE, Adjusting Screw Lock	-	1	-	682 907
		-	-	1	1188 653
19-19-16	BUSHING, Housing Bracket	-	2	-	582 880
		-	-	2	1188 651
19-19-24	COVER	-	1	-	682 874
	Housing	-	-	1	1188 677
	Washer, lock	-	4	-	138 485
19-19-25	SCREW, Cover (5/16"-18 x 9/16")	-	4	4	1188 668
	Cap (5/16"-18 x 9/16")	-	4	-	1188 668
19-19-28	GASKET, Cover	-	1	-	1142 262
19-19-35	OIL SEAL	-	1	-	1138 282
		-	-	1	1138 281
19-19-40	WASHER, Thrust	-	1	-	682 904
		-	-	1	1188 654
STEERING GEAR ARM					
19-27-2	ARM	-	1	-	1262 455
		-	-	1	1262 405
19-27-8	NUT	-	1	1	52 833
19-27-9	WASHER, Nut Lock	-	1	1	52 855
19-27-31	ARM, w/BUSHING	-	1	1	1262 259
	Bolt, 3/8"-24 x 2 1/2" (frame bracket clamp)	-	1	1	120 640
	Nut	-	1	1	120 369
	Washer, lock	-	1	1	120 382
	Pin, cotter	-	1	1	108 636
19-27-32	SHAFT, Idler Arm	-	1	1	589 565
	Fitting, lubricant	-	1	1	145 433
19-27-33	BRACKET, Idler Arm Frame	-	1	1	1261 233
19-27-34	BUSHING, Idler Arm	-	1	1	572 130
STEERING WHEEL					
19-30-4	WHEEL	-	1	-	1195 035
		-	-	1	1194 926
		-	1	-	1272 165
	Nut	-	-	1	1272 166
19-30-18	NUT (up to serial No. 84002365)	-	1	-	145 013
	(after serial No. 84002365)	-	-	1	852 414
		-	-	1	520 229
STEERING POST BRACKET					
19-31-1	BRACKET	-	1	1	1198 595
	Bolt, 5/16"-24 x 3/4"	-	4	4	120 741
	Nut	-	4	4	120 368
	Washer, plain	-	4	4	120 387

★Indicates use as required. Prices and specifications subject to change without notice.
 ☐Indicates parts not listed in any previous parts books.
 Series No. (1 indicates B-1 Series) (2 indicates B-2 Series) (3 indicates B-3 Series) (4 indicates B-4 Series)
 Where no Series No. is shown part is for B-1, B-2, B-3 and B-4 Series.
 March 30, 1953 Page 19-4 Printed in U.S.A.

GROUP 21 - TRANSMISSION

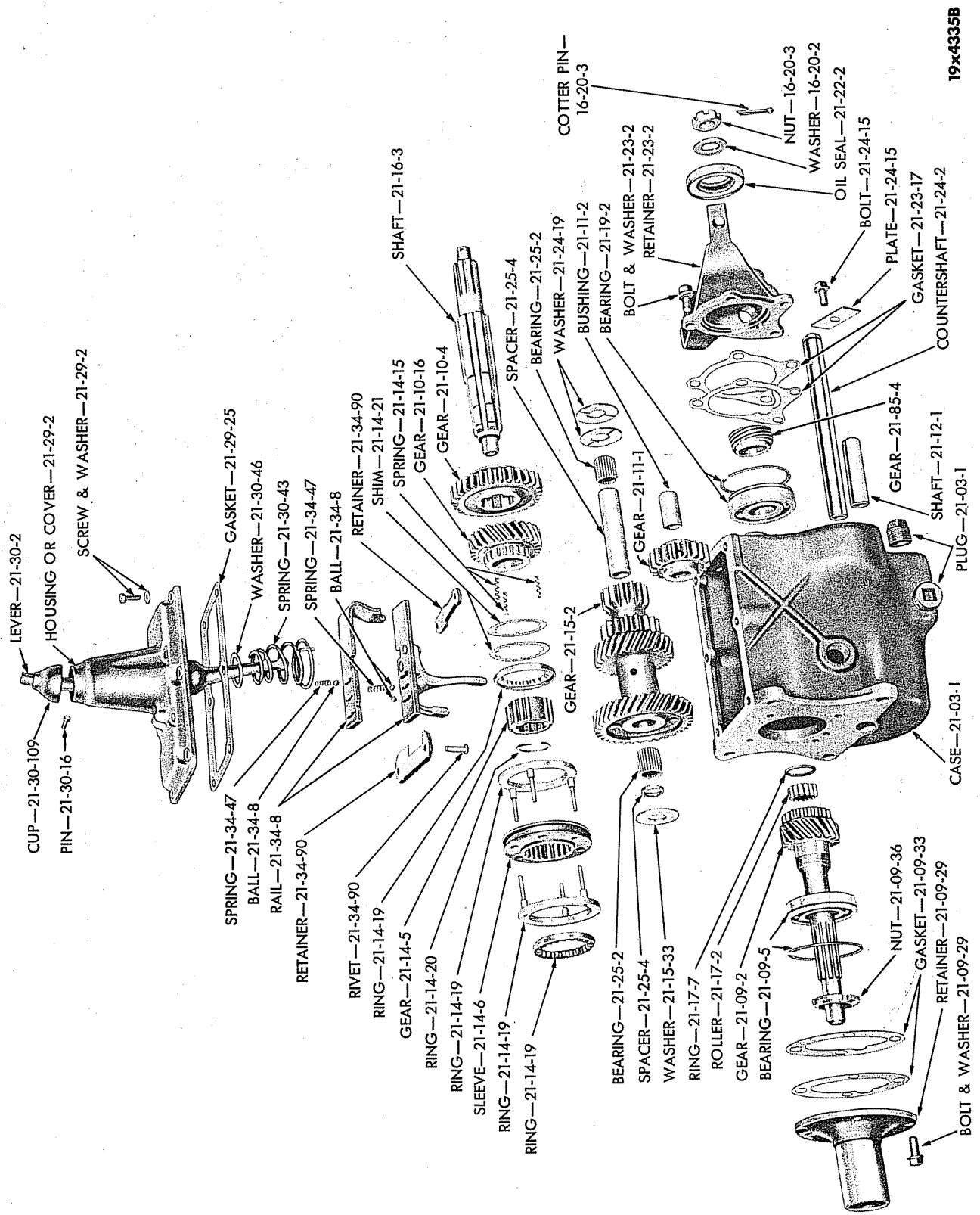

19x4335B

TRANSMISSION - 3 SPEED (EXPLODED VIEW)

Plate 21-1

CODE	PART NAME AND DESCRIPTION	SERIES NO.	MODEL CODES		PART NO.
			DU	EU	
TRANSMISSION SERVICE PACKAGES					
21-01-3	GASKET PACKAGE (3 Speed)	-	1	-	1063 658
	(4 Speed)	-	1	1	1243 622
TRANSMISSION ASSEMBLY (LESS COVER AND CONTROLS)					
21-02-1	TRANSMISSION (w/o Fluid Drive) (3 Speed)	-	1	-	1261 512
	(w/Fluid Drive) (3 Speed)	-	1	-	1262 708
	(w/o Fluid Drive) (4 Speed)	-	-	1	1261 515
	(w/Fluid Drive)	-	1	1	1262 711
TRANSMISSION CASE					
21-03-1	CASE (3 Speed)	-	1	-	599 291
	(4 Speed)	-	1	1	1261 863
	Plug, pipe (filler)	-	1	1	103 875
	Plug, pipe (drain)	-	1	1	103 869
POWER TAKE-OFF					
21-08-1	COVER	-	1	1	556 875
	Bolt, 3/8"-16 x 3/4"	-	6	6	122 119
	Washer, lock	-	6	6	120 382
21-08-3	GASKET, Cover	-	1	1	567 500
MAIN DRIVE GEAR AND RETAINER					
21-09-2	GEAR (3 Speed) (w/o Fluid Drive)	-	1	-	1196 886
	(3 Speed) (w/Fluid Drive)	-	1	-	1196 755
	(4 Speed) (w/o Fluid Drive)	-	-	1	1091 489
	(4 Speed) (w/Fluid Drive)	-	1	1	1194 313
21-09-5	BEARING, Gear (3 Speed)	-	1	-	619 167
	(4 Speed)	-	1	1	1090 119
21-09-22	SNAP RING, Drive Gear Bearing (4 Speed)	-	1	1	1090 125
21-09-23	SNAP RING, Drive Gear (4 Speed)	-	1	1	556 833
21-09-29	RETAINER (Drive Gear Bearing (3 Speed) (w/o Fluid Drive)	-	1	-	579 304
	(3 Speed) (w/Fluid Drive)	-	1	-	1263 897
	(4 Speed) (w/o Fluid Drive)	-	-	1	1265 638
	(4 Speed) (w/Fluid Drive)	-	1	1	1263 836
	Bolt, 3/8"-16 x 1" (3 Speed)	-	3	-	120 233
	Bolt, 3/8"-16 x 2" (3 Speed)	-	1	-	122 181
	Bolt, 5/16"-18 x 3/4" (4 Speed)	-	2	2	122 007
	Bolt, 5/16"-18 x 5/8" (4 Speed)	-	2	2	120 228
	Washer, lock	-	4	2	138 485
	Washer, lock	-	-	2	120 214
21-09-33	GASKET, Retainer (3 Speed)	-	1	-	579 234
	(4 Speed)	-	2	2	1090 121
21-09-36	NUT, Bearing Lock (3 Speed)	-	1	-	579 199
MAIN SHAFT GEARS					
21-10-4	GEAR, First and Reverse Sliding (3 Speed)	-	1	-	E1394 366
21-10-6	GEAR, Low and Second (4 Speed)	-	1	1	1090 123
21-10-16	GEAR, Second Speed (3 Speed)	-	1	-	1196 897
21-10-78	GEAR, Third and Direct (4 Speed)	-	1	1	1091 490
REVERSE IDLER GEAR					
21-11-1	GEAR, w/BUSHING (3 Speed)	-	1	-	E1394 367
	(4 Speed)	-	1	1	1090 139
21-11-2	BUSHING (3 Speed)	-	1	-	579 197

★Indicates use as required.

Prices and specifications subject to change without notice.

E Indicates parts not listed in any previous parts books.

Series No. (1 indicates B-1 Series) (2 indicates B-2 Series) (3 indicates B-3 Series) (4 indicates B-4 Series)

Where no Series No. is shown part is for B-1, B-2, B-3 and B-4 Series.

CODE	PART NAME AND DESCRIPTION	SERIES NO.	MODEL CODES		PART NO.
			DU	EU	
REVERSE IDLER SHAFT					
21-12-1	SHAFT, Gear (3 Speed)	-	1	-	579 203
	(4 Speed)	-	1	1	1090 141
CLUTCH GEAR AND SLEEVE					
21-14-5	GEAR (3 Speed)	-	1	-	1270 335
21-14-6	SLEEVE, Sliding (3 Speed)	-	1	-	1196 888
21-14-15	SPRING (3 Speed)	-	3	-	1196 898
21-14-19	RING, Synchronizer Stop, w/PINS (3 Speed)	-	2	-	1196 894
	RING, Synchronizer Stop (inner) (3 Speed)	-	2	-	1196 890
21-14-20	SNAP RING, Synchronizer (thin) (3 Speed)	-	★	-	631 823
	(medium) (3 Speed)	-	★	-	631 824
	(thick) (3 Speed)	-	★	-	631 825
	(extra thick) (3 Speed)	-	★	-	640 332
21-14-21	SHIM, Synchronizer Stop Ring (3 Speed)	-	★	-	1196 892
COUNTERSHAFT GEARS					
21-15-2	GEARS (cluster) (3 Speed)	-	1	-	E1394 369
	(4 Speed)	-	1	1	1090 132
21-15-33	WASHER, Thrust (3 Speed) (.120 thk.)	-	★	-	584 310
	(3 Speed) (.124 thk.)	-	★	-	579 198
	(4 Speed)	-	3	3	1090 137
MAIN SHAFT					
21-16-3	SHAFT (3 Speed)	-	1	-	599 734
	(4 Speed)	-	1	1	1091 851
MAIN SHAFT PILOT BEARING					
21-17-2	ROLLERS (3 Speed)	-	14	-	602 007
	BEARING (4 Speed)	-	1	1	1091 903
21-17-7	SNAP RING (3 Speed)	-	1	-	601 108
21-17-9	SPACER (4 Speed)	-	1	1	1091 904
MAIN SHAFT REAR BEARING					
21-19-2	BEARING (3 Speed)	-	1	-	579 211
	(4 Speed)	-	1	1	957 846
MAIN SHAFT REAR BEARING OIL SEAL					
21-22-2	OIL SEAL (3 Speed)	-	1	-	600 420
	(4 Speed)	-	1	1	593 596
MAIN SHAFT REAR BEARING RETAINER					
21-23-2	RETAINER (3 Speed)	-	1	-	1262 032
	(4 Speed)	-	1	1	1262 867
	Bolt, 3/8"-16 x 1" (3 Speed)	-	4	-	120 233
	Bolt, 5/16"-18 x 1" (short)	-	1	1	122 017
	Bolt, 5/16"-18 x 2" (long)	-	4	4	122 065
	Washer, lock	-	4	-	120 382
	Washer, lock	-	5	5	120 214
21-23-4	SNAP RING, Bearing (4 Speed)	-	1	1	1090 130
21-23-17	GASKET (3 Speed)	-	1	-	579 234
	(4 Speed)	-	2	2	1090 129
COUNTERSHAFT					
21-24-2	COUNTERSHAFT (3 Speed)	-	1	-	579 200
	(4 Speed)	-	1	1	1090 133

★ Indicates use as required.

⊠ Indicates parts not listed in any previous parts books.

Series No. (1 indicates B-1 Series) (2 indicates B-2 Series) (3 indicates B-3 Series) (4 indicates B-4 Series)

Where no Series No. is shown part is for B-1, B-2, B-3 and B-4 Series.

March 30, 1953

Prices and specifications subject to change without notice.

Printed in U.S.A.

CODE	PART NAME AND DESCRIPTION	SERIES NO.	MODEL CODES		PART NO.
			DU	EU	
COUNTERSHAFT - Cont'd					
21-24-15	PLATE, Reverse Idler and Countershaft Lock (3 Speed)	-	1	-	579 194
	(4 Speed)	-	1	1	556 888
	Bolt, 3/8"-16 x 3/4"	-	1	-	122 119
	Washer, lock	-	1	1	120 382
21-24-19	WASHER, End (3 Speed)	-	2	-	579 230
COUNTERSHAFT BEARINGS					
21-25-2	BEARING, Needle (3 Speed)	-	44	-	580 203
	(4 Speed)	-	88	88	565 291
21-25-4	SPACER (3 Speed)	-	1	-	579 231
	End (3 Speed)	-	2	-	579 193
	(4 Speed)	-	2	2	1090 135
GEARSHIFT COVER					
21-29-2	COVER (w/o Fluid Drive) (3 Speed)	-	1	-	599 737
	(w/Fluid Drive) (3 Speed)	-	1	-	1263 860
	(w/o Fluid Drive) (4 Speed)	-	-	1	1090 144
	(w/Fluid Drive) (4 Speed)	-	1	1	1194 257
	Bolt, 5/16"-18 x 7/8"	-	6	-	120 229
	Bolt, 3/8"-16 x 1 1/2"	-	-	6	120 918
	Bolt, 3/8" -16 x 1"	-	3	3	120 233
	Bolt, 3/8"-16 x 2"	-	3	3	122 181
	Washer, lock	-	6	-	120 214
	Washer, lock	-	6	6	120 382
21-29-25	GASKET (3 Speed)	-	1	-	579 217
	(4 Speed)	-	1	1	1196 668
21-29-46	STOP, Reverse Shift (4 Speed)	-	1	1	571 392
21-29-47	WASHER, Reverse Shift Stop Plunger (4 Speed)	-	1	1	313 514
21-29-48	SPRING, Stop Plunger (4 Speed)	-	1	1	572 035
21-29-51	PLUG, Reverse Stop (4 Speed)	-	1	1	313 503
GEARSHIFT LEVER					
21-30-2	LEVER (w/o Fluid Drive) (3 Speed)	-	1	-	1262 243
	(w/Fluid Drive) (3 Speed)	-	1	-	1262 694
	(w/o Fluid Drive) (4 Speed)	-	-	1	1261 234
	(w/Fluid Drive) (4 Speed)	-	1	1	1262 693
21-30-6	KNOB (3 Speed)	-	1	-	580 416
	(4 Speed)	-	1	1	42 971
21-30-16	PIN, Guide	-	1	1	571 390
21-30-43	SPRING	-	1	1	584 309
21-30-46	WASHER, or Plate BALL	-	1	1	571 391
21-30-109	CAP, Ball	-	1	1	317 448
21-30-149	RETAINER, First Speed Stop Plunger Spring (4 Speed)	-	1	1	313 515
21-30-153	NUT, First Speed Stop Retainer Check (4 Speed)	-	1	1	313 516
GEARSHIFT RAIL					
21-34-8	RAIL, Second and Direct (w/o Fluid Drive) (3 Speed)	-	1	-	1263 467
	Low and Reverse (w/o Fluid Drive) (3 Speed)	-	1	-	579 221
	Second and Direct (w/Fluid Drive) (3 Speed)	-	1	-	1196 900
	Low and Reverse (w/Fluid Drive) (3 Speed)	-	1	-	1196 836
	Third and Direct (w/o Fluid Drive) (4 Speed)	-	-	1	1090 146
	Reverse Shift (w/o Fluid Drive) (4 Speed)	-	-	1	1090 147
	Low and Second (w/o Fluid Drive) (4 Speed)	-	-	1	1090 148
	Reverse Fork (4 Speed)	-	1	1	1090 138
	Third and Direct (w/Fluid Drive) (4 Speed)	-	1	1	1194 258
	Reverse Shift (w/Fluid Drive) (4 Speed)	-	1	1	1194 259
	Low and Second (w/Fluid Drive) (4 Speed)	-	1	1	1194 260
	Ball (3 Speed)	-	2	-	104 919
	Ball (3 Speed)	-	1	-	119 282

★Indicates use as required.

Prices and specifications subject to change without notice.

□Indicates parts not listed in any previous parts books.

Series No. (1 indicates B-1 Series) (2 indicates B-2 Series) (3 indicates B-3 Series) (4 indicates B-4 Series)

Where no Series No. is shown part is for B-1, B-2, B-3 and B-4 Series.

CODE	PART NAME AND DESCRIPTION	SERIES NO.	MODEL CODES		PART NO.
			DU	EU	
GEARSHIFT RAIL - Cont'd					
	Ball (4 Speed)	-	3	3	104 920
	Pin, cotter (4 Speed)	-	1	1	103 399
	Plug, expansion (4 Speed)	-	6	6	103 892
	Rivet (3 Speed)	-	4	-	104 168
21-34-10	BRACKET, Operating Second and Third (w/Fluid Drive) (3 Speed)	-	1	-	1196 835
	Rivet	-	2	-	104 168
21-34-32	END, Reverse Shift Rail (w/o Fluid Drive) (4 Speed)	-	-	1	556 902
	Low and Second Shift Rail (w/Fluid Drive) (4 Speed)	-	1	1	1194 341
	LUG, Reverse Shift Rail (w/Fluid Drive) (4 Speed)	-	1	1	1194 322
21-34-41	PLUNGER, Interlock (4 Speed)	-	2	2	556 882
21-34-42	PIN, Interlock (4 Speed)	-	1	1	556 890
21-34-43	STOP, Interlock Pin (4 Speed)	-	1	1	517 364
21-34-44	PLUG, Interlock (4 Speed)	-	1	1	928 178
21-34-47	SPRING, Selector Ball (3 Speed)	-	2	-	579 195
	Poppet (4 Speed)	-	3	3	517 373
21-34-90	RETAINER, Front (w/o Fluid Drive) (3 Speed)	-	1	-	579 235
	Front (w/Fluid Drive) (3 Speed)	-	1	-	1196 839
	Rear (w/o Fluid Drive) (3 Speed)	-	1	-	599 739
	Rear (w/Fluid Drive) (3 Speed)	-	1	-	579 235
	Bolt, 1/4"-20 x 3/4"	-	★	-	121 887
	Rivet	-	4	-	108 682
21-34-96	LOCK, Retainer to Cover Screw (w/Fluid Drive) (3 Speed)	-	2	-	1263 861
GEARSHIFT FORK					
21-39-3	FORK, First and Second Shift (w/o Fluid Drive) (4 Speed)	-	-	1	1090 149
	(w/Fluid Drive) (4 Speed)	-	1	1	1194 261
	Third and Direct Shift (w/o Fluid Drive) (4 Speed)	-	-	1	1090 150
	(w/Fluid Drive) (4 Speed)	-	1	1	1194 262
	Reverse Shift (w/o Fluid Drive) (4 Speed)	-	-	1	556 844
	(w/Fluid Drive) (4 Speed)	-	1	1	588 008
21-39-20	SCREW, to Rail (4 Speed)	-	3	3	517 362
21-39-23	LOCKWIRE, Screw (4 Speed)	-	★	★	572 551
SPEEDOMETER CABLE					
21-84-1	CABLE, w/SHAFT and HOUSING (B-1-DU up to approximately serial No. 84205169; B-1-EU up to approximately serial No. 84001147) (96" lgh.)	-	1	1	926 079
	(B-1-DU after approximately serial No. 84205169; B-1-EU after approximately serial No. 84001147) (96" lgh.)	-	1	1	1271 148
21-84-4	SHAFT, Drive (91" lgh.)	-	★	★	910 562
	(96" lgh.)	-	★	★	926 080
21-84-5	LUBRICANT (tube)	-	★	★	1243 632

★ Indicates use as required.

□ Indicates parts not listed in any previous parts books.

Series No. (1 indicates B-1 Series) (2 indicates B-2 Series) (3 indicates B-3 Series) (4 indicates B-4 Series)

Where no Series No. is shown part is for B-1, B-2, B-3 and B-4 Series.

March 30, 1953

Prices and specifications subject to change without notice.

SPEEDOMETER GEAR AND PINION

21-85-4 GEAR, Drive (see following chart)

21-85-5 PINION, Drive (see following chart)

3 SPEED TRANSMISSION

Tire Size	Ply	3.91 to 1 Ratio		4.3 to 1 Ratio		4.89 to 1 Ratio	
		Gear	Pinion	Gear	Pinion	Gear	Pinion
6.00 x 20	6-8	1268 547	1268 548	579 515	579 510	579 515	916 416
6.50 x 20	6	1268 547	1268 548	579 516	652 846	579 515	916 416
6.50 x 16	4-6	579 515	579 510	579 515	918 872	579 515	579 513
7.00 x 16	6	579 515	579 510	579 515	916 416	579 515	579 513
7.50 x 16	6-8	1268 547	1268 549	579 515	579 510	579 515	918 872
8.25 x 16	8	1268 547	1268 548	579 516	652 846	579 516	652 842

4 SPEED TRANSMISSION

Tire Size	Ply	3.91 to 1 Ratio		4.3 to 1 Ratio		4.89 to 1 Ratio		5.83 to 1 Ratio	
		Gear	Pinion	Gear	Pinion	Gear	Pinion	Gear	Pinion
6.00 x 20	6-8	1268 550	1268 551	1268 550	1268 552	561 816	571 654	561 651	571 653
6.50 x 20	6	1268 550	1268 551	1268 550	1268 552	561 816	571 654	561 651	571 653
6.50 x 16	6	561 816	571 653	561 816	571 654	561 651	571 653	-----	-----
7.00 x 16	6	1268 550	1268 552	561 816	571 653	561 816	571 655	-----	-----
7.50 x 16	6	1268 550	1268 552	561 816	571 654	561 816	571 656	561 651	571 655
7.50 x 16	8	1268 550	1268 552	561 816	571 653	561 816	571 656	-----	-----
8.25 x 16	8-10	1268 550	1268 552	1268 550	1268 552	561 816	571 654	561 651	571 653
9.00 x 16	8-10	-----	-----	-----	-----	561 816	571 654	561 651	571 653

CODE	PART NAME AND DESCRIPTION	SERIES NO.	MODEL CODES		PART NO.
			DU	EU	
SPEEDOMETER GEAR AND PINION - Cont'd					
21-85-27	SPACER, Gear (4 Speed)	-	1	1	1090 153
21-85-56	SEAL, Pinion (3 Speed)	-	1	1	1134 949
21-85-60	NUT, Pinion Retainer (4 Speed)	-	1	1	561 480
21-85-68	BUSHING, Drive Pinion (4 Speed)	-	1	1	516 268
21-85-76	SLEEVE, Pinion w/SEAL (3 Speed)	-	1	-	1139 156
	Pinion (4 Speed)	-	1	1	652 841

NOTES

GROUP 22 - WHEELS

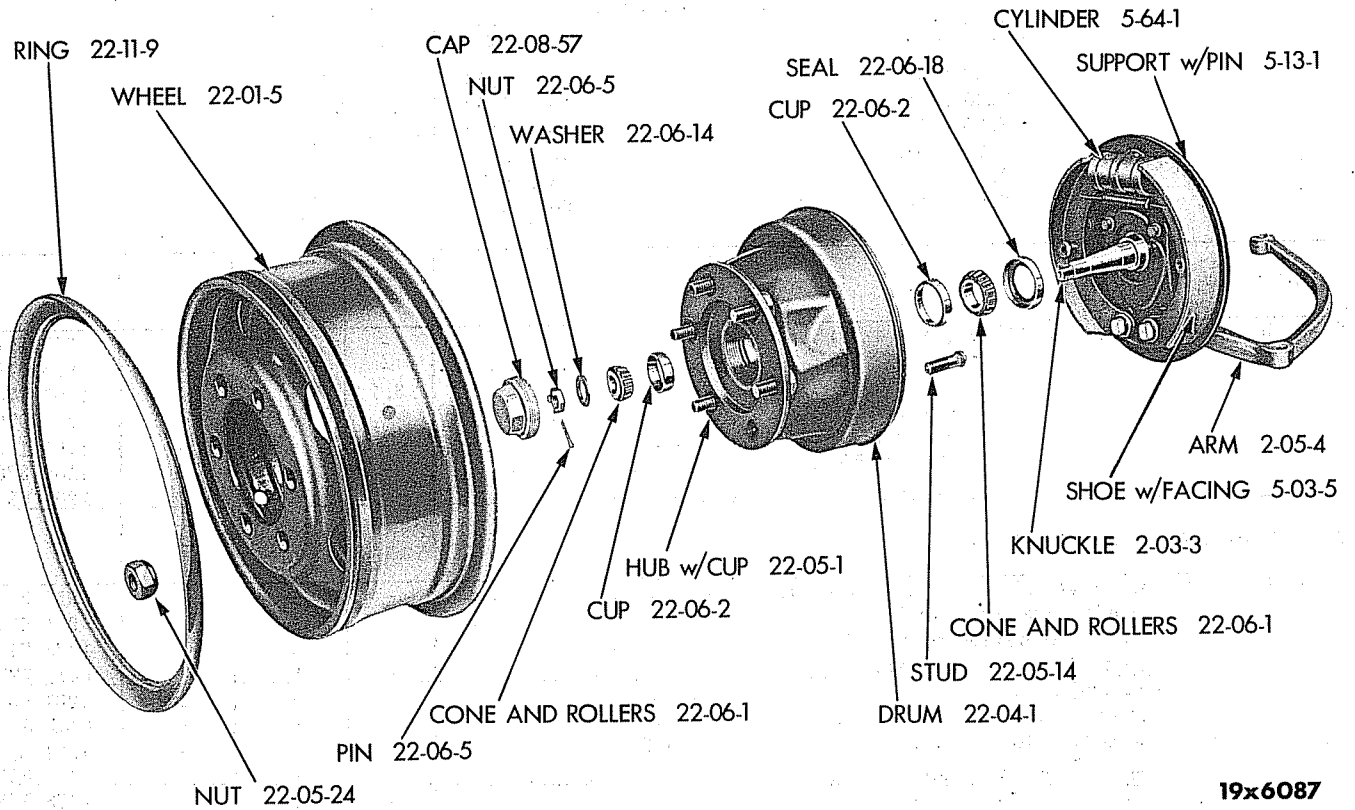

19x6087

Plate 22-1

FRONT WHEEL (EXPLODED VIEW)

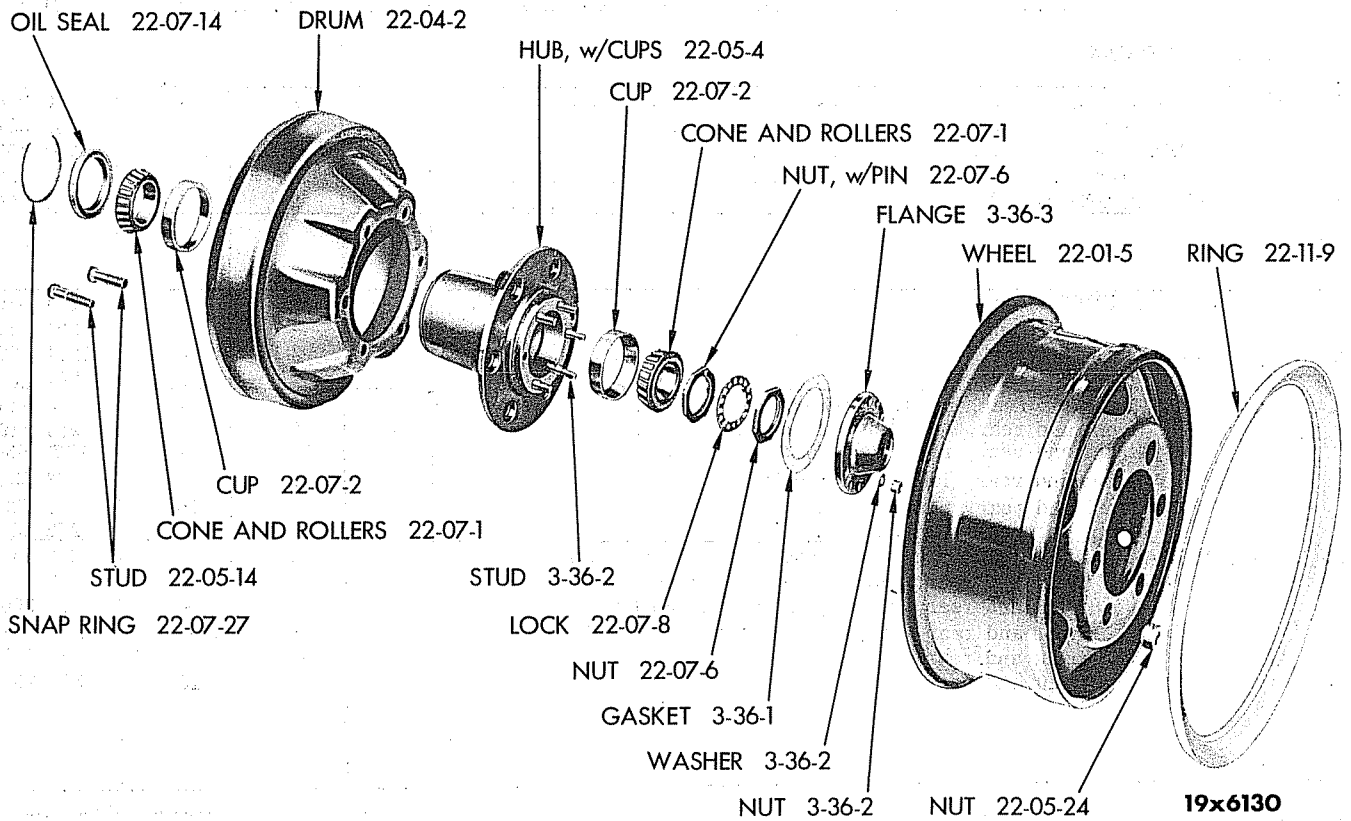

19x6130

Plate 22-2

REAR WHEEL (EXPLODED VIEW)

CODE	PART NAME AND DESCRIPTION	SERIES NO.	MODEL CODES		PART NO.
			DU	EU	

TIRE USAGE CHART

Tire Size	Rim Size
6.50 x 16	16 x 4.50
7.00 x 16	16 x 5.50, 16 x 6.00
7.50 x 16	16 x 5.50, 16 x 6.00
8.25 x 16	16 x 6.50
9.00 x 16	16 x 6.50
6.00 x 20	20 x 5

WHEELS

22-01-5	WHEEL, w/Side RING (16 x 4.50)	-	4	-	913 869
	(16 x 5.50)	-	4	-	915 619
	(16 x 6.00)	3, 4	4	-	1390 770
	(16 x 6.50)	-	4	-	1267 977
	(20 x 5)	-	4	-	1196 115
	(16 x 5.50)	-	-	4	1189 378
	(16 x 6.50)	-	-	4	1261 521

WHEEL HUB AND BRAKE DRUM

22-03-1	HUB, w/Brake DRUM (right front) (rivet type stud)	-	1	-	921 536
	(left front) (rivet type stud)	-	1	-	921 537
	(right front) (serrated type stud)	-	1	-	1273 774
	(left front) (serrated type stud)	-	1	-	1273 775
	(right front)	-	-	1	1261 552
	(left front)	-	-	1	1261 553
22-03-2	HUB, w/Brake DRUM (right rear) (rivet type stud)	-	1	-	1261 686
	(left rear) (rivet type stud)	-	1	-	1261 687
	(right rear) (serrated type stud)	-	1	-	1273 776
	(left rear) (serrated type stud)	-	1	-	1273 777
	(right rear)	-	-	1	1261 166
	(left rear)	-	-	1	1261 167

WHEEL BRAKE DRUM

22-04-1	DRUM (front)	-	2	-	916 946
	(front)	-	-	2	1261 551
22-04-2	DRUM (rear)	-	2	-	1194 455
	(rear)	-	-	2	1261 551
22-04-17	OIL SLINGER (rear)	-	2	2	1261 176

WHEEL HUB

22-05-1	HUB, w/CUPS (front)	-	2	-	921 535
	(front)	-	-	2	1261 554
22-05-4	HUB, w/CUPS (rear)	-	2	-	1261 688
	(rear)	-	-	2	1261 168
22-05-14	STUD (front and rear, right) (rivet type)	-	12	-	913 848
	(front and rear, left) (rivet type)	-	12	-	913 849
	(front and rear, right) (serrated type)	-	12	-	1273 554
	(front and rear, left) (serrated type)	-	12	-	1273 555
	(front and rear, right)	-	-	10	1272 772
	(front and rear, left)	-	-	10	1272 771
22-05-24	NUT, Stud (front and rear, right) (use w/rivet type stud)	-	12	-	913 812
	(front and rear, left) (use w/rivet type stud)	-	12	-	913 813
	(front and rear, right) (use w/serrated type stud)	-	12	-	1273 556
	(front and rear, left) (use w/serrated type stud)	-	12	-	1273 557
	(front and rear, right)	-	-	10	585 192
	(front and rear, left)	-	-	10	585 193

★ Indicates use as required.

☐ Indicates parts not listed in any previous parts books.

Series No. (1 indicates B-1 Series) (2 indicates B-2 Series) (3 indicates B-3 Series) (4 indicates B-4 Series)

Where no Series No. is shown part is for B-1, B-2, B-3 and B-4 Series.

March 30, 1953

Prices and specifications subject to change without notice.

Printed in U.S.A.

CODE	PART NAME AND DESCRIPTION	SERIES NO.	MODEL CODES		PART NO.
			DU	EU	
FRONT WHEEL BEARINGS					
22-06-1	CONE and ROLLERS (inner)	-	2	-	698 410
	(outer)	-	2	-	913 204
	(inner)	-	-	2	919 265
	(outer)	-	-	2	1262 533
22-06-2	CUP (inner)	-	2	-	698 394
	(outer)	-	2	-	913 203
	(inner)	-	-	2	919 266
	(outer)	-	-	2	698 401
22-06-5	NUT	-	2	-	921 518
	Pin, cotter	-	-	2	1263 313
	Pin, cotter	-	2	-	119 209
	Pin, cotter	-	-	2	103 399
22-06-14	WASHER, Thrust	-	2	-	600 194
		-	-	2	1262 540
22-06-18	SEAL, Dust	-	2	-	668 479
		-	-	2	919 277
REAR WHEEL BEARINGS					
22-07-1	CONE and Rollers (inner)	-	2	2	927 017
	(outer)	-	2	2	927 018
22-07-2	CUP (inner)	-	2	2	927 015
	(outer)	-	2	2	927 016
22-07-6	NUT, Adjusting (outer)	-	2	2	915 500
	w/PIN (inner)	-	2	2	915 395
22-07-8	LOCK, Adjusting Nut	-	2	2	915 397
22-07-14	OIL SEAL	-	2	2	915 499
22-07-27	SNAP RING, Oil Seal	-	2	2	915 498
HUB GREASE CAP					
22-08-57	CAP (front wheel)	-	2	2	564 052
WHEEL DISC RIM BASE SIDE RING					
22-11-9	RING (16 x 4.50 and 16 x 5.50)	-	4	-	913 871
	(16 x 6.00)	-	4	-	1390 774
	(16 x 6.50)	-	4	4	1189 383
	(20 x 5)	-	4	-	1194 544
SPARE WHEEL CARRIER					
<p>Note: Two types of Spare Wheel Carriers were used on Route Vans.</p> <p>Type 1 was used up to the following serial Nos.:</p> <p style="padding-left: 40px;">B-1-DU - 84204782</p> <p style="padding-left: 40px;">B-1-EU - 84000985</p> <p>Type 2 - See Part Type Code 22-48-18</p>					
22-21-2	CARRIER (type 1)	1	1	1	1199 626
	Bolt, 5/16"-18 x 1 1/2" (carrier to floor)	1	4	4	126 373
	Nut	1	4	4	120 376
	Screw or Bolt, 5/16"-24 x 3/4" (carrier to wheelhouse)	1	2	2	151 384
	Nut	1	2	2	120 368
22-21-3	STRAP (type 1)	1	1	1	1199 634
	Rivet	1	4	4	120 743
22-21-11	WASHER, Carrier to Wheelhouse Screw Lock	1	2	2	1097 771
22-21-12	WASHER, Carrier to Floor Bolt Lock	1	4	4	1097 771

★Indicates use as required.

Prices and specifications subject to change without notice.

☐Indicates parts not listed in any previous parts books.

Series No. (1 indicates B-1 Series) (2 indicates B-2 Series) (3 indicates B-3 Series) (4 indicates B-4 Series)

Where no Series No. is shown part is for B-1, B-2, B-3 and B-4 Series.

