

19x6031

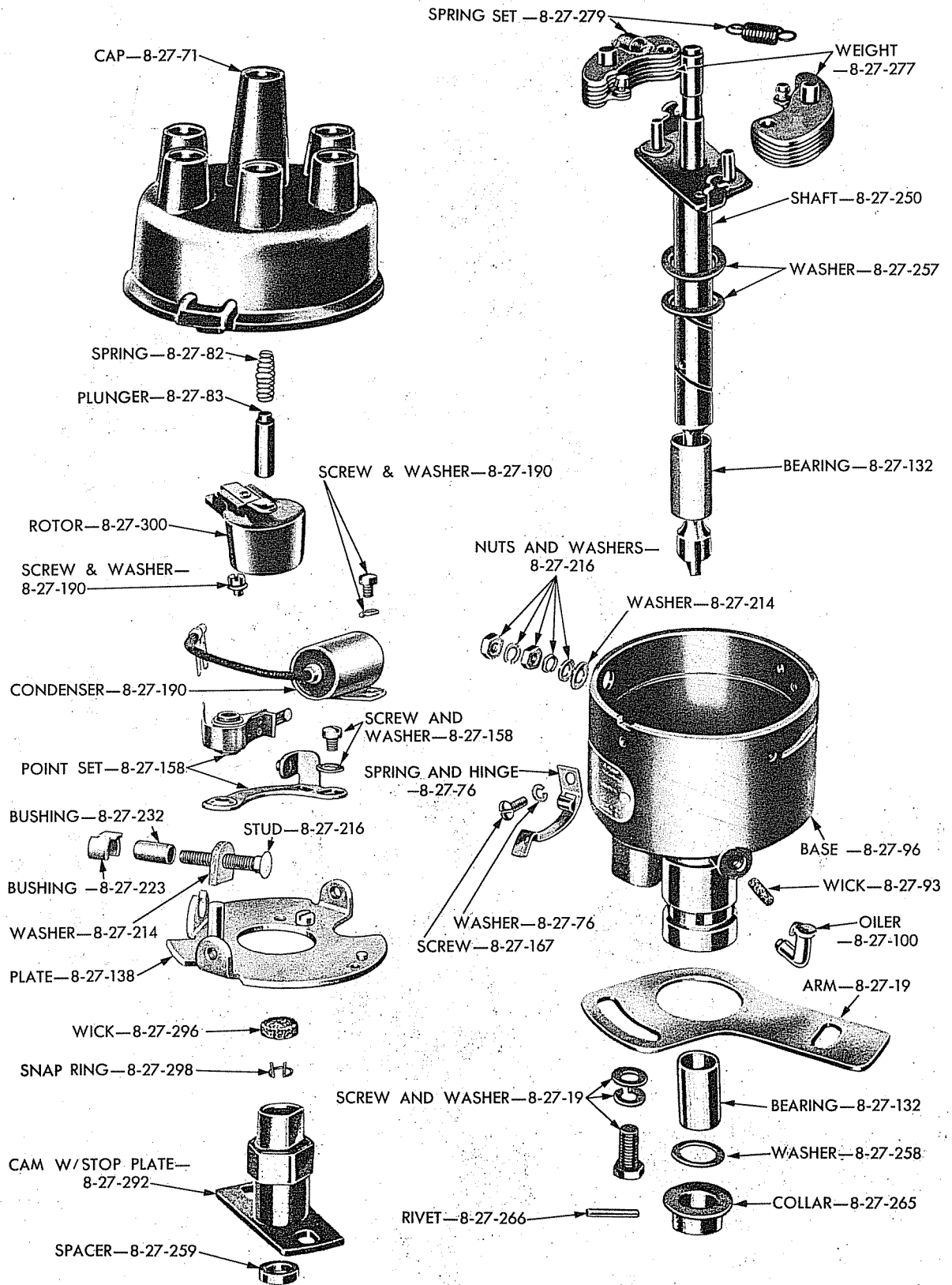

19x6100

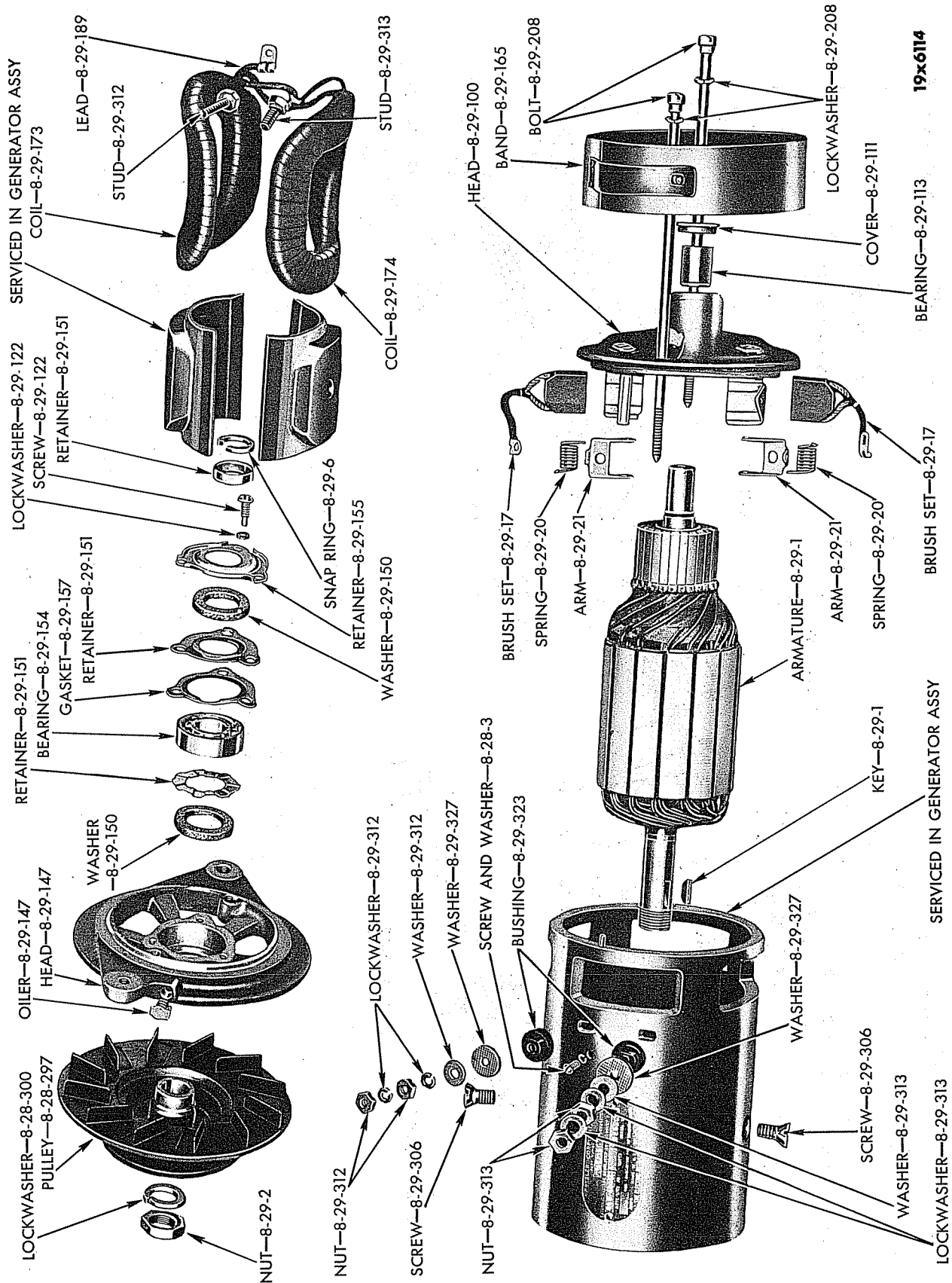

GENERATOR (AFTER TYPE)

Plate 8-5

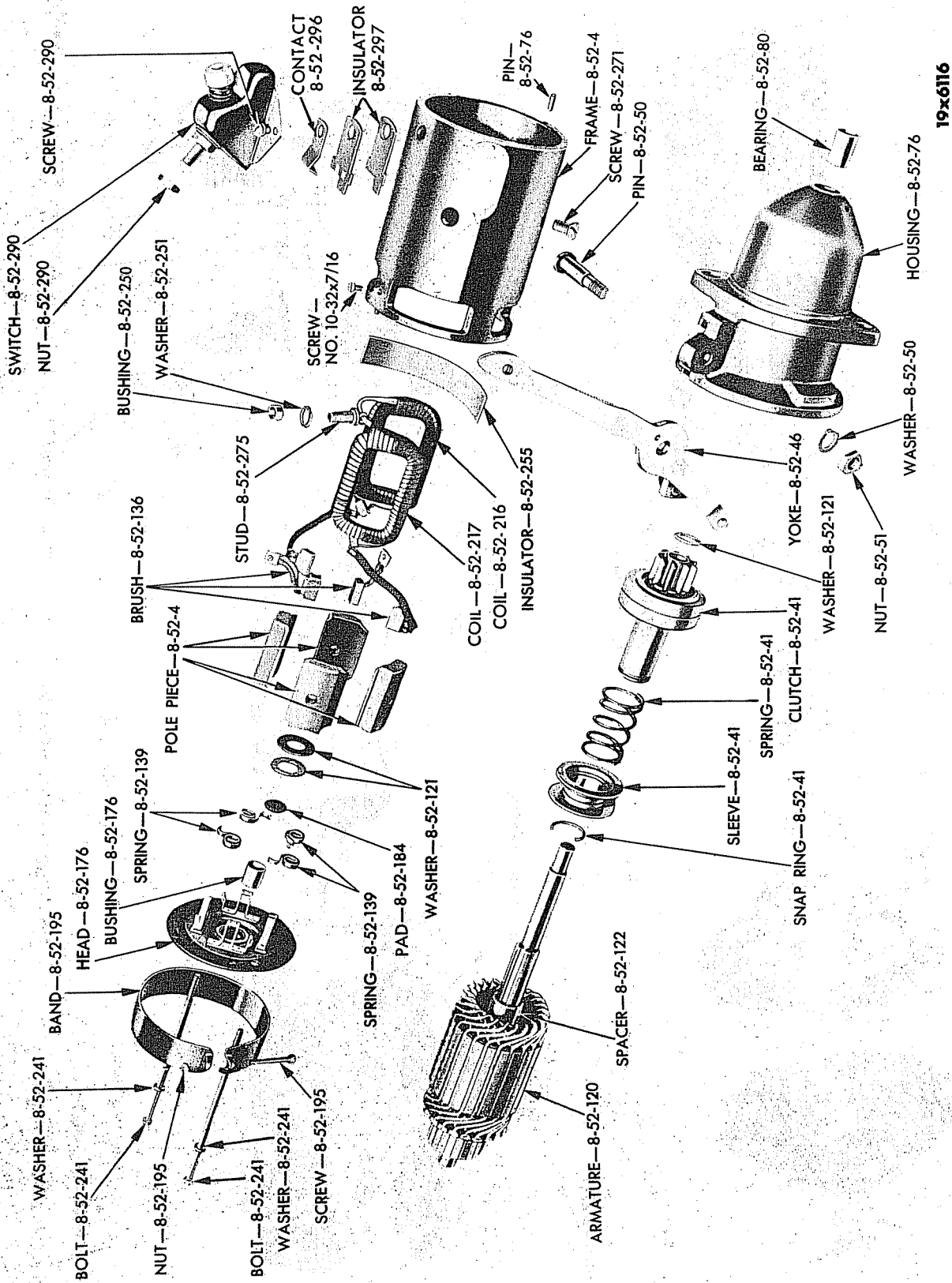

STARTER (UP-TO-TYPE)

Plate 8-6

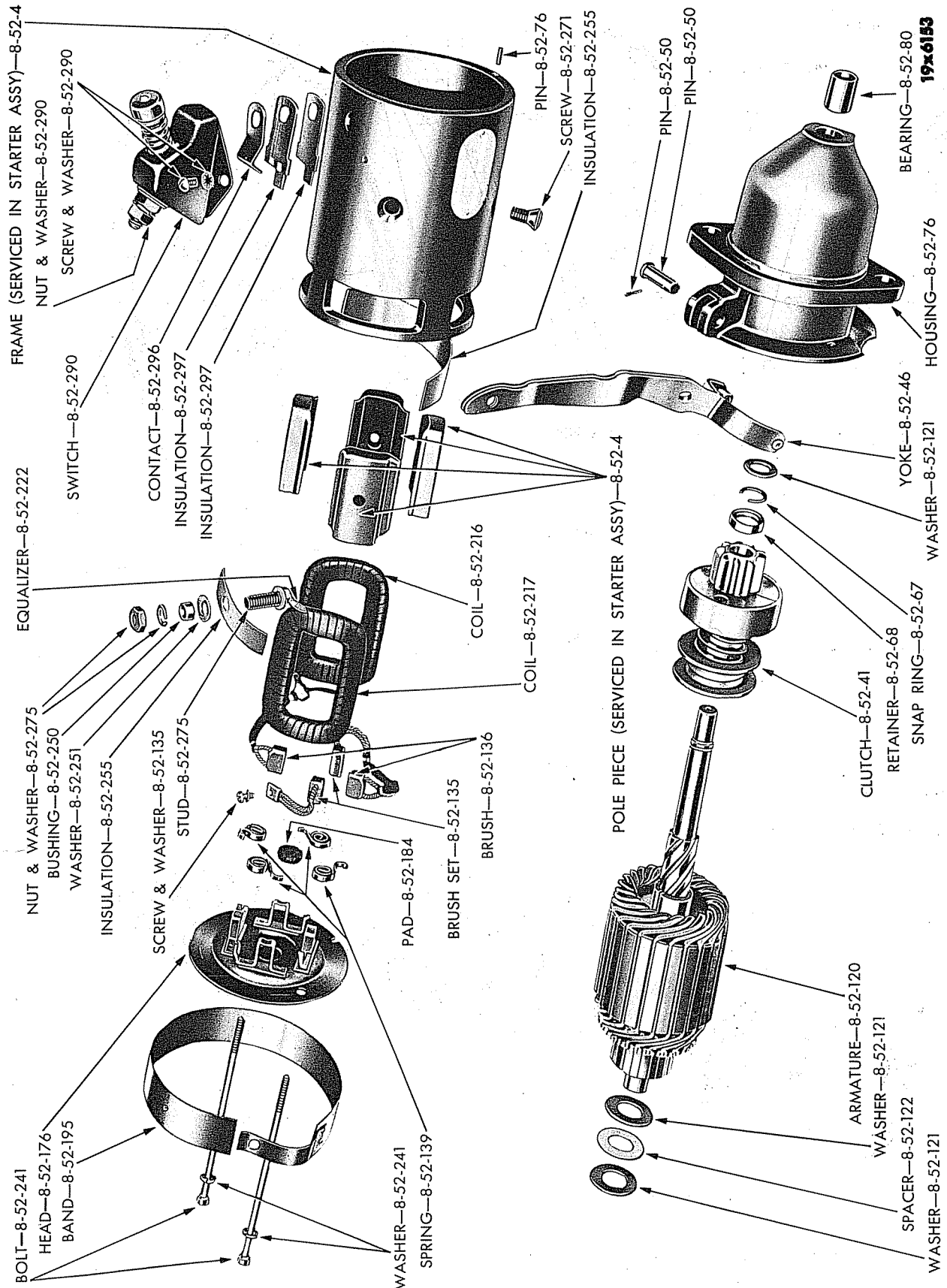

STARTER (AFTER TYPE)

Plate 8-7

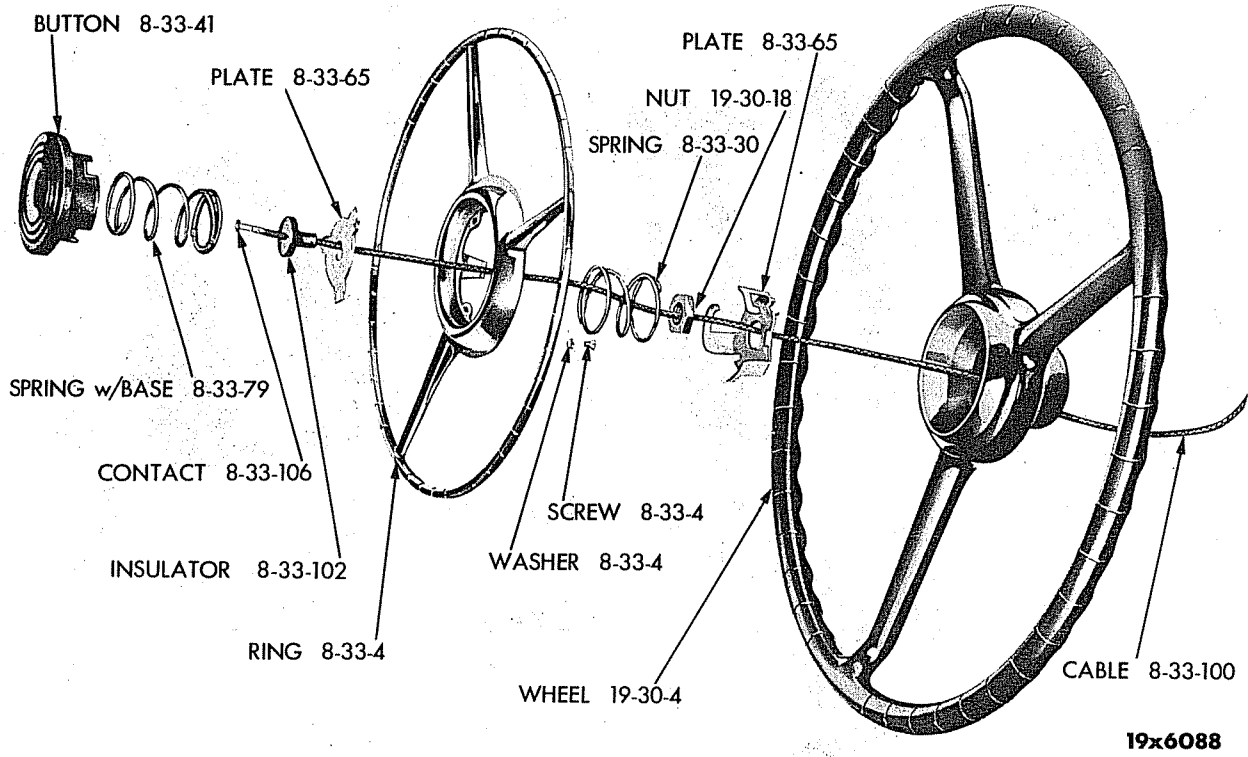

Plate 8-8

HORN CONTROL

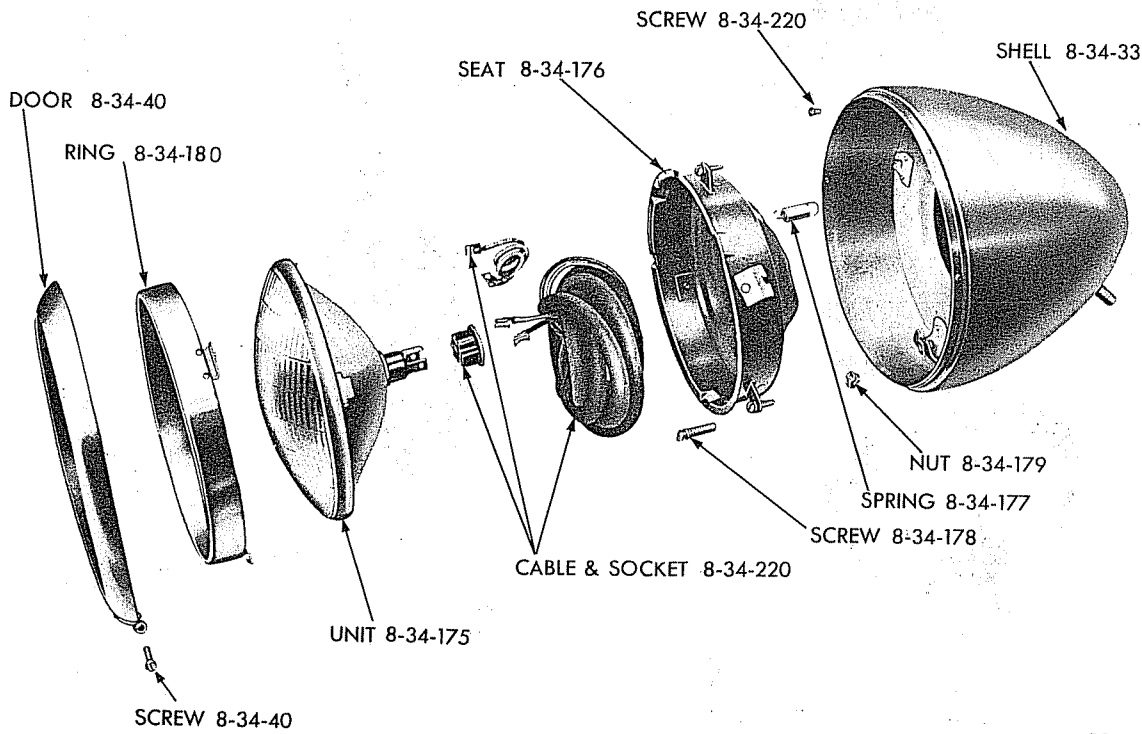

Plate 8-9

HEADLAMP

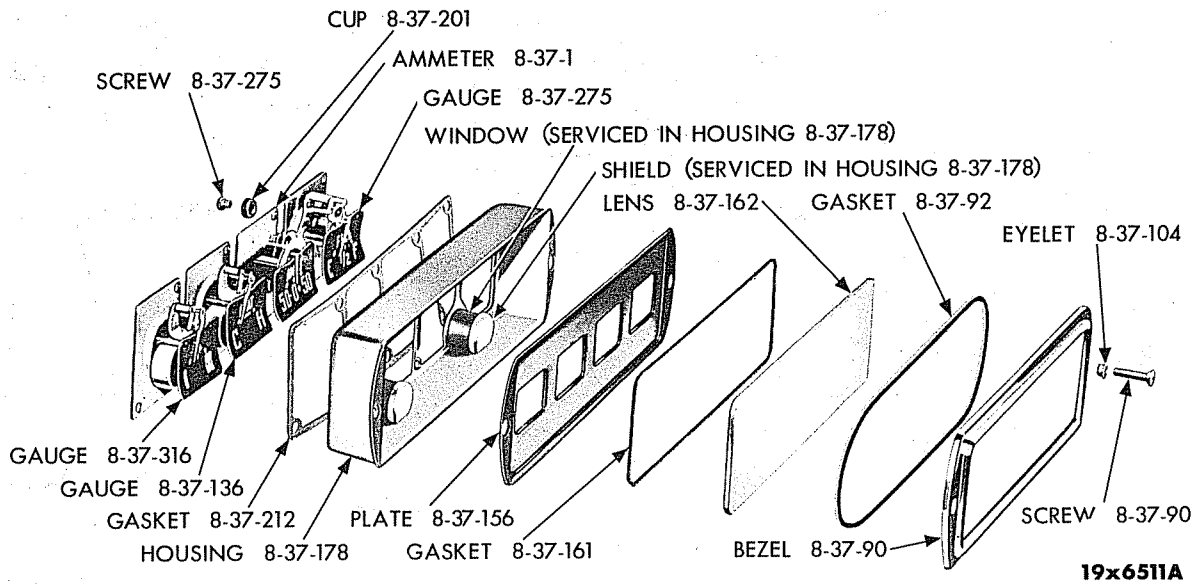

Plate 8-10

INSTRUMENT CLUSTER

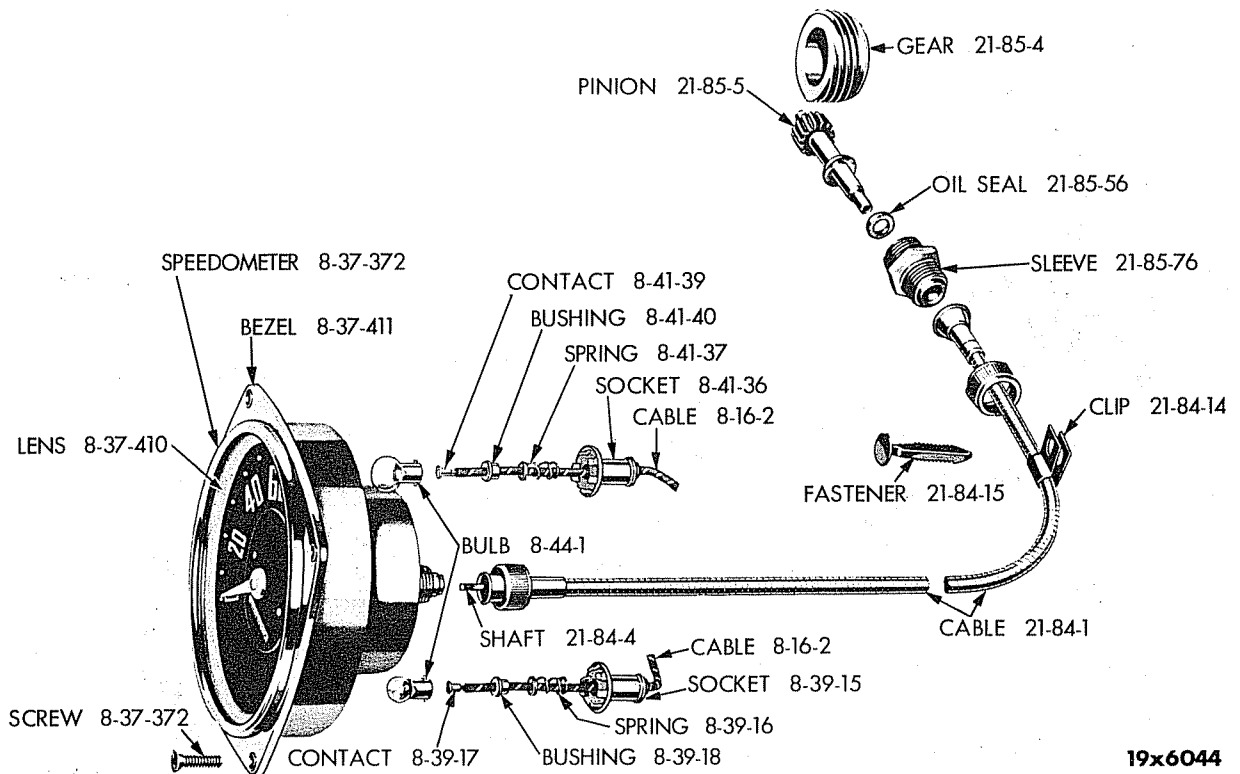
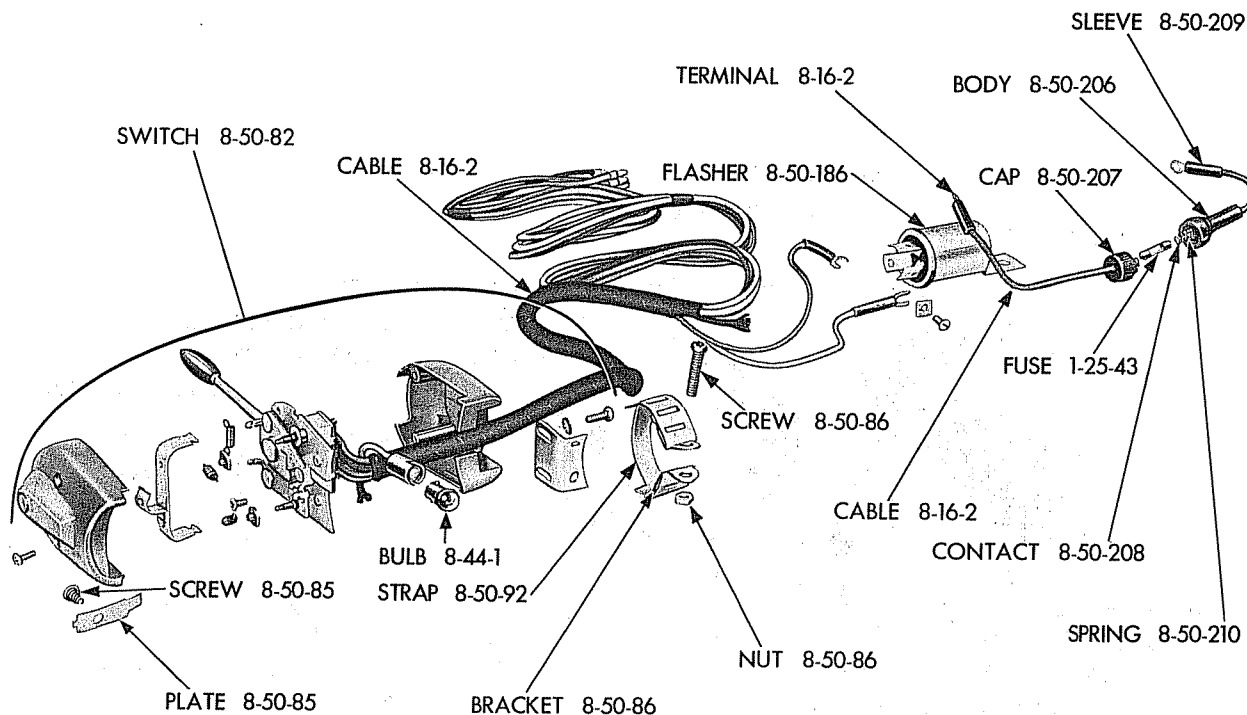

Plate 8-11

SPEEDOMETER AND CABLE



19x6002A

Plate 8-12

DIRECTIONAL SIGNAL LAMP SWITCH (SELF-CANCELLING TYPE)

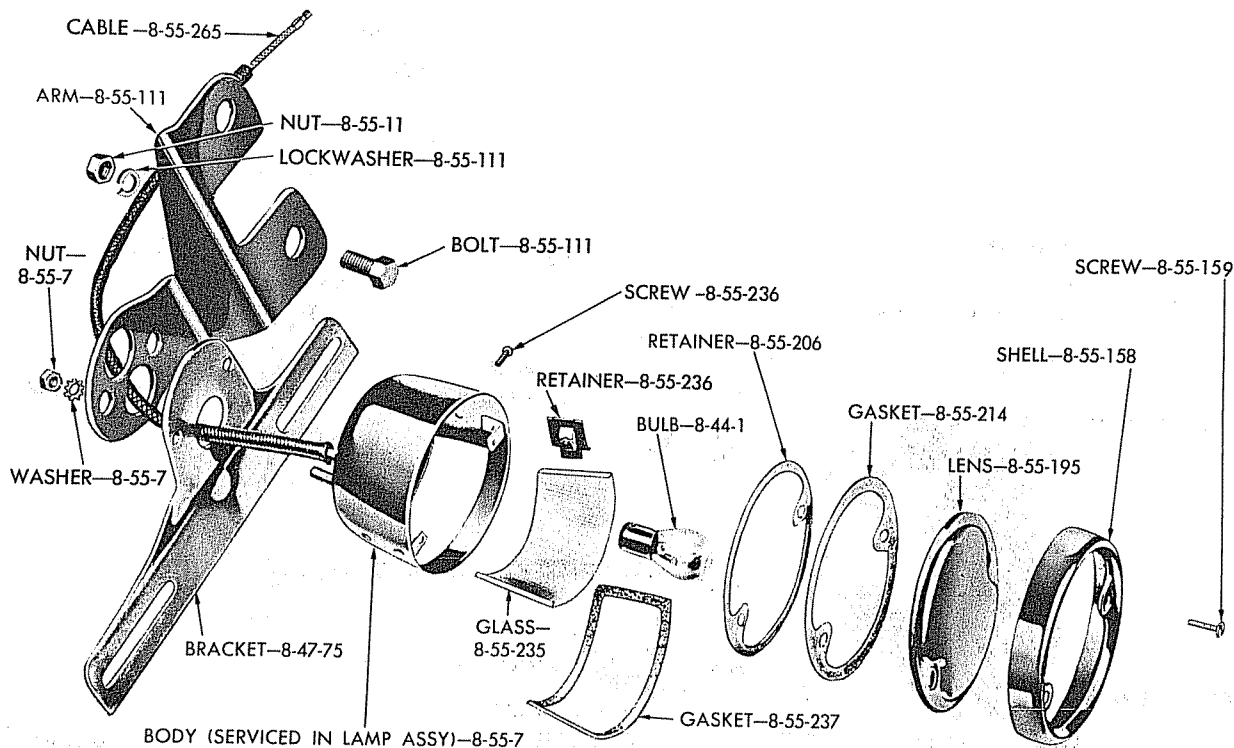

19x6096

Plate 8-13

TAIL LAMP

CODE	PART NAME AND DESCRIPTION	B SERIES NO.	C SERIES NO.	MODEL CODES		PART NO.
				WDX	PW	
8-01-0 BATTERY CABLES						
8-01-4	CABLE, Ground, w/TERMINALS (16" lgh.) 6 Volt	-	1, 3	1	1	* 687 780
	(16" lgh.) 12 Volt		3		1	⊠1658 900
8-01-11	BOLT, Ground Cable Clamp Terminal	-	-		1	*1622 535
8-01-12	NUT, Ground Cable Bolt	-	-	1	1	* 663 220
	NUT, Ground Cable Clamp Terminal	-	3		1	⊠1622 536
8-01-15	WASHER, Ground Cable Terminal Felt	-	-	1	1	* 687 975
8-01-17	CABLE, Starter, w/TERMINALS (17" lgh.) 6 Volt	-	-	1	1	*1407 564
	(17" lgh.) 12 Volt		3		1	⊠1660 910
8-01-20	BOLT, Cable Clamp Terminal	-	-		1	*1622 535
8-01-21	NUT, Starter Cable Terminal Bolt	-	-	1	1	* 663 220
	NUT, Cable Clamp Terminal		3		1	⊠1622 536
8-05-0 DOME LAMP AND SWITCH						
8-05-6	BASE (UP TO Ser. No. 83902667)	-	1	1	1	* 763 057
	(FROM Ser. No. 83902667 to 83904151)	-	1		1	*1189 593
	(AFTER Ser. No. 83904151)	-	-		1	*1193 291
8-05-8	BEZEL, w/LENS (AFTER Ser. No. 83904151)	-	-		1	*1193 288
	Screw, No. 10-12 x 1/2" (terminal)	-	-		1	* 125 591
	Screw, No. 4-24 x 3/4"	-	-		1	* 169 248
	Nut (terminal)	-	-		1	* 151 497
	Washer, lock	-	-		1	* 138 479
8-05-14	SWITCH (UP TO Ser. No. 83902667)	-	1	1	1	* 317 180
	(FROM Ser. No. 83902667 to 83904151)	-	1		1	*1189 594
	w/SOCKET	-	-		1	*1193 292
8-05-20	PLATE, Switch (AFTER Ser. No. 83904151)	-	-		1	* 981 373
	Washer, lock	-	-		1	* 138 468
	Washer, plain	-	-		1	* 131 014
8-15-0 CHASSIS AND BODY WIRING						
8-15-2	WIRING, Chassis (UP TO Ser. No. 83922966 Det. -	1, 2	-	1	1	*1267 365
	88766605 S.L.) 6 Volt	3, 4	1, 3		1	*1271 408
	(AFTER Ser. No. 83922966 Det. - 88766605 S.L.) . 6 Volt		3		1	⊠1569 202
	12 Volt					
8-15-4	WIRING, Body (UP TO Ser. No. 83922966 Det. -	-	-	1	1	*1189 151
	88766605 S.L.) (w/853 770, 1257 392, 1194 650 and	-	-	1	1	*1266 977
	1264 054 generators)	-	-	1	1	*1302 783
	(w/1136 934 and 1136 931 generators)	-	-	★	★	*1302 783
8-15-32	CLIP, Instrument Panel Wiring	-	-	★	★	* 641 400
	Chassis Wiring	-	-	★	★	* 121 832
	Headlamp Cable	-	-	★	★	* 121 841
	Screw, No. 8-32 x 3/8"	-	-	★	★	
	Washer, lock	-	-	★	★	
8-16-0 CHASSIS WIRING CABLE AND CONNECTIONS						
8-16-2	CABLE (specify by the inch) (No. 10 cable, black braid) . .	-	-	★	★	* 665 140
	(specify by the inch) (No. 12 cable, red braid)	-	-	★	★	* 385 571
	(specify by the inch) (No. 14 cable, green braid) . . .	-	-	★	★	* 385 573
	(specify by the inch) (No. 16 cable, blue braid) . . .	-	-	★	★	* 211 318
	Horn (specify by the inch) (No. 16 cable)	-	-	★	★	* 868 127
	Terminal	-	-	★	★	* 200 394
		-	-	★	★	* 200 286
		-	-	★	★	* 200 156
		-	-	★	★	* 200 052
		-	-	★	★	* 200 019

NOTE: For a more practical and economical method of servicing car wiring, only the more complicated assemblies will be stocked for service. These will be found listed in their respective groups. On the more simple assemblies the required length and size of cable, terminals, etc., should be ordered.

8-16-2	CABLE (specify by the inch) (No. 10 cable, black braid) . .	-	-	★	★	* 665 140
	(specify by the inch) (No. 12 cable, red braid)	-	-	★	★	* 385 571
	(specify by the inch) (No. 14 cable, green braid) . . .	-	-	★	★	* 385 573
	(specify by the inch) (No. 16 cable, blue braid) . . .	-	-	★	★	* 211 318
	Horn (specify by the inch) (No. 16 cable)	-	-	★	★	* 868 127
	Terminal	-	-	★	★	* 200 394
		-	-	★	★	* 200 286
		-	-	★	★	* 200 156
		-	-	★	★	* 200 052
		-	-	★	★	* 200 019

★ Indicates use as required
 ⊠ Indicates parts not listed in any previous parts books.
 Series No. (1 indicates B-1 Series) (2 indicates B-2 Series) (3 indicates B-3 Series) (4 indicates B-4 Series)
 Series No. (1 indicates C-1 Series) (3 indicates C-3 Series)
 Where dash (-) is shown in Series Column Part is for All.
 Prices and specifications subject to change without notice.
 * Indicates change or addition.
 Printed in U.S.A.
 April 30, 1956 Supersedes Jan. 30, 1953.
 Page 8-11

POWER WAGON PARTS LIST

ELECTRICAL

CODE	PART NAME AND DESCRIPTION	B SERIES NO.	C SERIES NO.	MODEL CODES		PART NO.
				WDX	PW	
8-16-0 CHASSIS WIRING CABLE AND CONNECTIONS - Cont'd						
8-16-3	CABLE (100 ft. spool) (No. 10, black braid)	-	-	★	★	* 830 814
	(100 ft. spool) (No. 12, red braid)	-	-	★	★	* 830 813
	(100 ft. spool) (No. 14, green braid)	-	-	★	★	* 830 812
	(100 ft. spool) (No. 16, blue braid)	-	-	★	★	* 830 810
	Horn (100 ft. spool) (No. 16 cable)	-	-	★	★	1064 754
8-16-4	TERMINAL	-	-	★	★	870 821
		-	-	★	★	665 151
8-16-5	SLEEVE, Terminal	-	-	★	★	930 304
		-	-	★	★	1264 933
8-16-8	CONNECTOR (single)	-	-	★	★	611 898
	(triple)	-	-	1	1	657 560
8-21-0 HEADLAMP CABLE TERMINAL BLOCK						
8-21-1	BLOCK, Headlamp Terminal	-	-	2	2	683 995
8-27-0 DISTRIBUTOR ASSEMBLY						
8-27-1	DISTRIBUTOR (UP TO Engine No. T137-18518)	-	-	1	1	* 930 367
	(AFTER Engine No. T137-18518)	-	1		1	*1274 066
		-	3		1	*1507 456
CODE	DISTRIBUTOR		1507 456		930 367	1274 066
Note: All quantities are one (1) unless otherwise indicated in parenthesis.						
8-27-4	RETAINER, Oil		* 41 928		41 928	41 928
8-27-19	ARM, Advance		866 069		---	866 069
	Screw or Bolt, 1/4"-20 x 5/8"		180 018		---	180 018
	Washer, lock		131 098		---	131 098
	Washer, plain		120 392		---	120 392
8-27-33	POINTER, Advance Arm		1323 934		---	1323 934
8-27-71	CAP		1343 576		643 822	1343 576
8-27-75	PLUG, Cap Vent Hole (rubber)		---		648 246	---
8-27-76	SPRING and HINGE (2)		648 404		---	---
8-27-82	SPRING, Cap Contact Plunger		1308 183		1308 183	1308 183
8-27-83	PLUNGER, Cap Contact		1195 772		643 896	1195 772
8-27-93	WICK, Felt Base		958 177		958 177	958 177
8-27-96	BASE		1390 531		1089 087	1274 091
8-27-100	OILER, Base		953 717		953 717	953 717
8-27-132	BEARING, Absorbent Bronze (2)		643 906		643 906	643 906
8-27-138	PLATE, Breaker, Assembly		---		1089 082	---
	PLATE, Breaker		1274 090		1089 083	1274 090
	Screw, No. 10-32 x 3/8" (2)		---		132 105	---
	Screw, No. 8-32 x 3/8" (2)		121 832		---	121 832
	Washer, lock (2)		120 217		138 479	121 841
8-27-158	POINT SET, Breaker Contact		1274 092		592 477	1274 092
	Screw, No. 8-32 x 3/16"		131 949		---	131 949
	Washer, plain		131 015		131 015	131 015
8-27-160	SPRING, Breaker Arm		---		643 912	---
8-27-161	CLIP, Contact Arm Spring		---		643 989	---
8-27-167	SCREW, Spring Clamp		---		1089 084	---
8-27-190	CONDENSER		1274 086		921 274	1274 086
	Screw, No. 6-32 x 1/8"		131 870		131 870	131 870
	Washer, lock		131 044		131 044	131 044
8-27-194	WASHER, Condenser and Clamp Screw Lock		1089 583		---	---
8-27-214	WASHER, Terminal Stud Insulation		1369 774		---	1369 774
8-27-216	STUD, Terminal		1274 093		11407 579	1274 093
	Nut (2)		120 614		120 614	120 614

★ Indicates use as required

Ⓜ Indicates parts not listed in any previous parts books.

Series No. (1 indicates B-1 Series) (2 indicates B-2 Series) (3 indicates B-3 Series) (4 indicates B-4 Series)

Series No. (1 indicates C-1 Series) (3 indicates C-3 Series)

Where dash (-) is shown in Series Column Part is for All.

Prices and specifications subject to change without notice.

* Indicates change or addition.

Printed in U.S.A.

8-27-O DISTRIBUTOR ASSEMBLY - Cont'd

Note: All quantities are one (1) unless otherwise indicated in parenthesis.

CODE	DISTRIBUTOR - Cont'd.	1507 456	930 637	1274 066
8-27-221	WASHER, Terminal Insulating	----	960 548	----
8-27-223	BUSHING, Terminal Stud Insulating	1274 089	1089 090	1274 089
8-27-226	INSULATION, Terminal	1274 088	1089 089	1274 088
8-27-227	CONNECTOR, Terminal Stud	----	1089 088	----
8-27-230	WASHER, Connector Screw Lock	----	1089 583	----
8-27-232	BUSHING, Terminal Insulation	1274 087	----	1274 087
8-27-245	PLATE, Seal, Assembly	----	1089 085	----
8-27-246	WASHER, Felt	----	1089 086	----
8-27-250	SHAFT, Drive	1390 532	599 633	1390 532
8-27-257	WASHER, Shaft Upper Thrust (inner)	1195 769	860 939	1195 769
	WASHER, Shaft Upper Thrust (outer)	1195 770	----	1195 770
8-27-258	WASHER, Shaft Lower Thrust	643 892	643 893	643 892
8-27-259	SPACER, Cam	859 903	859 903	859 903
8-27-265	COLLAR, Drive Shaft	643 903	643 903	643 903
8-27-266	RIVET, Drive Shaft Collar	636 899	636 899	636 899
8-27-277	WEIGHT, Governor (2)	1271 768	1271 768	1271 768
8-27-279	SPRING SET, Governor Weight (consists of 2 springs)	1527 976	852 026	1308 182
8-27-292	CAM, w/Stop PLATE	1138 512	1089 081	921 275
8-27-296	FELT, Cam Sleeve	643 899	643 899	643 899
8-27-298	SNAP RING, Cam Retaining	643 893	643 893	643 893
8-27-300	ROTOR	1343 587	868 095	1343 587

CODE	PART NAME AND DESCRIPTION	B SERIES NO.	C SERIES NO.	MODEL CODES		PART NO.
				WDX	PW	
8-28-O GENERATOR ASSEMBLY						
8-28-3	GENERATOR (UP TO Engine No. T137-16311)(6 volt, 35 amperes)	-	-	1	1	853 770
	(AFTER Engine No. T137-16311)(6 volt, 45 amperes)	-	-	1	1	1257 392
	(UP TO Ser. No. 83921061)(6 volt, 32 amperes)	1, 2	-	1	1	1194 650
	(AFTER Ser. No. 83921061) (6 volt, 35 amperes)	2, 3	-	-	1	*1264 054
	(6 volt, 55 amperes)	-	-	1	1	1136 931
	(6 volt, 50 amperes)	-	-	1	1	1136 934
	(12 volt 30 amperes)	-	3	-	1	1642 002
	(12 volt 40 amperes-low speed cut-in)	-	3	-	1	1663 097
8-28-15	STRAP, Adjusting	-	-	-	-	-
	(w/853 770 generator)	-	-	1	1	622 783
	(w/1257 392, 1136 931, 1136 934 and 1642 002 generators)	-	-	1	1	*1270 658
	(w/1194 650 and 1264 054 generators)	-	-	1	1	582 589
	Screw or Bolt, 5/16"-18 x 1"	-	-	1	1	* 180 079
	Washer, lock	-	-	1	1	120 214
	Washer, plain	-	-	1	1	120 387
8-28-19	SCREW, w/WASHER	-	-	1	1	*1343 212
8-28-36	BRACKET (w/853 770, 1257 392, 1136 934 and 1642 002 generators)	-	-	1	1	*1188 601
	(w/1136 931 generator)	-	-	1	1	1117 247
	(w/1194 650 and 1264 054 generators)	-	-	1	1	1191 891
	(w/1663 097 generator)	-	3	-	1	*1117 247
	Screw or Bolt, 7/16"-14 x 1"	-	-	1	1	* 180 145
	Washer, lock	-	-	2	2	120 383

★ Indicates use as required

□ Indicates parts not listed in any previous parts books.

Series No. (1 indicates B-1 Series) (2 indicates B-2 Series) (3 indicates B-3 Series) (4 indicates B-4 Series)

Series No. (1 indicates C-1 Series) (3 indicates C-3 Series)

Where dash (-) is shown in Series Column Part is for All.

Prices and specifications subject to change without notice.

* Indicates change or addition.

Printed in U.S.A.

April 30, 1956 Supersedes June 15, 1954.

POWER WAGON PARTS LIST

ELECTRICAL

CODE	PART NAME AND DESCRIPTION	B SERIES NO.	C SERIES NO.	MODEL CODES		PART NO.	
				WDX	PW		
8-28-0 GENERATOR ASSEMBLY - Cont'd							
8-28-37	SCREW, Bracket Ground Terminal	-	-	1	1	866 890	
8-28-74	REGULATOR (w/853 770 generator)	-	-	1	1	E1571 161	
	(w/1257 392 generator)	-	-	1	1	E1641 510	
	(w/1264 054 generator)	-	-	1	1	1268 222	
	(w/1136 934 generator)	-	-	1	1	E1627 012	
	(w/1136 931 generator)	-	-	1	1	1343 122	
	(w/1194 650 generator)	-	-	1	1	1195 738	
	(w/1642 002 generator)	-	3	1	1	E1642 333	
	(w/1663 097 generator)	-	3	1	1	E1662 137	
	Screw or Bolt, 1/4"-20 x 5/8" (mounting)	-	-	3	3	180 018	
	Screw, No. 10-32 x 3/8" (terminal)	-	-	3	3	* 132 900	
8-28-83	RESISTOR, Regulator (38 ohms)	-	-	1	1	* 853 748	
	(7 ohms)	-	-	1	1	* 685 817	
8-28-88	CLAMP, Regulator Terminal Screw	-	-	1	1	*1092 826	
8-28-297	PULLEY (w/853 770 generator, UP TO Engine No. T137-3337), (w/853 770 generator, FROM Engine No. T137-3337 to T137-16311)	-	-	1	1	*1136 924	
	(w/1257 392 generator)	-	-	1	1	* 678 495	
	(w/1264 054 generator)	-	-	1	1	*1297 974	
	(w/1136 934 generator)	-	-	1	1	*1136 935	
	(w/1194 650 generator)	-	-	1	1	*1263 560	
	(w/1136 931-1663 097 generators)	-	-	1	1	*1194 651 *1126 616	
CODE	GENERATOR	1194 650	1257 392	853 770	1136 934	1136 931	1264 054

Note: All quantities are one (1) unless otherwise indicated in parenthesis.

8-29-0 GENERATOR COMPONENT PARTS

8-29-1	ARMATURE	860 922	1266 499	859 900	1253 360	E1627 214	1268 129
	Key, Woodruff	106 750	* 124 545	* 124 545	* 124 545	* 124 545	106 750
8-29-2	NUT, Armature Shaft	40 654	40 654	40 654	40 654	40 654	40 654
8-29-6	SNAP RING, Armature	---	648 392	648 392	648 392	---	648 392
8-29-17	BRUSH SET	677 175	1253 367	1253 367	1253 367	---	1253 367
8-29-18	BRUSH (2)	---	---	---	---	---	---
8-29-20	SPRING, Brush (2)	674 935	1345 517	671 490	671 490	960 173	671 490
8-29-21	ARM, Brush (2)	674 936	673 014	673 014	673 014	674 936	673 014
8-29-100	HEAD, Commutator End, Assembly	1261 932	1384 081	---	*1495 542	1339 617	*1495 542
	HEAD, Commutator End, Partial, Assembly	---	*1384 081	860 491	1253 358	---	1253 358
8-29-104	WICK, Commutator End Felt	---	---	636 796	---	---	---
8-29-105	COVER, Commutator End Felt Washer	---	---	636 800	---	---	---
8-29-106	WASHER, Commutator End Felt Retaining	674 928	---	674 928	---	---	---
8-29-111	COVER, Commutator End	---	---	695 626	1253 356	---	1253 356
	Screw, No. 8-32 x 5/16" (3)	---	---	131 958	131 958	---	131 958
	Screw, No. 10-32 x 3/8" (3)	132 105	132 105	---	---	---	---
	Screw, No. 10-32 x 1" (3)	---	---	---	---	132 133	---
	Washer, lock (3)	---	---	121 841	121 841	---	121 841
	Washer, lock (3)	120 217	120 217	---	---	120 217	---
8-29-112	GASKET, Commutator End Cover	674 931	---	695 627	1253 355	960 170	1253 355

★ Indicates use as required

E Indicates parts not listed in any previous parts books.

Series No. (1 indicates B-1 Series) (2 indicates B-2 Series) (3 indicates B-3 Series) (4 indicates B-4 Series)

Series No. (1 indicates C-1 Series) (3 indicates C-3 Series)

Where dash (-) is shown in Series Column Part is for All.

Prices and specifications subject to change without notice.

* Indicates change or addition.

Printed in U.S.A.

April 30, 1956 Supersedes Jan. 30, 1953.

8-29-0 GENERATOR COMPONENT PARTS - Cont'd

Note: All quantities are one (1) unless otherwise indicated in parenthesis.

CODE	GENERATOR - Cont'd	1194 650	1257 392	853 770	1136 934	1136 931	1264 054
8-29-113	BEARING, Commutator End . . .	602 454	*1402 563	636 804	*1402 563	1202 829	*1402 563
8-29-122	SCREW, Drive End Bearing Retainer (3)	1269 238	1269 238	1269 238	1269 238	1269 238	----
	SCREW, Commutator End Bearing Retainer (★)	----	1269 238	----	----	----	----
	Washer, lock	131 098	----	----	----	131 098	----
	Washer, lock (drive end) (3)	120 217	120 217	120 217	120 217	120 217	120 217
8-29-127	WASHER, Commutator End Bearing Retainer	674 927	----	----	----	674 927	----
8-29-146	HEAD, Drive End, Assembly	594 372	1266 500	860 492	1253 361	1253 338	----
8-29-147	HEAD, Drive End	594 373	----	----	----	----	----
	Oiler	113 702	113 702	113 702	113 702	113 702	113 702
8-29-150	WASHER, Drive End Felt (2)	----	636 815	636 815	636 815	----	636 815
8-29-151	RETAINER, Drive End Felt Washer	----	636 810	636 810	636 810	1253 340	636 810
	RETAINER, Drive End Felt Washer Outer	674 942	1253 365	----	1253 365	----	1253 365
8-29-154	BEARING, Drive End Ball	602 454	602 454	602 454	602 454	965 325	602 454
8-29-155	RETAINER, Drive End Bearing	----	----	636 813	----	----	----
8-29-157	GASKET, Drive End Bearing Retainer	----	1253 362	----	1253 362	----	1253 362
8-29-165	BAND, Cover	674 944	1266 502	673 031	674 944	1136 568	674 944
	Screw, No. 10-32 x 1 1/2"	132 930	132 930	132 930	132 930	132 930	132 930
	Nut	120 614	120 614	120 614	120 614	120 614	120 614
8-29-172	COIL, Field, Assembly	860 919	----	858 269	----	----	----
8-29-173	COIL, Field, Right	1189 547	1266 493	858 271	1253 352	1253 331	1253 352
8-29-174	COIL, Field, Left	916 592	1266 527	858 270	1253 351	1253 329	1253 351
8-29-186	INSULATION, Field Connection	1069 981	----	----	1069 981	----	----
8-29-189	LEAD, Field Coil	----	1253 350	----	1253 350	1253 330	1253 350
8-29-190	TERMINAL, Lead	1383 661	1383 661	1383 661	1383 661	----	1383 661
8-29-208	BOLT, Thru (2)	1253 343	673 009	671 487	1253 343	1253 327	1253 343
	Washer, lock (2)	120 214	131 098	131 098	120 214	120 382	120 214
8-29-306	SCREW, Pole Shoe (2)	674 919	859 901	859 901	674 919	674 919	674 919
8-29-312	STUD, Armature Terminal	----	1253 349	859 897	1253 349	----	1253 349
	Nut (2)	120 367	120 367	120 367	120 367	120 367	120 367
	Washer, lock (2)	120 380	120 380	120 380	120 380	120 280	120 380
	Washer, plain	120 387	120 387	120 387	120 387	120 387	120 387
8-29-313	STUD, Field Terminal	953 732	1253 348	677 153	1253 348	953 732	1253 348
	Nut (2)	120 614	120 614	120 614	120 614	120 614	120 614
	Washer, lock (2)	120 217	120 217	120 217	120 217	120 217	120 217
	Washer, plain	* 120 385	* 120 385	* 120 385	* 120 385	* 120 385	* 120 385
8-29-314	NUT, Armature Terminal (2)	43 761	43 761	43 761	43 761	43 761	----
8-29-319	WASHER, Field Terminal	----	1253 345	----	1253 345	----	1253 345
8-29-320	INSULATION, Armature Terminal Inner	688 015	----	----	----	----	----
	INSULATION, Field Terminal Inner	688 016	----	----	----	----	----
	INSULATION, Terminal Stud Inner	----	----	859 899	----	1253 332	----
8-29-323	BUSHING, Terminal Stud Insulating (2)	----	1253 346	----	1253 346	----	----
	BUSHING, Armature Terminal Insulating	683 358	----	683 358	----	----	----
8-29-325	BUSHING, Field Terminal Insulating	683 357	----	683 357	----	----	1253 346
8-29-327	WASHER, Armature Terminal Insulating	671 477	1138 481	671 477	1138 481	671 477	1138 481
	WASHER, Field Terminal Insulating	671 481	1253 344	671 481	1253 344	671 481	1253 344

★ Indicates use as required

□ Indicates parts not listed in any previous parts books.

Series No. (1 indicates B-1 Series) (2 indicates B-2 Series) (3 indicates B-3 Series) (4 indicates B-4 Series)

Series No. (1 indicates C-1 Series) (2 indicates C-2 Series)

Where dash (-) is shown in Series Column Part is for All.

Prices and specifications subject to change without notice.

* Indicates change or addition.

Printed in U.S.A.

April 30, 1956 Supersedes Jan. 30, 1953.

CODE	PART NAME AND DESCRIPTION	B SERIES NO.	C SERIES NO.	MODEL CODES		PART NO.
				WDX	PW	
8-32-0 HORN ASSEMBLY						
8-32-2	HORN, Assembly (single) 6 Volt	-	-	1	1	*1089 619
	Single, 12 Volt	-	3		1	*1089 622
	(high note) (6 volt)	-	-	1	1	* 866 103
	(low note) (6 volt)	-	-	1	1	* 866 104
	Single, 12 Volt	-	3		1	*1089 622
	(high note) (12 volt)	-	-	1	1	* 866 105
	(low note) (12 volt)	-	-	1	1	* 866 106
8-32-3	PLATE, Horn Mounting, w/Tapping PLATE	-	-	★	★	* 868 624
8-32-15	BRACKET, Horn Mounting (up to engine No. 10438)	-	-	1	1	* 635 415
	(after engine No. 10438)	-	-	1	1	*1261 497
	(dual horns)	-	-	1	1	* 861 247
8-32-22	SPACER, Horn Bracket Lamination	-	-			
	(after serial No. 83909070 Det. 88759751 S. L.)	-	-	2	2	*1089 626
	(dual horns)	-	-	4	4	*1089 626
8-32-23	PLATE, Horn Mounting Lamination Rivet	-	-	1	1	* 683 365
	(after serial No. 83909070 Det. 88759751 S. L.)	-	-			
8-32-59	SCREW, Horn Back and Bracket	-	-	2	2	* 643 835
8-32-100	INSULATION	-	-	2	2	*1134 118
8-32-101	STUD	-	-	2	2	* 643 969
8-32-165	BUSHING	-	-	2	2	* 643 958
8-32-182	DIAPHRAGM, Horn	-	-	1	1	* 643 956
8-32-183	GASKET, Diaphragm	-	-	1	1	* 863 141
8-32-213	PROJECTOR, Horn	-	-	1	1	* 643 953
8-33-0 HORN CONTROL						
8-33-30	SPRING, Button Retainer Plate	-	-	1	1	*1390 694
8-33-41	BUTTON	-	-	1	1	* 590 213
8-33-65	PLATE, Button Retainer, Upper	-	-	1	1	* 669 811
	Lower (up to serial No. 83900294)	-	-	1		* 658 880
	Lower (after serial No. 83900294)	-	-	1	1	* 582 407
8-33-67	LOCKWIRE, Retainer Plate	-	-	1	1	* 657 955
8-33-79	SPRING, Button, w/BASE	-	-	1	1	* 681 402
8-33-100	CABLE, Button	-	-	1	1	*1260 827
8-33-102	INSULATOR, Button Cable	-	-	1	1	* 657 484
8-33-106	CONTACT, Button Cable	-	-	1	1	* 611 897
8-33-120	TERMINAL, Horn Button Cable	-	-	1	1	* 665 151
8-33-164	RELAY (w/dual horns)	-	-	1	1	*1113 099
	Screw, No. 8-32 x 1/4" (terminal)	-	-	3	3	* 122 159
	Nut (ground)	-	-	2	2	* 120 367
	Washer, lock (ground)	-	-	2	2	* 121 753
8-33-165	SCREW, Relay Mounting	-	-	2	2	* 929 054
8-33-185	WASHER, Relay Terminal Screw Lock	-	-	3	3	* 300 934
8-34-0 HEADLAMP						
8-34-1	HEADLAMP, w/BRACKET, 6 Volt	-	-	2	2	*1091 638
	12 Volt	-	3		2	E1567 157
8-34-33	SHELL	-	-	2	2	*1188 966
8-34-40	DOOR	-	-	2	2	* 913 296
8-34-175	UNIT, Sealed Beam (Domestic, and right way shift-Export)	-	-			
	6 Volt	-	-	2	2	*1297 667
	(left way shift-Export) 6 Volt	-	-	2	2	*1302 599
	(Domestic and right way shift-Export) 12 Volt	-	3	2	2	*1567 159
8-34-176	SEAT, Bulb Mounting	-	-	2	2	*1089 608
8-34-177	SPRING, Bulb Mounting Seat	-	-	4	4	* 854 798
8-34-178	SCREW (adjusting)	-	-	4	4	* 865 336
8-34-179	NUT (adjusting)	-	-	4	4	* 865 760
8-34-180	RING, Bulb Retaining	-	-	2	2	* 866 217
	Screw, No. 8-32 x 5/16"	-	-	6	6	* 224 549
8-34-220	CABLE, w/SOCKET	-	-	2	2	*1189 490
	WIRING, 6 Volt	-	1, 3		1	*1267 381
	CABLE, 12 Volt	-	3		1	E1567 158

★ Indicates use as required

Prices and specifications subject to change without notice.

* Indicates change or addition.

E Indicates parts not listed in any previous parts books.

Series No. (1 indicates B-1 Series) (2 indicates B-2 Series) (3 indicates B-3 Series) (4 indicates B-4 Series)

Series No. (1 indicates C-1 Series) (3 indicates C-3 Series)

Where dash (-) is shown in Series Column Part is for All.

POWER WAGON PARTS LIST

ELECTRICAL

CODE	PART NAME AND DESCRIPTION	B SERIES NO.	C SERIES NO.	MODEL CODES		PART NO.
				WDX	PW	
8-34-0 HEADLAMP - Cont'd						
8-34-302	BRACKET, Mounting	-	-	2	2	*1091 639
	Screw, No. 10-32 x 3/8"	-	-	8	8	* 132 900
	Stud	-	-	4	4	* 113 240
	Nut	-	-	4	4	* 120 368
	Washer, lock	-	-	8	8	* 120 217
	Washer, lock	-	-	4	4	* 120 214
8-35-0 IGNITION COIL AND SWITCH						
8-35-4	COIL (up to engine No. T137-21312) 6 Volt	-	-	1	1	* 920 367
	(after engine No. T137-21312) 6 Volt	-	-		1	*1300 667
	12 Volt	-	3		1	E1626 875
	Nut (terminal)	-	-	3	3	* 120 614
	Nut	-	-	2	2	* 120 367
	Washer, lock (terminal)	-	-	3	3	* 138 479
	Washer, lock	-	-	2	2	* 121 753
8-35-41	CLAMP, Coil Mounting (up to engine No. T137-19085)	-	-	1	1	* 920 368
	BRACKET, Coil Mounting (up to engine No. T137-19085)	-	-	1	1	*1088 826
	Coil Mounting, w/Cable TUBES, From engine No. T137-19085 to Ser. No. 83939871	-	-		1	*1188 452
	Cable and Coil Mounting, AFTER Ser. No. 83939871	-	1			E1594 768
	Screw, No. 10-32 x 1 1/2"	-	3			*1604 161
	Stud	-	-	2	2	* 153 479
	Nut	-	-	1	1	* 113 240
	Nut	-	-	2	2	* 120 614
	Washer, lock	-	-	1	1	* 120 368
	Washer, lock	-	-	2	2	* 120 217
	Washer, lock	-	-	2	2	* 138 485
	Washer, lock	-	-	2	2	* 121 753
8-35-59	SWITCH, Ignition Lock, w/Housing	-	-	1	1	1232 508
8-35-111	CYLINDER and KEY PACKAGE, Front Door and Ignition Lock	-	-	1	1	*1189 666
8-35-115	CYLINDER and KEY PACKAGE, Ignition Lock	-	-	1	1	*1189 676
8-35-122	KEY, Ignition Lock (blank) (HY Series)	-	-	*	*	*1233 112
8-36-0 IGNITION WIRING AND SPARK PLUGS						
8-36-1	CABLE SET	-	-	1	1	*1243 798
8-36-2	WEATHERPROOFING PACKAGE, Evr-Dry	-	-	1	1	*1321 284
8-36-4	TUBE, Ignition Cables, w/BRACKET	-	-	1	1	* 600 829
	Bolt, 3/8" - 16 x 5/8"	-	-	1	1	* 180 118
8-36-5	NUT, Cable Tube and Bracket Bolt	-	-	1	1	* 601 014
8-36-19	COVER PACKAGE, Spark Plug	-	-	1	1	*1321 284
8-36-27	CABLE, Coil Primary (specify 9" of 211 318 Cable, 1-200 393 Terminal, 1-200 156 Terminal and 1-1264 933 Sleeve)	-	-	*	*	-----
8-36-45	CABLE, Ignition (specify length of 1109 243 Cable as shown below, also specify 6-676 872 Terminal, 6-1122 042 Terminal and 6-150 834 Nipple)	-	-	*	*	-----
	No. 1 Spark Plug Cable - 24" lgh.					
	No. 2 Spark Plug Cable - 21" lgh.					
	No. 3 Spark Plug Cable - 17" lgh.					
	No. 4 Spark Plug Cable - 18" lgh.					
	No. 5 Spark Plug Cable - 22" lgh.					
	No. 6 Spark Plug Cable - 23" lgh.					
	CABLE, Coil Secondary (specify 9" of 1109 243 Cable, 2-676 872 Terminals and 2-150 834 Nipple)	-	-	*	*	-----
8-36-46	CABLE, Ignition Coil and Spark Plugs (100 ft. roll)	-	-	*	*	E1326 168
8-36-55	TERMINAL (coil end) (distributor end)	-	-	*	*	* 676 872
	Nipple (distributor)	-	-	*	*	* 150 834
8-36-95	TERMINAL (plug end)	-	-	6	6	*1122 042
8-36-96	NIPPLE, Coil Secondary Cable Term.	-	-		*	E1658 838
8-36-114	SPARK PLUG (up to engine No. T137-13829)	1, 2	3	6	6	*1406 647

★ Indicates use as required

□ Indicates parts not listed in any previous parts books.

Series No. (1 indicates B-1 Series) (2 indicates B-2 Series) (3 indicates B-3 Series) (4 indicates B-4 Series)

Series No. (1 indicates C-1 Series) (3 indicates C-3 Series)

Where dash (-) is shown in Series Column Part is for All.

Prices and specifications subject to change without notice.

* Indicates change or addition.

Printed in U.S.A.

CODE	PART NAME AND DESCRIPTION	B SERIES NO.	C SERIES NO.	MODEL CODES		PART NO.
				WDX	PW	
8-36-0 IGNITION WIRING AND SPARK PLUGS - Cont'd						
8-36-114	SPARK PLUG and GASKET PACKAGE (AR-5) (from engine No. T137-13829 to T137-19501)	2, 3			6	*1257 587
	(AR-8A) (after engine No. T137-19501)	2, 3, 4			6	*1345 905
	(4S-140) UP TO Engine T137-83983		1, 3		6	*1473 697
	(AR-80A) AFTER Engine No. T137-83983		3		6	E1658 844
8-36-115	GASKET, Spark Plug	-	-	6	6	150 189

8-37-0 INSTRUMENT PANEL INSTRUMENTS

Note: Parts indicated by single dagger (†) are used up to serial No. 83922966 Det. - 88766605 S. L.
Parts indicated by a double dagger (‡) are used after serial No. 83922966 Det. - 88766605 S. L.

8-37-1	AMMETER (up to serial No. 83914263 except not used on 83914035 thru 83914058 and 83914064 thru 83914111)	1		1	1	596 900
	(after serial No. 83914263 also used on 83914035 thru 83914058 and 83914064 thru 83914111)	1, 2			1	*1265 017
		3			1	†1265 017
		3, 4	1		1	*1272 351
	use w/Elect. Temp. Gauge, 6 Volt		1, 3		1	*1500 380
	12 Volt		3		1	E1660 852
	Nut (terminal)	-	-	2	2	120 614
	Washer, lock	-	-	2	2	138 479
8-37-90	BEZEL, Instrument	1, 2, 3		2	2	† 591 981
		3, 4	1, 2		1	‡1195 748
	w/Electric Temp. Gauge		3		1	*1501 510
	Screw, No. 10-16 x 1/2"	3, 4	-	2	2	163 217
8-37-92	GASKET, Instrument Bezel	1, 2, 3		2	2	† 592 489
	UP TO Eng. No. T137-56153	3, 4	1, 3		1	*1195 749
	AFTER Eng No. T137-56153		3		1	*1501 508
8-37-104	EYELET, Instruments Mounting Screw	3, 4	-		2	*1391 990
8-37-136	GAUGE, Temperature	1, 2, 3		1	1	† 591 988
	Capillary Type	3, 4	-		1	*1502 682
	Electric Type, 6 Volt		-		1	*1507 051
	Electric Type, 12 Volt		3		1	E1660 853
8-37-146	DIAL, Temperature Gauge and Oil Gauge (glass) (Fahrenheit)	1, 2		1	1	591 985
	(glass) (Centigrade)	1, 2		1	1	592 002
	DIAL, Ammeter and Fuel Gauge (w/596 900 ammeter) (glass)	1, 2		1	1	596 902
	(w/1265 017 ammeter)(glass)	1, 2		1	1	*1265 018
8-37-149	CLIP, Heat Indicator Tube to Cylinder Head	1, 2		1	1	927 805
8-37-154	NUT, Temperature Gauge Gland	-		1	1	50 291
8-37-155	SENDING UNIT, Temperature Gauge Electric		1, 3		1	*1507 050
	Nut, Terminal		-		1	* 120 614
	Washer, lock		-		1	* 138 479
8-37-156	PLATE, Instrument Face	1, 2, 3		1	1	† 591 983
	Instrument Dial	3, 4			1	*1272 373
8-37-161	GASKET, Instrument Glass Dial	1, 2, 3		2	2	† 592 490
	Instrument Dial Plate	3, 4	-		1	*1195 751
8-37-162	GLASS, Instrument Dial	3, 4	-		1	*1195 750
8-37-178	HOUSING, Instruments	1, 2, 3		1	1	† 591 982
	w/Light WINDOW and SHIELD	3, 4	-		1	*1262 336
	Screw, No. 8-32 x 1/4 in.	3, 4	-	★	★	122 159
8-37-201	CUP, Instrument Screws Insulating	3, 4	-		★	*1 939 548
8-37-212	GASKET, Instruments, Mounting	1, 2, 3		2	2	† 591 984
		3, 4	-		1	*1262 312
8-37-275	GAUGE, Fuel	1, 2		1	1	591 990
		3, 4	-		1	*1272 353
	GAUGE, Fuel, w/6 Volt Elec. Temp. Gauge		1, 3		1	*1500 379
	w/12 Volt Elec. Temp. Gauge		3		1	E1660 854
	Nut (terminal)	-	-	3	3	120 614
	Washer, lock	-	-	3	3	138 479

★ Indicates use as required

Prices and specifications subject to change without notice.

E Indicates parts not listed in any previous parts books.

* Indicates change or addition.

Series No. (1 indicates B-1 Series) (2 indicates B-2 Series) (3 indicates B-3 Series) (4 indicates B-4 Series)

Series No. (1 indicates C-1 Series) (3 indicates C-3 Series)

Where dash (-) is shown in Series Column Part is for All.

Printed in U.S.A.

POWER WAGON PARTS LIST

ELECTRICAL

CODE	PART NAME AND DESCRIPTION	B SERIES NO.	C SERIES NO.	MODEL CODES		PART NO.
				WDX	PW	
8-37-0 INSTRUMENT PANEL INSTRUMENTS - Cont'd						
8-37-316	GAUGE, Oil	1, 2 3, 4	-	1	1 1	591 989 *1272 352
	w/Elec. Temp Gauge		1, 3		1	*1509 659
8-37-372	SPEEDOMETER (mile) (up to serial No. 83919725 Det. - 88766262 S. L.)	1, 2		1	1	595 361
	(mile) (from serial No. 83919725 Det. - 88766262 S. L. to 83922966 Det. 88766605 S. L.)	2, 3			1	*1271 152
	(mile)	3, 4	-		1	*1271 232
	(kilometer)	1, 2		1	1	595 362
	(kilometer)	3, 4			1	*1271 153
	(kilometer)	3, 4	-		1	*1272 319
	Screw, No. 10-16 x 1/2"	-	-	4	4	163 217
	Nut	-	-	4	4	120 614
	Washer, lock	-	-	4	4	138 479
8-37-384	EYELET, Speedometer Mounting Screw (w/1271 152, 1271 153, 1271 232 and 1272 319 speedometer)	2, 3, 4	-		4	*1263 532
8-37-388	GASKET, Speedometer Bezel (w/1271 152, 1271 153, 1271 232 and 1272 319 speedometer)	2, 3, 4	2, 3, 4		1	*1262 973
8-37-399	DIAL, Speedometer (mile) (w/1271 232 and 1272 319 speedometer)	3, 4	-		1	*1272 337
	(kilometer) (w/1271 232 speedometer)	3, 4	-		1	*1272 338
8-37-410	LENS, Speedometer (mile) (w/595 361 and 595 362 speedometer)	1, 2		1	1	* 589 883
	GLASS, Speedometer Dial (w/1271 152, 1271 153, 1271 232 and 1272 319 speedometer)	2, 3, 4	-		1	*1262 972
8-37-411	BEZEL, Speedometer (w/1271 152, 1271 153, 1271 232 and 1272 319 speedometer)	2, 3, 4	-		1	*1260 775
	w/1569 118 and 1569 117 Speedos.		3		1	1569 121
	GASKET, Speedometer Dial Glass Mounting (w/1271 152, 1271 153, 1271 232 and 1272 319 speedometer)	2, 3, 4			1	*1262 971
8-37-440	PLATE, Speedometer Face (sub-dial)(w/595 361 and 595 362 speedometer)	1, 2		1	1	* 599 670
8-39-0 HEADLAMP BEAM INDICATOR						
8-39-3	INDICATOR, w/JEWEL	-	-	1	1	*1149 850
8-39-5	BODY	-	-	1	1	*1163 840
8-39-15	SOCKET, Cable	-	-	1	1	1605 517
8-39-16	SPRING, Socket Cable	-	-	1	1	*1385 532
8-39-17	CONTACT, Socket Cable	-	-	1	1	*1657 572
8-39-18	BUSHING, Socket Cable	-	-	1	1	*1657 583
8-41-0 INSTRUMENT LAMP						
8-41-36	SOCKET	-	-	3	3	1605 517
8-41-37	SPRING, Socket	-	-	3	3	* 385 532
8-41-39	CONTACT, Socket Cable	-	-	3	3	* 657 572
8-41-40	BUSHING, Socket Cable	-	-	3	3	* 657 583
8-44-0 LAMP BULBS						
8-44-1	BULB, Tail and Signal Lamp, 6 Volt	-	-	★	★	* 142 449
	Dome Lamp, 6 Volt	-	-	★	★	* 142 304
	Instrument Panel, 6 Volt	-	-	★		* 115 273
	Headlamp Beam Indicator	-	-	★	★	125 588
	Instrument Panel, 12 Volt	-	-	1	1	* 115 273
	Tail Lamp, 12 Volt		3		1	* 127 934
	Head Lamp Beam Indicator, 12 Volt		3		★	* 151 567
	Parking Lamp, 12 Volt		3		1	* 127 934
					2	* 142 450
8-47-0 LICENSE MOUNTING PARTS						
8-47-8	BRACKET, Front	-	-	1	1	*1189 389
8-47-75	BRACKET, Tail Lamp License Plate, 6 Volt	-	-	1	1	*1267 834
	12 Volt		3		1	*1502 240

★ Indicates use as required

Prices and specifications subject to change without notice.

□ Indicates parts not listed in any previous parts books.

* Indicates change or addition.

Series No. (1 indicates B-1 Series) (2 indicates B-2 Series) (3 indicates B-3 Series) (4 indicates B-4 Series)

Series No. (1 indicates C-1 Series) (3 indicates C-3 Series)

Printed in U.S.A.

Where dash (-) is shown in Series Column Part is for All.

CODE	PART NAME AND DESCRIPTION	B SERIES NO.	C SERIES NO.	MODEL CODES		PART NO.
				WDX	PW	
8-48-0 MARKER AND CLEARANCE LAMPS						
8-48-4	LAMP, Clearance (single unit)	-	-	2	2	*1266 491
	Screw, No. 10-16 x 1/2"	-	-	4	4	* 143 152
	Washer, lock	-	-	4	4	* 120 217
8-48-25	LAMP, Marker (amber lens)(cluster of three lamps)	-	-	1	1	*1268 164
	(red lens) (cluster of three lamps)	-	-	1	1	*1272 307
	Screw, No. 10-32 x 3/8"	-	-	4	4	* 132 900
	Nut	-	-	4	4	* 120 614
	Washer, lock	-	-	4	4	* 120 217
8-48-34	TERMINAL, Marker Lamp Wiring	-	-	1	1	* 665 151
8-48-35	CONNECTOR, Marker Lamp Wiring "Y"	-	-	1	1	* 689 867
8-50-0 PARKING LAMP AND TURN SIGNAL						
8-50-82	SWITCH, Turn Signal Lamp	-	-	1	1	*1391 899
	12 Volt	-	3			E1662 095
8-50-85	PLATE, Turn Signal Lamp Switch Control	-	-	1	1	*1394 268
8-50-86	BRACKET, Turn Signal Lamp Switch Mounting	-	-	2	2	*1394 267
8-50-92	STRAP, Turn Signal Lamp	-	-	1	1	*1394 266
8-50-149	TERMINAL	-	-	10	10	* 665 151
		-	-	2	2	200 394
8-50-151	CONNECTOR	-	-	9	9	* 611 898
8-50-186	FLASHER	-	-	1	1	*1450 479
	12 Volt	-	3			E1496 095
	Screw or Bolt, 1/4" - 20 x 3/8"	-	-	1	1	* 131 375
	Nut	-	-	1	1	* 120 375
	Washer, lock	-	-	1	1	* 120 380
8-50-303	LAMP, Parking, Right, 6 Volt	-	-	1	1	* 599 981
	Left, 6 Volt	-	-	1	1	* 599 980
	Right, 12 Volt	-	3		1	E1567 150
	Left, 12 Volt	-	3		1	E1567 151
	Bolt, 1/4" - 20 x 1"	-	-	4	4	* 126 315
	Nut	-	-	4	4	* 120 375
	Washer, lock	-	-	8	8	* 121 753
8-50-308	PAD, Mounting	-	-	2	2	* 599 982
8-50-315	DOOR, Parking Lamp	-	-	2	2	* 946 968
8-50-331	REFLECTOR	-	-	2	2	* 946 969
8-50-335	LENS	-	-	2	2	* 939 615
8-50-336	RETAINER, Lens	-	-	2	2	* 946 971
	Screw, No. 8-32 x 2"	-	-	2	2	* 133 523
8-50-338	GASKET, Lens	-	-	2	2	* 946 970
8-50-349	CABLE, w/SOCKET	-	-	2	2	* 946 972
8-50-362	CLIP, Cable Loom Retainer	-	-	2	2	* 641 400
8-50-365	TERMINAL, Cable	-	-	2	2	* 665 151
8-51-0 REFLECTOR						
8-51-1	REFLECTOR (red lens)	-	-	★	★	* 922 461
	(amber lens)	-	-	★	★	* 922 462
8-51-2	SCREW	-	-	4	4	* 929 054
8-52-0 STARTING MOTOR						
8-52-2	COIL PACKAGE, Field	-	3		1	E1662 181
8-52-4	STARTER (up to engine No. T137-21240) 6 Volt	-	1, 2	1	1	*1070 939
	(after engine No. T137-21240) 6 Volt	-	2, 3, 4		4	*1268 125
	12 Volt	-	3		1	E1569 176
	Bolt, 7/16" - 14 x 1 1/4"	-	-	★	★	* 180 147
	Stud	-	-	★	★	* 151 386
	Nut	-	-	★	★	* 271 506
	Washer, lock	-	-	★	★	* 120 383

★ Indicates use as required

E Indicates parts not listed in any previous parts books.

Series No. (1 indicates B-1 Series) (2 indicates B-2 Series) (3 indicates B-3 Series) (4 indicates B-4 Series)

Series No. (1 indicates C-1 Series) (3 indicates C-3 Series)

Where dash (-) is shown in Series Column Part is for All.

Prices and specifications subject to change without notice.

* Indicates change or addition.

Printed in U.S.A.

8-52-0 STARTING MOTOR - Cont'd

CODE	STARTER	E1569 176	1070 939	1268 125
Note: All quantities are one (1) unless otherwise indicated in parenthesis.				
8-52-41	CLUTCH	*1343 708	871 754	1343 708
8-52-46	YOKE	*1390 062	919 949	1390 062
8-52-50	PIN, Yoke	*1343 710	-----	1343 710
	SCREW, Yoke	-----	959 467	-----
	Washer, lock	-----	120 382	-----
	Pin, cotter	-----	-----	103 373
8-52-51	NUT, Yoke Screw	-----	51 104	-----
8-52-61	PIN, Yoke Pin Cotter	E1478 103	-----	-----
8-52-67	SNAP RING, Clutch	*1273 430	-----	1343 707
8-52-68	RETAINER, Clutch	*1343 706	-----	1343 706
8-52-76	HOUSING, Pinion	*1390 064	919 950	1390 063
	Pin, stght.	-----	112 006	112 006
8-52-80	BEARING, Housing	* 636 845	636 845	636 845
8-52-120	ARMATURE	E1662 177	641 443	1343 705
8-52-121	WASHER, Armature Thrust Commutator End (1/32" thk.) (★)	* 641 446	641 446	641 446
	WASHER, Armature Thrust Commutator End (3/64" thk.) (★)	* 672 641	672 641	672 641
	WASHER, Armature Thrust Commutator End (★)	*1369 645	669 412	1369 645
	WASHER, Armature Thrust Commutator End (★)	-----	641 445	-----
	WASHER, Commutator Thrust Drive End (★)	* 641 444	641 444	641 444
8-52-122	SPACER, Armature Shaft	-----	636 842	1369 644
8-52-135	BRUSH SET	E1658 552	-----	1345 005
	Screw, No. 10-32 x 3/8" (2)	-----	-----	132 900
	Washer, lock (2)	-----	-----	120 217
8-52-136	BRUSH, Insulated (2)	-----	636 838	-----
	BRUSH, Grounded (2)	-----	636 820	-----
8-52-139	SPRING, Brush (4)	* 636 841	636 841	636 841
8-52-176	HEAD, Commutator End	E1658 554	1123 011	1138 525
8-52-184	PAD, Commutator End Felt	-----	636 840	636 840
8-52-195	BAND, Cover	-----	641 457	1345 000
	Screw, No. 10-32 x 1 1/2"	-----	132 930	-----
	Nut	-----	120 614	-----
8-52-216	COIL, Field, Right	-----	930 277	1390 060
8-52-217	COIL, Field, Left	-----	643 827	1390 059
8-52-222	EQUALIZER, Field Coil	-----	-----	1138 519
8-52-241	BOLT, Thru (2)	*1300 503	641 454	1300 503
	Washer, lock (2)	* 131 098	131 098	131 098
8-52-250	BUSHING, Terminal Stud Insulating	* 636 825	636 825	636 825
8-52-251	WASHER, Terminal Stud Insulating	*1390 057	636 816	1390 057
8-52-255	INSULATION, Field Connection	-----	636 818	636 818
8-52-258	INSULATION, Terminal Stud	-----	636 818	-----
8-52-271	SCREW, Pole Shoe (4)	-----	859 901	859 901
8-52-275	STUD, Field Terminal	E1662 182	636 822	636 822
	Nut	-----	120 377	120 377
	Washer, lock	-----	120 382	120 382
8-52-287	PACKAGE, Switch Insulator and Lower Contact	*1501 797	-----	1501 797
8-52-290	SWITCH	*1390 061	641 462	1390 061
	Screw, No. 10-32 x 3/8" (mounting)	* 132 900	132 900	132 900
	Nut (terminal)	* 120 377	120 377	120 377
	Washer, lock (mounting)	* 138 479	138 479	138 479
	Washer, lock (terminal)	* 120 382	120 382	120 382
8-52-297	INSULATION, Switch Contact	-----	1136 566	1136 566
8-52-457	PEDAL, Assembly	-----	-----	1265 130

★ Indicates use as required

Prices and specifications subject to change without notice.

E Indicates parts not listed in any previous parts books.

* Indicates change or addition.

Series No. (1 indicates B-1 Series) (2 indicates B-2 Series) (3 indicates B-3 Series) (4 indicates B-4 Series)

Series No. (1 indicates C-1 Series) (3 indicates C-3 Series)

Printed in U.S.A.

Where dash (-) is shown in Series Column Part is for All.

CODE	PART NAME AND DESCRIPTION	B SERIES NO.	C SERIES NO.	MODEL CODES		PART NO.
				WDX	PW	
8-53-0 SWITCHES						
8-53-150	SWITCH, Dimmer	-	-	1	1	*1450 772
	Screw or Bolt, 1/4"-20 x 5/8"	-	-	2	2	* 120 583
8-53-210	SWITCH, Instrument Panel Lamp	-	-	1	1	* 583 127
	Screw, No. 8-32 x 1/4" (terminal)	-	-	2	2	* 122 159
	Washer, plain (spacer)	-	-	1	1	* 120 395
	Washer, lock (terminal)	-	-	2	2	* 138 530
8-53-211	NUT, Instrument Panel Lamp Switch Mounting	-	-	1	1	* 898 504
8-53-213	WASHER	-	-	1	1	*1194 598
8-53-225	KNOB, Instrument Panel Lamp Switch	-	-	1	1	* 589 850
8-53-269	SWITCH and SPACER PACKAGE, Headlamp, 6 Volt	-	-	1	1	*1345 638
	Nut	-	-	2	2	* 120 614
	Washer, lock	-	-	2	2	* 138 479
8-53-270	SWITCH, Headlamp, 6 Volt	-	1,3	1	1	*1260 727
	12 Volt	-	3		1	*1660 525
8-53-271	NUT, Headlamp Mounting	-	-	1	1	* 898 504
8-53-272	WASHER, Headlamp Mounting Nut	-	-	1	1	*1194 598
8-53-281	CIRCUIT BREAKER, 6 Volt	-	1,3	1	1	*1370 395
	12 Volt	-	3		1	⊠1540 427
8-53-296	KNOB, Headlamp Switch	-	-	1	1	* 596 901
8-55-0 TAIL LAMP						
8-55-7	LAMP, Left, 6 Volt	-	-	1	1	*1195 670
	Right (for dual installation) 6 Volt	-	-	1	1	* 923 795
	Nut	-	-	★	★	* 120 375
	Washer, lock	-	-	★	★	* 121 753
	LAMP, 12 Volt	-	3		1	⊠1566 608
8-55-75	BRACKET, Mounting (right for Express)	-	-	1	1	* 592 462
	(except Express) 12 Volt	-	3		1	*1502 242
8-55-111	ARM, Bracket, Right (Express)	-	-	1	1	*1189 555
	(except Express)	-	-	1	1	* 590 998
	Left (Express)	-	-	1	1	*1188 959
	(except Express)	-	-	1	1	* 590 944
	Washer, lock	-	-	★	★	* 120 214
8-55-158	SHELL, Door, 6 Volt	-	-	★	★	* 628 949
	Screw, No. 8-32 x 5/8"	-	-	★	★	* 132 764
	BEZEL, 12 Volt	-	3		★	*1502 636
	Screw	-	-		2	* 161 867
8-55-195	LENS, Door, 6 Volt	-	-	★	★	*1195 677
	12 Volt	-	3		★	*1502 641
8-55-206	RETAINER, Lens, 6 Volt	-	-	★	★	* 300 134
8-55-214	GASKET, Lens, 6 Volt	-	-	★	★	* 300 133
	12 Volt	-	-	★	★	*1502 637
8-55-235	LENS, License, 6 Volt	-	-	1	1	* 300 137
8-55-236	RETAINER, License Lens, 6 Volt	-	-	1	1	* 300 139
	12 Volt	-	3		★	*1502 638
8-55-237	GASKET, License Lens, 6 Volt	-	-	1	1	* 300 138
	12 Volt	-	3		1	*1502 640
8-55-239	SCREW, License Lens Retainer	-	-	2	2	* 300 140
8-55-266	CABLE, Extension (w/dual installation)(specify 160" of 211 318 Cable, 4-665 151 Terminals)	-	-	★	★	-----
8-55-269	TERMINAL, Cable	-	-	★	★	* 665 151
8-55-273	CONNECTOR, Extension Cable "Y"	-	-	1	1	* 689 867
8-55-293	SPRING, Cable, 12 Volt	-	3		1	* 44 758
8-58-0 STOP LAMP						
8-58-60	SWITCH	-	-	1	1	*1450 341
8-58-63	CLIP	-	-	1	1	* 677 113

★ Indicates use as required

⊠ Indicates parts not listed in any previous parts books.

Series No. (1 indicates B-1 Series) (2 indicates B-2 Series) (3 indicates B-3 Series) (4 indicates B-4 Series)

Series No. (1 indicates C-1 Series) (3 indicates C-3 Series)

Where dash (-) is shown in Series Column Part is for All.

Prices and specifications subject to change without notice.

* Indicates change or addition.

Printed in U.S.A.

April 30, 1956.

