

GROUP 3 - AXLE-REAR

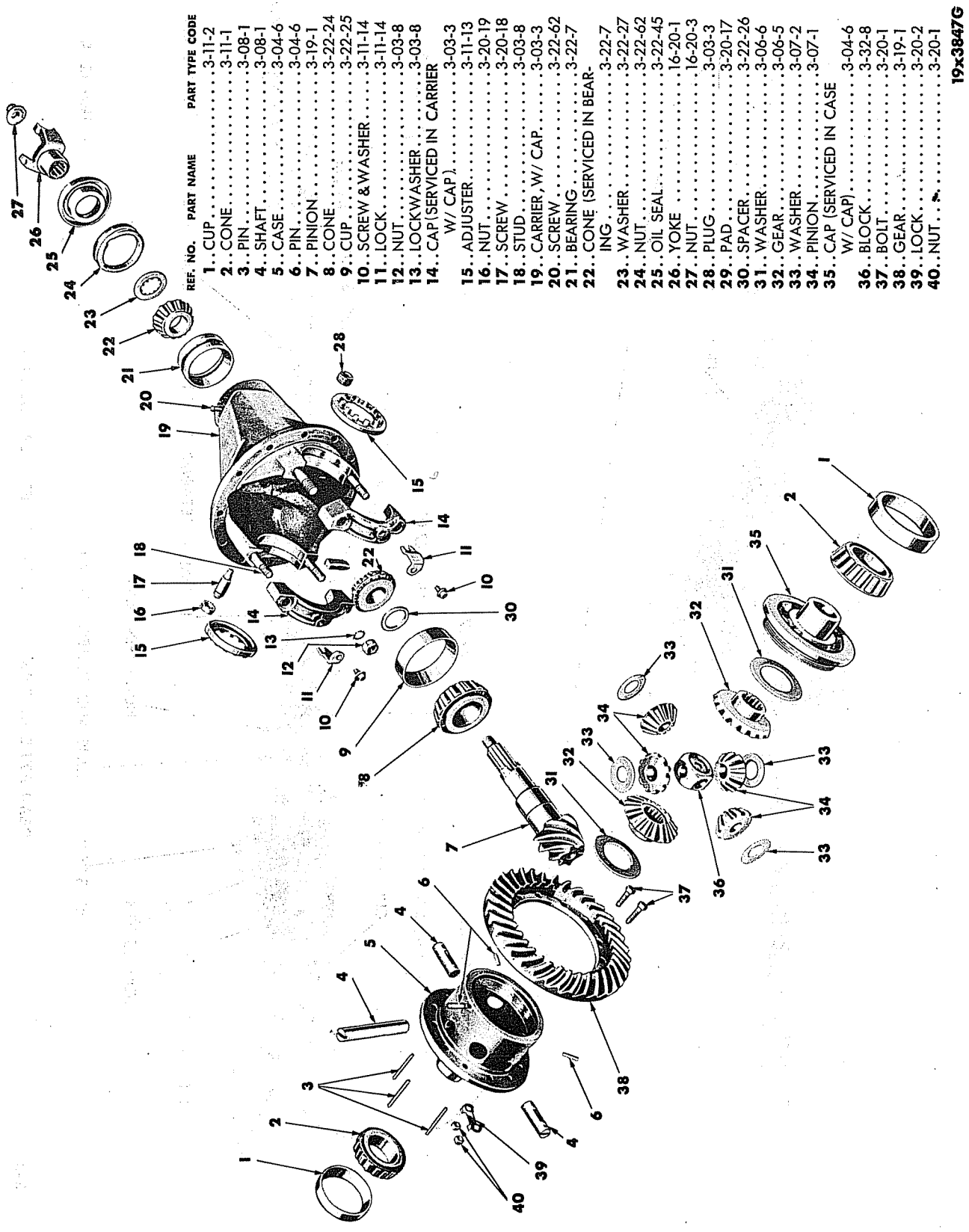

REF. NO.	PART NAME	PART TYPE CODE
1.	CUP	3-11-2
2.	CONE	3-11-1
3.	PIN	3-08-1
4.	SHAFT	3-08-1
5.	CASE	3-04-6
6.	PIN	3-04-6
7.	PINION	3-19-1
8.	CONE	3-22-24
9.	CUP	3-22-25
10.	SCREW & WASHER	3-11-14
11.	LOCK	3-11-14
12.	NUT	3-03-8
13.	LOCKWASHER	3-03-8
14.	CAP (SERVICED IN CARRIER W/ CAP)	3-03-3
15.	ADJUSTER	3-11-13
16.	NUT	3-20-19
17.	SCREW	3-20-18
18.	STUD	3-03-8
19.	CARRIER, W/ CAP	3-03-3
20.	SCREW	3-22-62
21.	BEARING	3-22-7
22.	CONE (SERVICED IN BEARING)	3-22-7
23.	WASHER	3-22-27
24.	NUT	3-22-62
25.	OIL SEAL	3-22-45
26.	YOKE	16-20-1
27.	NUT	16-20-3
28.	PLUG	3-03-3
29.	PAD	3-20-17
30.	SPACER	3-22-26
31.	WASHER	3-06-6
32.	GEAR	3-06-5
33.	WASHER	3-07-2
34.	PINION	3-07-1
35.	CAP (SERVICED IN CASE W/ CAP)	3-04-6
36.	BLOCK	3-32-8
37.	BOLT	3-20-1
38.	GEAR	3-19-1
39.	LOCK	3-20-2
40.	NUT	3-20-1

19x3847G

DIFFERENTIAL AND CARRIER

Plate 3-1

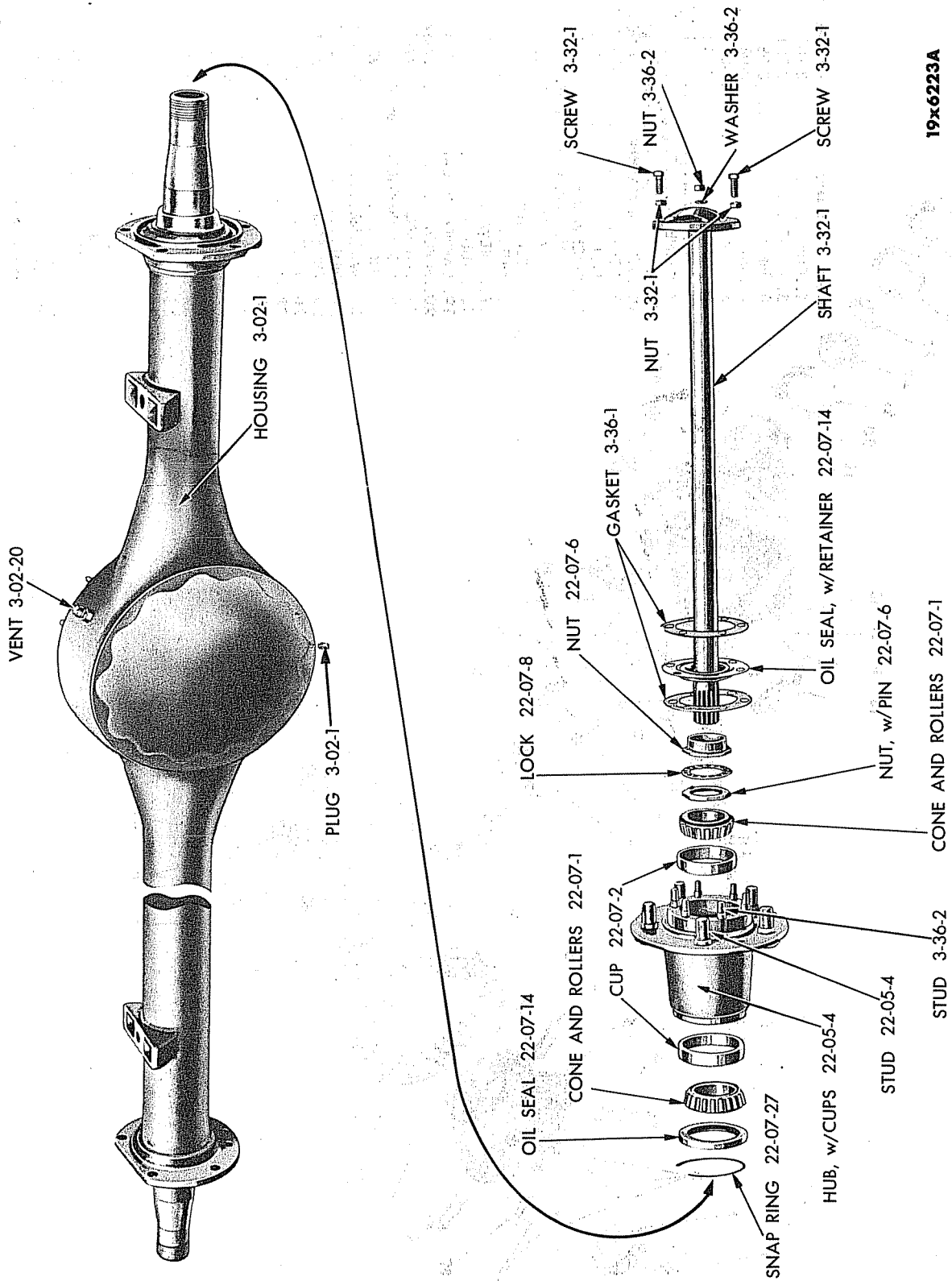

19x6223A

REAR AXLE HOUSING, DRIVE SHAFT, HUB AND BEARING

Plate 3-2

CODE	PART NAME AND DESCRIPTION	B SERIES NO.	C SERIES NO.	MODEL CODES		PART NO.
				WDX	PW	
3-02-0 REAR AXLE HOUSING						
3-02-1	HOUSING	-	-	1	1	*1189 236
	Plug	-	-	1	1	* 143 932
3-02-20	VENT, Assembly	-	-	1	1	* 925 525
3-02-46	REINFORCEMENT, Frame Rear Axle Bumper	-	-	2	2	* 921 403
3-03-0 DIFFERENTIAL AND CARRIER						
3-03-1	DIFFERENTIAL, w/CARRIER (5.83 to 1 ratio)	-	-	1	1	E1501 988
	(4.89 to 1 ratio)	-	-	1	1	E1501 984
3-03-3	CARRIER, w/CAP	-	-	1	1	* 926 239
	Plug	-	-	1	1	* 103 869
3-03-8	STUD, Bearing Cap	-	-	4	4	* 928 288
	Nut	-	-	4	4	* 121 358
	Washer, lock	-	-	4	4	* 138 502
3-03-25	GASKET	-	-	1	1	*1507 759
3-03-26	STUD	-	-	12	12	* 929 855
3-03-31	NUT, Stud	-	-	12	12	* 929 857
	Washer, lock	-	-	12	12	* 120 383
3-04-0 DIFFERENTIAL CASE						
3-04-6	CASE, w/CAP	-	-	1	1	* 928 300
	Pin, stght.	-	-	3	3	* 144 563
3-06-0 DIFFERENTIAL SIDE GEAR						
3-06-5	GEAR (18 teeth)	-	-	2	2	* 922 434
3-06-6	WASHER, Thrust.	-	-	2	2	* 922 422
3-07-0 DIFFERENTIAL GEAR OR PINION						
3-07-1	PINION (11 teeth)	-	-	4	4	* 855 097
3-07-2	WASHER, Thrust.	-	-	4	4	* 855 098
3-08-0 DIFFERENTIAL PINION SHAFT						
3-08-1	SHAFT, Short (2 3/16" long)	-	-	2	2	* 927 839
	Long (5 5/32" long)	-	-	1	1	* 855 099
3-11-0 DIFFERENTIAL BEARINGS						
3-11-1	CONE	-	-	2	2	* 926 244
3-11-2	CUP	-	-	2	2	* 926 245
3-11-13	ADJUSTER	-	-	2	2	* 926 246
3-11-14	LOCK, Adjuster	-	-	2	2	* 856 226
	Screw or bolt, 5/16"-18 x 5/8"	-	-	2	2	* 180 075
3-19-0 DRIVE GEAR AND PINION						
3-19-1	GEAR and PINION SET (5.83 to 1 ratio) (Consists of 928 107 Gear 35 T. and 928 109 Pinion 6 T.)	-	-	1	1	* 928 159
	(4.89 to 1 ratio) (consists of 1265 597 Gear 44 T. and 1265 598 Pinion 9 T.)	-	-	1	1	<i>1265 599</i>
3-20-0 DRIVE GEAR BOLT						
3-20-1	BOLT	-	-	12	12	* 663 481
	Nut	-	-	12	12	* 120 369
3-20-2	LOCK, Nut	-	-	6	6	* 601 859

★ Indicates use as required

E Indicates parts not listed in any previous parts books.

Series No. (1 indicates B-1 Series) (2 indicates B-2 Series) (3 indicates B-3 Series) (4 indicates B-4 Series)

Series No. (1 indicates C-1 Series) (3 indicates C-3 Series)

Where dash (-) is shown in Series Column Part is for All.

Prices and specifications subject to change without notice.

* Indicates change or addition.

Printed in U.S.A.

