

GROUP 19 - STEERING

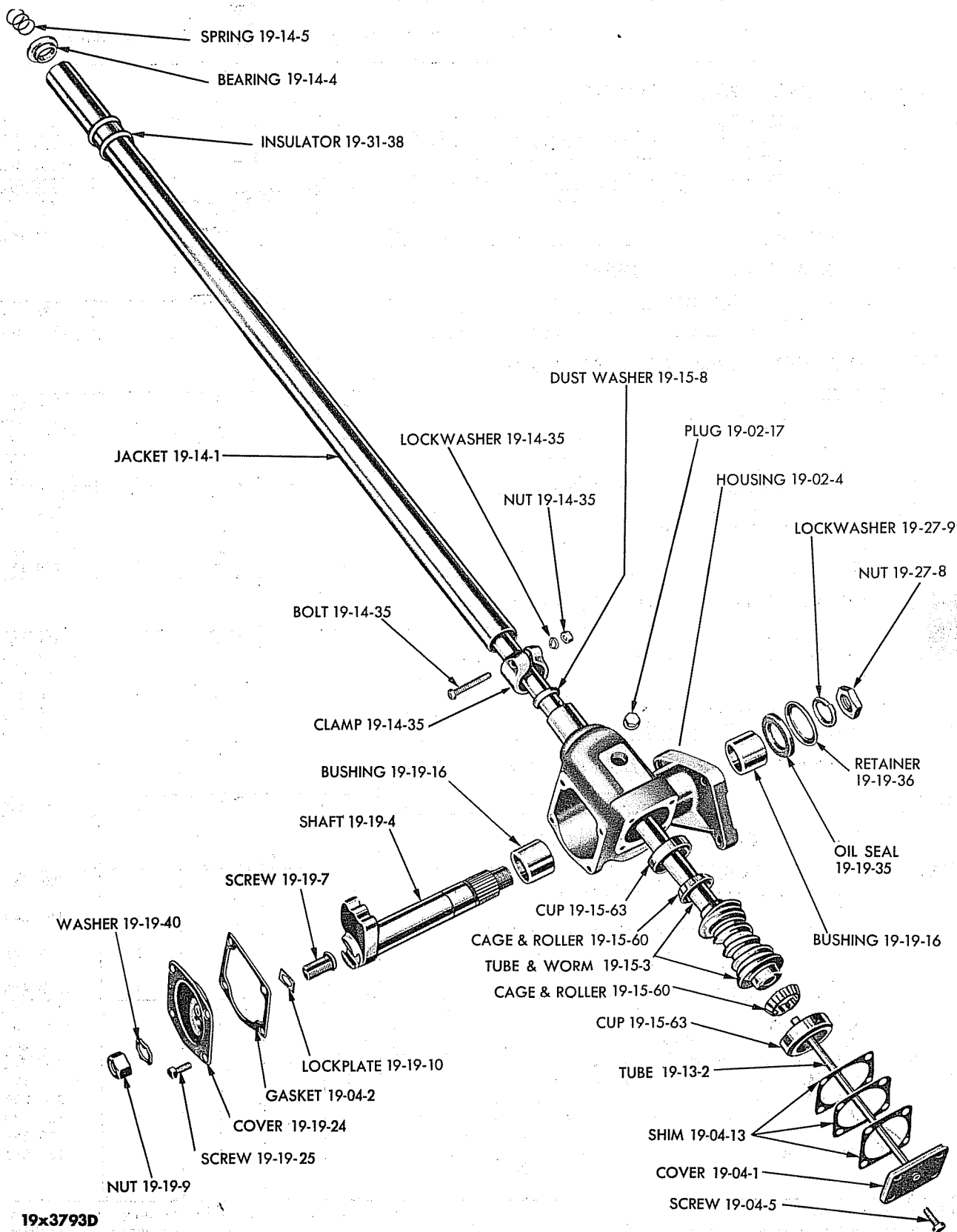

19x3793D

POWER WAGON PARTS LIST

STEERING

CODE	PART NAME AND DESCRIPTION	B SERIES NO.	C SERIES NO.	MODEL CODES		PART NO.
				WDX	PW	

Note 1: Used up to serial No. 83900294 Det. Built and up to serial No. 88750006 also 88750027 L. A. Built.

Note 2: Used after serial No. 83900294 Det. Built and after serial No. 88750006 except 88750027 L. A. Built.

19-01-0 STEERING GEAR ASSEMBLY

19-01-5	GEAR, Assembly (see note 1)	1		1		*1189 340
19-01-8	CHUCK (from serial No. 83900294 to 83919064 Det. Built.)	1, 2		1	1	*1189 342
	(except Flat Face Cowl after serial No. 83919064 Det. Built.)	2, 3, 4	-		1	*1189 342
	(Flat Face Cowl only after serial No. 83919064 Det. Built.)	2, 3, 4	-		1	*1270 072
	Bolt, 5/8" - 11 x 1 3/4"	-	-	4	4	* 271 548
	Washer, lock	-	-	4	4	* 121 574
	Washer, plain	-	-	4	4	* 131 016

19-02-0 STEERING GEAR HOUSING

19-02-4	HOUSING, w/BUSHING (see note 2)	-	-	1	1	*1189 343
19-02-17	PLUG, Oil Filter (see note 2)	-	-	1	1	*1142 221

19-04-0 STEERING GEAR HOUSING COVER

19-04-1	CAP (see note 1)	1		1	1	* 924 258
	COVER, Lower (see note 2)	-	-	1	1	* 918 355
	Bolt, 3/8" - 16 x 1"	-	-	4	4	* 180 122
	Washer, lock	-	-	4	4	* 120 382
19-04-2	GASKET, Cover	-	-	1	1	*1188 667
19-04-5	SCREW, Lower Cover (5/16" - 18 x 3/4")	-	-	4	4	*1188 669
19-04-13	SHIM, Cap (see note 1)	-	-	★		* 924 259
	Lower Cover (see note 2) (thin 1/32")	-	-	★	★	*1123 313
	(thin .006)	-	-	★	★	* 620 180
	(thick .011)	-	-	★	★	* 620 181

19-07-0 STEERING GEAR HOUSING BRACKET

19-07-4	GASKET (see note 1)	1		1		* 368 704
19-07-10	STUD, Adjusting (see note 1)	1		1		* 44 169
	Nut	-	-	1	1	* 271 506
	Washer, lock	-	-	1	1	* 120 383
19-07-24	SLEEVE, Adjusting (see note 1)	1		1		* 75 635
19-07-29	RIVET, Eccentric (see note 1)	1		1		* 78 766

19-13-0 STEERING GEAR GREASE RETAINING TUBE

19-13-2	TUBE	-	-	1	1	* 918 358
---------	------	---	---	---	---	-----------

19-14-0 STEERING GEAR COLUMN JACKET

19-14-1	JACKET, w/BUSHING (see note 1)	1		1		* 924 264
	w/BEARING (from serial No. 83900294 to 83919064 Det. Built.)	1, 2		1	1	*1189 348
	w/BEARING (except Flat Face Cowl after serial No. 83919064 Det. Built.)	2, 3, 4	-		1	*1189 348
	w/BEARING (Flat Face Cowl 1 only after serial No. 83919064 Det. Built.)	2, 3, 4	-		1	*1270 075
19-14-3	BUSHING (see note 1)	1		1		* 925 882
19-14-4	BEARING (see note 2)	-	-	1	1	*1188 659
19-14-5	SPRING, Bearing (see note 2)	-	-	1	1	*1188 660
19-14-15	SPACER, Jacket (see note 2)	-	-	1	1	*1188 661
19-14-35	CLAMP (see note 1)	1		1		* 44 176
	(see note 2)	-	-	1	1	* 386 699
	Bolt 5/16" - 24 x 2"	-	-	1	1	* 181 620
	Nut	-	-	1	1	* 120 368
	Washer, lock	-	-	1	1	* 120 214

★ Indicates use as required

Prices and specifications subject to change without notice.

☐ Indicates parts not listed in any previous parts books.

* Indicates change or addition.

Series No. (1 indicates B-1 Series) (2 indicates B-2 Series) (3 indicates B-3 Series) (4 indicates B-4 Series)

Series No. (1 indicates C-1 Series) (3 indicates C-3 Series)

Printed in U.S.A.

Where dash (-) is shown in Series Column Part is for All.

POWER WAGON PARTS LIST

STEERING

Page 19-3

CODE	PART NAME AND DESCRIPTION	B SERIES NO.	C SERIES NO.	MODEL CODES		PART NO.
				WDX	PW	
19-15-0 STEERING GEAR TUBE AND WORM						
19-15-3	TUBE, w/WORM (from serial No. 83900294 to 83919064 Det. Built.)	1, 2	-	1	1	*1189 345
	(except Flat Cowl after serial No. 83919064 Det. Built.)	2, 3, 4	-		1	*1189 345
	(Flat Face Cowl only after serial No. 83919064 Det. Built.)	2, 3, 4	-		1	*1270 073
19-15-4	TUBE (44 7/16") (Flat Face Cowl only after serial No. 83919064)	2, 3, 4	-		1	*1270 074
19-15-60	CAGE, Thrust Bearing, w/ROLLERS, Lower (see note 1)	1	-	1		* 386 645
	Upper (see note 1)	1	-	1		* 386 645
	Lower (see note 2)	-	-	1	1	* 640 086
	Upper (see note 2)	-	-	1	1	* 376 749
19-15-63	CUP, Thrust Bearing, Lower (see note 1)	1	-	1		* 924 262
	Upper (see note 1)	1	-	1		* 386 642
	Lower (see note 2)	-	-	1	1	* 637 539
	Upper (see note 2)	-	-	1	1	* 376 751
19-19-0 STEERING GEAR SHAFT						
19-19-4	SHAFT (see note 1)	1	-	1		* 921 729
	(see note 2)	-	-	1	1	*1189 347
19-19-7	SCREW, Adjusting (see note 1)	1	-	1		* 387 110
	(see note 2)	-	-	1	1	*1188 652
	Washer, lock	-	-	1	1	* 120 898
19-19-9	NUT, Adjusting Screw (see note 1)	1	-	1		* 75 556
	(see note 2)	-	-	1	1	*1188 655
19-19-10	PLATE, Adjusting Screw Lock (see note 2)	-	-	1	1	*1188 653
19-19-16	BUSHING, Housing Bracket (see note 1)	1	-	2		* 924 257
	(see note 2)	-	-	2	2	* 857 706
19-19-24	COVER, Housing (see note 2)	-	-	1	1	*1188 677
19-19-25	SCREW, Housing Cover (5/16" - 18 x 9/16")	-	-	4	4	*1188 668
19-19-35	OIL SEAL (see note 1)	-	-	1		* 568 898
	(see note 2)	-	-	1	1	*1188 671
19-19-36	RETAINER, Oil Seal	-	-	1	1	* 568 899
19-19-40	WASHER, Thrust (see note 1)	1	-	1		* 924 263
	Adjusting Screw Thrust (see note 2)	-	-	1	1	*1188 654
19-27-0 STEERING GEAR ARM AND IDLER ARM						
19-27-2	ARM (see note 1)	1	-	1		* 921 723
	(see note 2)	-	-	1	1	*1189 351
19-27-8	NUT	-	-	1	1	*1392 770
19-27-9	WASHER, Nut Lock	-	-	1	1	* 52 855
19-30-0 STEERING WHEEL						
19-30-4	WHEEL (see note 1)	1	-	1		* 592 221
	(see note 2)	-	-	1	1	* 920 084
	Key, Woodruff	-	-	1	1	* 106 751
19-30-18	NUT (see note 1)	-	-	1		* 565 784
	(see note 2)	-	-	1	1	* 564 330
19-31-0 STEERING POST BRACKET						
19-31-1	BRACKET	-	-	1	1	* 966 461
	Bolt, 3/8" - 24 x 3/4"	-	-	2	2	* 181 635
	Nut	-	-	2	2	* 120 369
	Washer, lock	-	-	2	2	* 120 382
19-31-6	WASHER, to Dash Screw Plain	-	-	2	2	* 56 990
19-31-33	CLAMP, to Instrument Panel	1, 2	-	1	1	* 950 713
	Bolt, 3/8" - 24 x 1"	-	-	2	2	* 181 637
	Nut	-	-	2	2	* 120 369

★ Indicates use as required

☐ Indicates parts not listed in any previous parts books.

Series No. (1 indicates B-1 Series) (2 indicates B-2 Series) (3 indicates B-3 Series) (4 indicates B-4 Series)

Series No. (1 indicates C-1 Series) (3 indicates C-3 Series)

Where dash (-) is shown in Series Column Part is for All.

Prices and specifications subject to change without notice.

* Indicates change or addition.

Printed in U.S.A.

