

GROUP 15 - HOOD

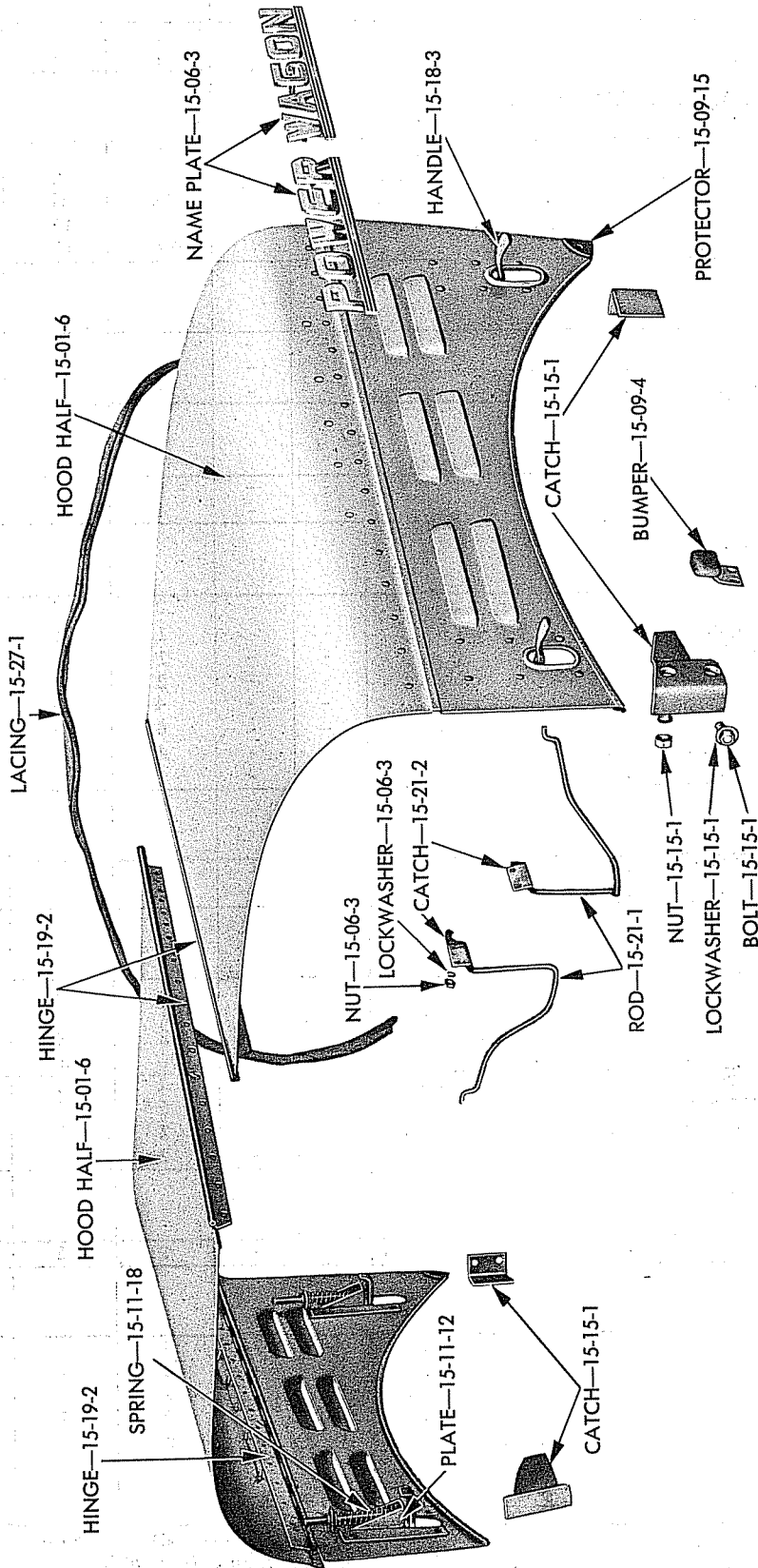

19x6055

HOOD

Plate 15-1

**POWER WAGON PARTS LIST**

HOOD

CODE	PART NAME AND DESCRIPTION	B SERIES NO.	C SERIES NO.	MODEL CODES		PART NO.
				WDX	PW	
<b>15-01-0 HOOD</b>						
15-01-6	HOOD HALF, Right	-	-	1	1	*1095 425
	Left	-	-	1	1	*1095 426
<b>15-06-0 HOOD NAME PLATE OR MEDALLION</b>						
15-06-3	PLATE (Power)	-	-	2	2	*1095 888
	(Wagon)	-	-	2	2	*1095 889
	Nut	1, 2, 3	-	12	12	* 120 375
	Nut	4	-	12	12	* 177 758
	Washer, lock	-	-	12	12	* 120 380
<b>15-09-0 HOOD BUMPER</b>						
15-09-4	BUMPER, Hood	-	-	1	1	* 920 986
	Washer, plain	-	-	1	1	* 131 015
15-09-15	PROTECTOR, Corner Rear	-	-	2	2	* 466 130
<b>15-11-0 HOOD LOCK</b>						
15-11-12	PLATE	-	-	4	4	* 797 127
15-11-18	SPRING	-	-	4	4	* 797 074
<b>15-15-0 HOOD LOCK CATCH</b>						
15-15-1	CATCH, Dash	-	-	2	2	* 797 190
	Radiator Shell, Right	-	-	1	1	* 921 410
	Left	-	-	1	1	* 921 411
	Bolt, 5/16" - 18 x 3/4"	-	-	2	2	* 180 077
	Nut	-	-	4	4	* 120 375
	Washer, lock	-	-	6	6	* 120 214
	Screw or Bolt, 5/16" - 18 x 1"	-	-	4	4	* 133 837
	Rivet	-	-	4	4	* 104 266
<b>15-18-0 HOOD HANDLE</b>						
15-18-3	HANDLE, Lock (includes PLUNGER)	-	-	4	4	* 991 212
15-18-4	WASHER, Lock Handle	-	-	4	4	* 797 781
<b>15-19-0 HOOD HINGE</b>						
15-19-2	HINGE, Upper Male	-	-	1	1	*1095 436
	Female	-	-	1	1	*1095 435
	Side	-	-	2	2	* 950 574
	Rivet	-	-	60	60	* 118 140
15-19-27	SUPPORT, Front Hinge (chrome)	-	-	1	1	* 939 187
	Rear Hinge (chrome)	-	-	1	1	* 939 188
15-19-28	SHIM, Hinge Rear Support to Cowl	-	-	2	2	* 950 799
15-19-29	SCREW, Hinge Support (5/16" - 24 x 5/8")	-	-	2	2	*1197 793
<b>15-20-0 HOOD HINGE ROD</b>						
15-20-1	ROD, Side	-	-	2	2	* 950 665
<b>15-21-0 HOOD PROP</b>						
15-21-1	ROD, Right	-	-	1	1	* 950 755
	Left	-	-	1	1	* 950 756
15-21-2	CATCH, Dash	-	-	1	1	*1095 365
15-21-10	BRACKET, Upper Panel	-	-	2	2	* 950 773
	Rivet	-	-	8	8	* 136 135

★ Indicates use as required

□ Indicates parts not listed in any previous parts books.

Series No. (1 indicates B-1 Series) (2 indicates B-2 Series) (3 indicates B-3 Series) (4 indicates B-4 Series)

Series No. (1 indicates C-1 Series) (3 indicates C-3 Series)

Where dash (-) is shown in Series Column Part is for All.

Prices and specifications subject to change without notice.

\* Indicates change or addition.

Printed in U.S.A.

April 30, 1956 Supersedes Jan. 30, 1953.



**POWER WAGON PARTS LIST**

**HOOD**

CODE	PART NAME AND DESCRIPTION	B	C	MODEL CODES		PART NO.
		SERIES NO.	SERIES NO.	WDX	PW	

**NOTES**

Blank lined area for notes.

★ Indicates use as required

☐ Indicates parts not listed in any previous parts books.

Series No. (1 indicates B-1 Series) (2 indicates B-2 Series) (3 indicates B-3 Series) (4 indicates B-4 Series)

Series No. (1 indicates C-1 Series) (3 indicates C-3 Series)

Where dash (-) is shown in Series Column Part is for All.

Prices and specifications subject to change without notice.

\* Indicates change or addition.

Printed in U.S.A.

April 30, 1956 Supersedes Jan. 30, 1953.