

GROUP 11 - EXHAUST

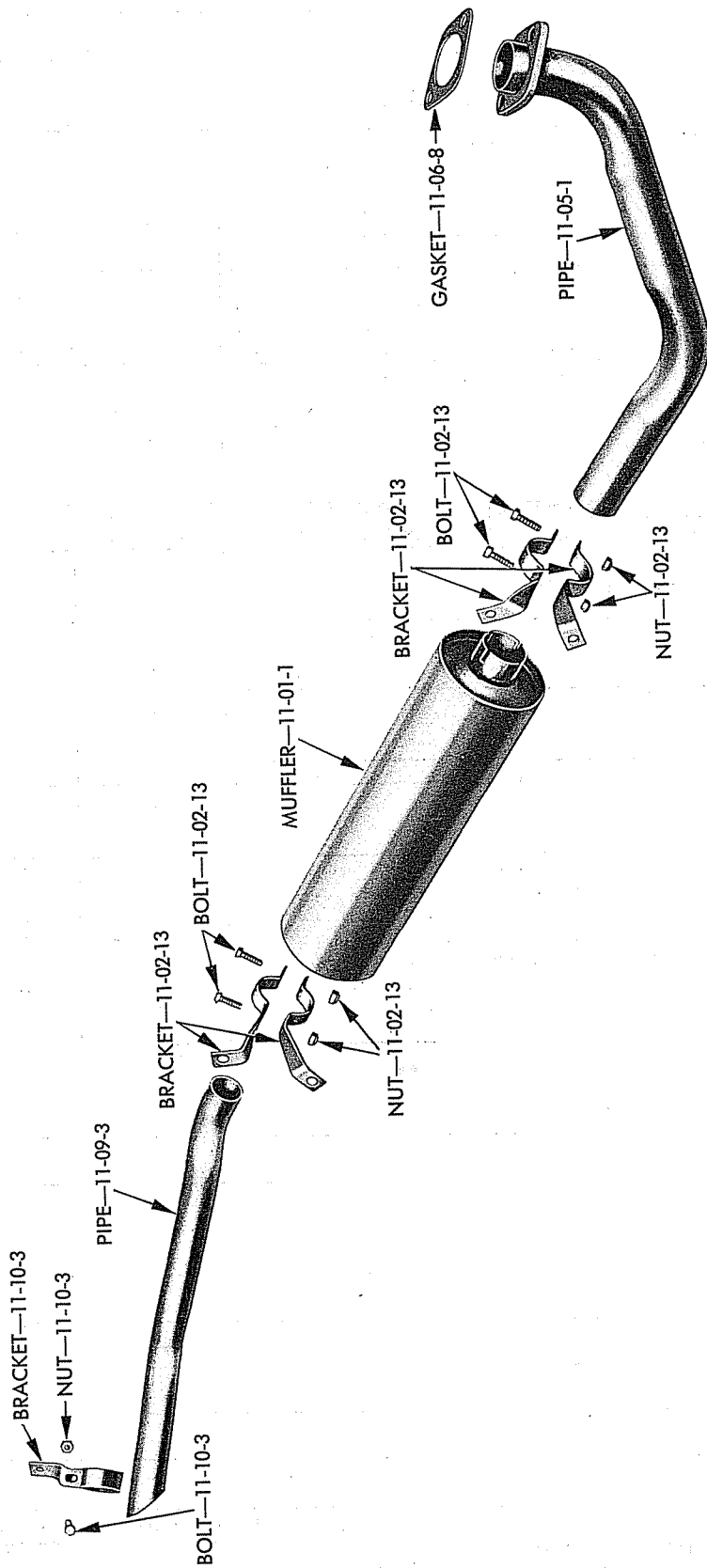

19x6208

EXHAUST SYSTEM

Plate 11-1

POWER WAGON PARTS LIST

EXHAUST

CODE	PART NAME AND DESCRIPTION	B SERIES NO.	C SERIES NO.	MODEL CODES		PART NO.
				WDX	PW	
11-01-0 MUFFLER						
11-01-1	MUFFLER	-	-	1	1	*1196 812
11-02-0 MUFFLER SUPPORT AND BRACKET						
11-02-13	BRACKET, Front, Upper	-	-	1	1	*1189 289
	Lower	-	-	1	1	*1189 290
	Rear, Upper	-	-	1	1	* 921 966
	Lower	-	-	1	1	* 921 967
	Bolt, 5/16"-24 x 1"	-	-	4	4	* 181 608
	Washer, lock	-	-	4	4	* 120 214
	Bolt, 3/8"-24 x 1 1/4" (to frame) (front)	-	-	1	1	* 181 639
	Bolt, 3/8"-24 x 1 1/2" (to frame) (front)	-	-	1	1	* 181 643
	Nut	-	-	2	2	* 120 369
	Washer, lock	-	-	2	2	* 120 382
	Bolt, 1/2"-20 x 1 1/4" (to frame) (rear)	-	-	2	2	* 181 698
	Nut	-	-	2	2	* 120 371
	Washer, lock	-	-	2	2	* 120 384
11-02-20	NUT, Clamp Bolt	-	-	4	4	*1088 964
11-05-0 EXHAUST PIPE						
11-05-1	PIPE (up to serial No. 83912231 Det. - 88760048 S.L.)	-	-	1	1	* 921 190
	(after serial No. 83912231 Det. - 88760048 S.L.)	-	-		1	*1265 910
11-06-0 EXHAUST PIPE FLANGE						
11-06-3	NUT, Bolt	-	-	2	2	*1088 961
	Bolt, 7/16"-20 x 1 3/4"	-	-	1	1	* 181 672
11-06-8	GASKET	-	-	1	1	*1557 290
11-09-0 TAIL PIPE						
11-09-3	PIPE, Tail	-	-	1	1	*1189 287
11-10-0 TAIL PIPE SUPPORT						
11-10-3	BRACKET	-	-	1	1	*1092 180
	Bolt, 5/16"-24 x 1" (clamp)	-	-	1	1	* 181 608
	Nut	-	-	1	1	* 120 368
	Washer, lock	-	-	1	1	* 120 214
	Bolt, 5/16"-24 x 1 1/4" (to frame)	-	-	1	1	* 181 610
	Nut	-	-	1	1	* 120 368
	Washer, lock	-	-	1	1	* 120 214

NOTES

★ Indicates use as required

□ Indicates parts not listed in any previous parts books.

Series No. (1 indicates B-1 Series) (2 indicates B-2 Series) (3 indicates B-3 Series) (4 indicates B-4 Series)

Series No. (1 indicates C-1 Series) (3 indicates C-3 Series)

Where dash (-) is shown in Series Column Part is for All.

Prices and specifications subject to change without notice.

* Indicates change or addition.

Printed in U.S.A.

April 30, 1956 Supersedes Jan. 30, 1953.