

GROUP 12 - FENDERS AND SHEET METAL

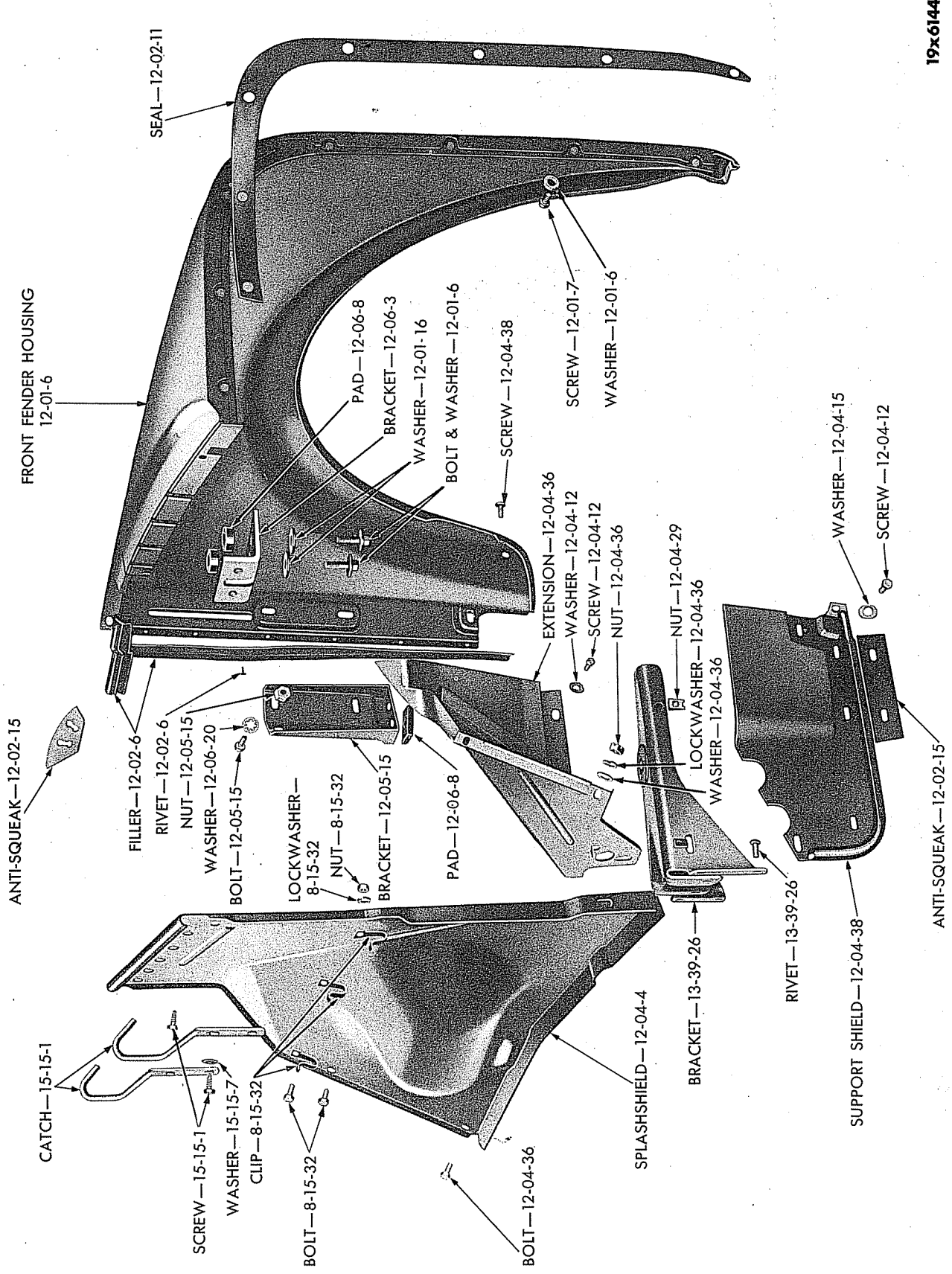

19x6144

FRONT FENDER HOUSING AND SHIELDS (B, C AND D) (EXPLODED VIEW)

Plate 12-1

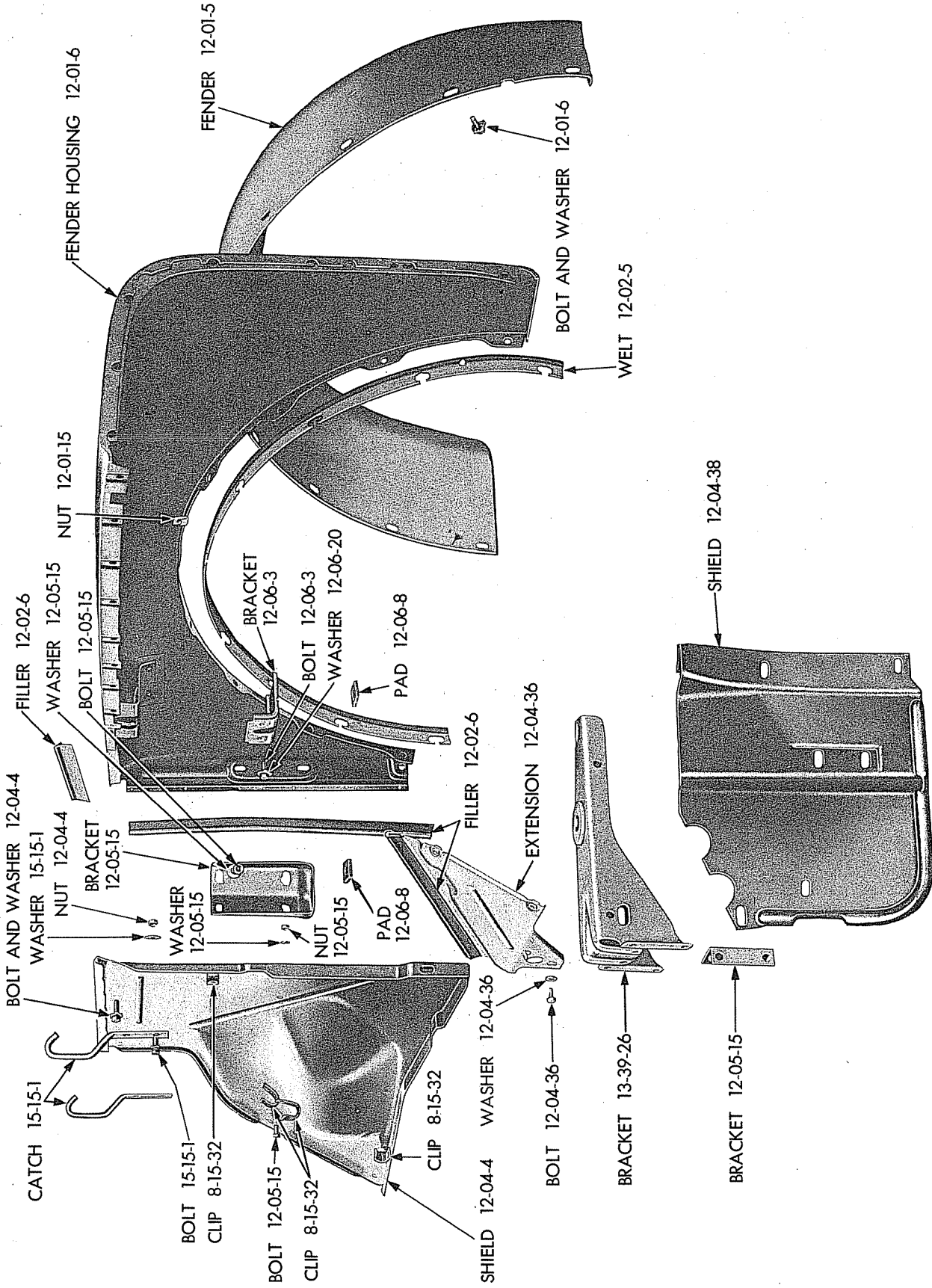

19x6107

FRONT FENDER AND SHIELDS (EXCEPT B, C AND D) (EXPLODED VIEW)

Plate 12-2

CODE	PART NAME AND DESCRIPTION	SERIES NO.	MODEL CODES														PART NO.			
			B	C	D	F	G	H & HH	FM	GM	HM & HHM	J	JM	K	KM	R		T	V	Y
FRONT FENDERS																				
Note: For front fenders on B, C and D Models use front fender housing Part Type Code 12-01-6.																				
12-01-5	FENDER, Right	-	-	-	-	1	1	1	1	1	1	1	1	1	1	1	1	1	1	1097 991
	Left	-	-	-	-	1	1	1	1	1	1	1	1	1	1	1	1	1	1	1097 997
12-01-6	HOUSING, Right	-	1	1	1	-	-	-	-	-	-	-	-	-	-	-	-	-	-	1097 992
	Left	-	1	1	1	-	-	-	-	-	-	-	-	-	-	-	-	-	-	1097 998
	Bolt, 3/8"-24 x 1	-	★	★	★	★	★	★	★	★	★	★	★	★	★	★	★	★	★	1097 508
	3/8"-24 x 1 3/4"	-	★	★	★	★	★	★	★	★	★	★	★	★	★	★	★	★	★	1097 661
	5/16"-24 x 3/4"	-	14	14	14	14	14	14	14	14	14	14	14	14	14	14	14	14	14	1097 661
	Nut	-	★	★	★	★	★	★	★	★	★	★	★	★	★	★	★	★	★	1197 221
	Washer, plain	-	★	★	★	★	★	★	★	★	★	★	★	★	★	★	★	★	★	1097 669
12-01-12	SCREW, Fender and Housing (5/16"-10 x 3/4")	-	★	★	★	★	★	★	★	★	★	★	★	★	★	★	★	★	★	1276 273
	Housing to Cowl (5/16"-10 x 1/2")	-	-	-	-	-	-	-	2	2	2	-	2	-	2	-	-	-	-	1097 509
	Fender to Cowl	3, 4	-	-	-	-	-	-	8	8	-	8	-	8	-	-	-	-	-	1097 662
	Housing to Cowl	3, 4	-	-	-	-	-	-	2	2	-	2	-	2	-	-	-	-	-	1197 222
	Washer, plain	-	★	★	★	★	★	★	★	★	★	★	★	★	★	★	★	★	★	1097 670
12-01-15	NUT, Housing to Body Support Shield to Support Screw	-	2	2	2	2	2	-	-	-	2	-	2	-	2	2	2	2	2	1276 274
	Fender and Housing Screw	-	★	★	★	★	★	-	8	8	8	-	8	-	8	-	-	-	-	120 647
	To Cowl Screw	-	-	-	-	-	-	-	8	8	-	8	-	8	-	-	-	-	-	120 668
	Housing to Cowl Screw	-	-	-	-	-	-	-	2	2	-	2	-	2	-	-	-	-	-	120 741
	To Side Lower Panel Screw	-	-	-	-	-	-	-	6	6	-	6	-	6	-	-	-	-	-	120 368
	Housing to Cowl Screw	3, 4	-	-	-	-	-	-	2	2	-	2	-	2	-	-	-	-	-	148 232
	Fender to Cowl	3, 4	-	-	-	-	-	-	8	8	-	8	-	8	-	-	-	-	-	120 387
12-01-16	WASHER, to Side Lower Panel Screw Lock	-	-	-	-	-	-	-	6	6	-	6	-	6	-	-	-	-	-	1096 643
	Housing Upper to Lower Splash Shield Screw	-	-	-	-	-	-	-	8	8	-	8	-	8	-	-	-	-	-	1197 980
	To Fender Housing, Lock	-	-	-	-	-	-	-	-	-	-	-	-	-	-	-	-	-	-	1279 617
	Housing to Cowl Bracket Screw Plain	-	4	4	4	4	4	-	-	-	4	-	4	-	4	4	4	4	4	1279 617
12-01-48	SPACER, to Body Support Shield to Fender Housing Screw	-	-	-	-	-	-	-	-	-	-	-	-	-	2	2	2	2	2	120 387
FRONT FENDER LINER-WELT-FILLER-SEAL-ANTI-SQUEAK																				
12-02-5	WELT, to Fender Housing	-	-	-	-	★	★	★	★	★	★	★	★	★	★	★	★	★	★	356 513
12-02-6	FILLER, Housing to Cowl, w/Wire REINFORCEMENT (serviced by the foot)	1, 2	★	★	★	★	★	-	-	-	★	-	★	-	★	★	★	★	-	1097 571
	Housing to Cowl (all rubber)	2, 3, 4	2	2	2	2	2	-	-	-	2	-	2	-	2	2	2	2	-	1276 495
12-02-11	SEALER, Housing to Radiator Grille Panel (serviced by the foot) (Butyl)	1	★	★	★	★	★	★	-	★	★	★	-	★	★	★	★	★	-	1242 974

★Indicates use as required.

Prices and specifications subject to change without notice.

☐Indicates parts not listed in any previous parts books.

Series No. (1 indicates B-1 Series) (2 indicates B-2 Series) (3 indicates B-3 Series) (4 indicates B-4 Series)

Where no Series No. is shown part is for B-1, B-2, B-3 and B-4 Series.

CODE	PART NAME AND DESCRIPTION	SERIES NO.	MODEL CODES													PART NO.			
			B	C	D	F	G	H & HH	FM	GM	HM & HHM	J	JM	K	KM		R	T	V
FRONT FENDER LINER-WELT-FILLER-SEAL-ANTI-SQUEAK - Cont'd																			
12-02-11	SEALER, Housing to Radiator Grille Panel (serviced by the foot) (rubber)	-	*	*	*	*	*	*	*	*	*	*	*	*	*	*	*	*	1199 032
12-02-15	ANTI-SQUEAK, Fender Housing (serviced by the foot)	-	-	-	-	*	*	*	*	*	*	*	*	*	*	*	*	313 073	
	Step to Underbody Sill Panel (serviced by the foot)	-	-	-	-	*	*	*	*	*	*	*	*	*	*	*	*	313 073	

FRONT FENDER SPLASH SHIELD

Note 1: Used as follows:

- B-1-B up to serial No. 82086215 except on 82084657 thru 82084722, 82084926 thru 82084931, 82085401 thru 82085478, 82086001 thru 82086150.
- B-1-C up to serial No. 83322304.
- B-1-D up to serial No. 81265710 except on 81264660 thru 81264683 and 81265512 thru 81265571.
- B-1-F and B-1-H up to serial No. 80348277 except 80347301 thru 80347460, 80347462 thru 80347501 and 80347550 thru 80347649.
- B-1-J up to serial No. 82552855 except on 82552427 thru 82552446 and 82552556 thru 82552559.
- B-1-R up to serial No. 81856754.
- B-1-T and B-1-V up to serial No. 81790872.

Note 2: Used as follows:

- B-1-B after serial No. 82086215 also on 82084657 thru 82084722, 82084926 thru 82084931, 82085401 thru 82085478 and 82086001 thru 82086150.
- B-1-C after serial No. 83322304.
- B-1-D after serial No. 81265710 also on 81264660 thru 81264683 and 81265512 thru 81265571.
- B-1-F and B-1-H after serial No. 80348277 also on 80347301 thru 80347460, 80347462 thru 80347501 and 80347550 thru 80347649.
- B-1-J after serial No. 82552855 also on 82552427 thru 82552446 and 82552556 thru 82552559.
- B-1-R after serial No. 81856754.
- B-1-T and B-1-V after serial No. 81790872.

12-04-4	SHIELD, Right	-	1	1	1	1	1	1	-	-	-	1	-	1	-	1	1	1	-	1097 896
	Upper Right	-	-	-	-	-	-	-	1	1	1	-	1	-	1	-	-	-	-	1197 474
	Lower Right	-	-	-	-	-	-	-	1	1	1	-	1	-	1	-	-	-	-	1197 512
	Right	-	-	-	-	-	-	-	-	-	-	-	-	-	-	-	-	-	1	1276 300
	Left	-	1	1	1	1	1	1	-	-	-	1	-	1	-	1	1	1	-	1097 897
	Upper Left	-	-	-	-	-	-	-	1	1	1	-	1	-	1	-	-	-	-	1197 475
	Lower Left	-	-	-	-	-	-	-	1	1	1	-	1	-	1	-	-	-	-	1197 513
	Left	-	-	-	-	-	-	-	-	-	-	-	-	-	-	-	-	-	1	1276 301
	Bolt, 5/16"-24 x 3/4"	-	*	*	*	*	*	*	*	*	*	*	*	*	*	*	*	*	*	120 741
	Nut	-	*	*	*	*	*	*	*	*	*	*	*	*	*	*	*	*	*	120 368
	Washer, plain	-	*	*	*	*	*	*	*	*	*	*	*	*	*	*	*	*	*	120 387
12-04-12	SCREW, Housing and Fender (5/16"-10 x 3/4")	-	*	*	*	*	*	*	*	*	*	*	*	*	*	*	*	*	*	1096 643
	Splash Shield to Fender Housing (5/16"-24 x 1")	3,4	-	-	-	-	-	-	*	*	-	*	-	*	-	-	-	-	-	1279 617
	Rear Extension to Fender Housing (5/16"-24 x 1")	3,4	-	-	-	-	-	-	-	-	-	-	-	-	-	4	4	4	4	1279 617
	Washer, plain	-	*	*	*	*	*	*	*	*	*	*	*	*	*	*	*	*	*	120 387
12-04-15	WASHER, to Radiator Grille Panel Side Support Screw Lock	-	2	2	2	2	2	2	-	-	-	2	-	2	-	2	2	2	2	1097 771
	To Frame Bracket Screw	-	-	-	-	-	-	-	4	4	4	-	4	-	4	-	-	-	-	1097 771
	Fender and Housing Screw Lock	-	*	*	*	*	*	*	*	*	*	*	*	*	*	*	*	*	*	1093 272

★ Indicates use as required.

Prices and specifications subject to change without notice.

☐ Indicates parts not listed in any previous parts books.

Series No. (1 indicates B-1 Series) (2 indicates B-2 Series) (3 indicates B-3 Series) (4 indicates B-4 Series)

Where no Series No. is shown part is for B-1, B-2, B-3 and B-4 Series.

Printed in U.S.A.

CODE	PART NAME AND DESCRIPTION	SERIES NO.	MODEL CODES																PART NO.
			B	C	D	F	G	H & HH	FM	GM	HM & HHM	J	JM	K	KM	R	T	V	
FRONT FENDER SPLASH SHIELD - Cont'd																			
12-04-19	ANTI-SQUEAK, Housing to Body Support Shield to Running Board (serviced by the foot) . . .	-	★	★	★	-	-	-	-	-	-	-	-	-	-	-	-	-	313 073
12-04-23	SEAL, Rear Extension	-	★	★	★	★	★	★	-	-	-	★	-	★	-	★	★	★	1097 571
	Rivet	-	10	10	10	10	10	10	-	-	-	10	-	10	-	10	10	10	136 696
	Washer, plain	-	10	10	10	10	10	10	-	-	-	10	-	10	-	10	10	10	120 391
12-04-29	NUT, Fender and Housing To Radiator Grille Panel Side Support Screw	-	★	★	★	★	★	★	★	★	★	★	★	★	★	★	★	★	1096 644
	Housing to Cowl Screw	-	2	2	2	2	2	2	-	-	-	2	-	2	-	2	2	2	1197 429
12-04-33	Bracket, to Frame	-	-	-	-	-	-	-	2	2	2	-	2	-	2	-	-	-	1197 429
	Rear Extension to Frame	-	-	-	-	-	-	-	2	2	2	-	2	-	2	-	-	-	1197 516
	Bolt, 5/16"-24 x 3/4"	-	-	-	-	-	-	-	4	4	4	-	4	-	4	-	-	-	1276 385
	Nut	-	-	-	-	-	-	-	4	4	4	-	4	-	4	-	-	-	120 741
	Washer, plain	-	-	-	-	-	-	-	4	4	4	-	4	-	4	-	-	-	120 368
12-04-36	EXTENSION, Rear, Right (see note 1)	1	1	1	1	1	-	1	-	-	-	1	-	-	-	-	-	-	1199 754
	(see note 2)	1	1	1	1	1	-	1	-	-	-	1	-	-	-	-	-	-	1199 754
	Left	2,3,4	1	1	1	1	1	1	-	-	-	1	-	1	-	-	-	-	1199 754
	Right (see note 1)	1	-	-	-	-	-	-	-	-	-	-	-	-	1	1	1	-	1199 755
	(see note 2)	1	-	-	-	-	-	-	-	-	-	-	-	-	1	1	1	-	1197 930
	Left	2,3,4	-	-	-	-	-	-	-	-	-	-	-	-	1	1	1	-	1199 760
	Right	2,3,4	-	-	-	-	-	-	-	-	-	-	-	-	1	1	1	-	1199 760
	Left	1	-	-	-	-	-	-	-	-	-	-	-	-	1	1	1	-	1199 761
	Right	2,3,4	-	-	-	-	-	-	-	-	-	-	-	-	1	1	1	-	1199 761
	Left	-	-	-	-	-	-	-	-	-	-	-	-	-	-	-	-	1	1276 286
	Bolt, 3/8"-24 x 1" (to frame)	-	2	2	2	2	2	2	-	-	-	2	-	2	-	2	2	2	1276 287
	Nut	-	2	2	2	2	2	2	-	-	-	2	-	2	-	2	2	2	120 647
	Washer, lock	-	2	2	2	2	2	2	-	2	-	2	-	2	-	2	2	2	120 369
	Plain	-	2	2	2	2	2	2	-	-	-	2	-	2	-	2	2	2	120 382
	Bolt, 5/16"-24 x 3/4" (to shield)	-	4	4	4	4	4	4	-	-	-	4	-	4	-	4	4	4	120 394
	Nut	-	4	4	4	4	4	4	-	-	-	4	-	4	-	4	4	4	120 741
12-04-38	SHIELD, Housing to Body Support, Right	-	1	1	1	-	-	-	-	-	-	-	-	-	-	-	-	-	1197 603
	Left	-	1	1	1	-	-	-	-	-	-	-	-	-	-	-	-	-	1197 604
	Right	-	-	-	-	1	1	1	-	-	-	1	-	1	-	-	-	-	1197 607
	Left	-	-	-	-	1	1	1	-	-	-	1	-	1	-	-	-	-	1197 608
	Right	-	-	-	-	-	-	-	-	-	-	-	-	-	1	1	1	1	1197 611
	Left	-	-	-	-	-	-	-	-	-	-	-	-	-	1	1	1	1	1197 612
	Bolt, 5/16"-24 x 3/4"	-	2	2	2	2	2	2	-	-	-	2	-	2	-	2	2	2	120 741
	5/16"-24 x 1 3/4"	-	2	2	2	2	2	2	-	-	-	2	-	2	-	2	2	2	123 798
	Nut	-	4	4	4	4	4	4	-	-	-	4	-	4	-	4	4	4	120 368
	Washer, plain	-	2	2	2	2	2	2	-	-	-	2	-	2	-	2	2	2	120 387
FRONT FENDER SUPPORT BRACKET																			
12-05-15	BRACKET, Housing Rear Support	-	1	1	1	1	1	1	-	-	-	1	-	1	-	1	1	1	1097 628
	Housing to Body Support Shield	-	-	-	-	2	2	2	-	-	-	2	-	2	-	2	2	2	1197 617
	Bolt, 5/16"-24 x 3/4" (to running board)	-	8	8	8	8	8	8	-	-	-	8	-	8	-	8	8	8	120 741
	Nut	-	8	8	8	8	8	8	-	-	-	8	-	8	-	8	8	8	120 368
	Washer, plain	-	8	8	8	8	8	8	-	-	-	8	-	8	-	8	8	8	120 387
	Bolt, 3/8"-24 x 3/4" (to support)	-	4	4	4	4	4	4	-	-	-	4	-	4	-	4	4	4	123 520
	Nut	-	4	4	4	4	4	4	-	-	-	4	-	4	-	4	4	4	120 369
	Washer, plain	-	4	4	4	4	4	4	-	-	-	4	-	4	-	4	4	4	120 394

★Indicates use as required.

Prices and specifications subject to change without notice.

☐Indicates parts not listed in any previous parts books.

Series No. (1 indicates B-1 Series) (2 indicates B-2 Series) (3 indicates B-3 Series) (4 indicates B-4 Series)

Where no Series No. is shown part is for B-1, B-2, B-3 and B-4 Series.

CODE	PART NAME AND DESCRIPTION	SERIES NO.	MODEL CODES																PART NO.	
			B	C	D	F	G	H & HH	FM	GM	HM & HHM	J	JM	K	KM	R	T	V		Y
FRONT FENDER SUPPORT BRACKET - Cont'd																				
	Bolt, 7/16"-20 x 1 1/2"	-	2	2	2	2	2	2	-	-	-	2	-	2	-	2	2	2	2	123 852
FRONT FENDER BRACKET OR HOUSING BRACKETS																				
12-06-3	BRACKET, Housing to Cowl	-	2	2	2	2	2	2	-	-	-	2	-	2	-	2	2	2	2	1197 254
	Bolt, 3/8"-24 x 1"	-	4	4	4	4	4	4	-	-	-	4	-	4	-	4	4	4	4	120 647
	3/8"-24 x 1 3/4"	-	4	4	4	4	4	4	-	-	-	4	-	4	-	4	4	4	4	120 668
	Nut	-	8	8	8	8	8	8	-	-	-	8	-	8	-	8	8	8	8	120 369
12-06-8	PAD, Housing to Cowl Bracket (rubber)	-	★	★	★	★	★	★	-	-	-	★	-	★	-	★	★	★	★	1199 412
12-06-20	WASHER, Housing Rear Support Bracket to Frame Screw Lock . . .	-	4	4	4	4	4	4	-	-	-	4	-	4	-	4	4	4	4	1197 310
		-	4	4	4	4	4	4	-	-	-	4	-	4	-	4	4	4	4	1093 885
FRONT FENDER HOUSING BRACE																				
	Note 3: Parts were used UP TO the following serial numbers: B-3-R 81862164 B-3-T 81797444 B-3-V 8303625 B-3-Y 8695678																			
	Note 4: Parts were used AFTER the following serial numbers: B-3-R 81862164 B-3-T 81797444 B-3-V 8303625 B-3-Y 8695678																			
12-07-1	BRACE, Right	1,2	-	-	-	-	-	-	-	-	-	-	-	-	-	1	1	1	1	1199 000
	Left	1	-	-	-	-	-	-	-	-	-	-	-	-	-	1	1	1	-	1199 197
	Left	2	-	-	-	-	-	-	-	-	-	-	-	-	-	1	1	1	1	1199 001
	Right (note 3)	3	-	-	-	-	-	-	-	-	-	-	-	-	-	1	1	1	1	1279 432
	Left (note 3)	3	-	-	-	-	-	-	-	-	-	-	-	-	-	1	1	1	1	1279 433
	Right (note 4)	3,4	-	-	-	-	-	-	-	-	-	-	-	-	-	1	1	1	1	1397 753
	Left (note 4)	3,4	-	-	-	-	-	-	-	-	-	-	-	-	-	1	1	1	1	1397 754
	Bolt, 3/8"-24 x 1"	-	-	-	-	-	-	-	-	-	-	-	-	-	-	2	2	2	2	120 647
	Nut	-	-	-	-	-	-	-	-	-	-	-	-	-	-	2	2	2	2	120 369
	Washer, lock	-	-	-	-	-	-	-	-	-	-	-	-	-	-	2	2	2	2	120 382
12-07-4	WASHER, Bolt Plain	-	-	-	-	-	-	-	-	-	-	-	-	-	-	4	4	4	4	1239 880
FRONT FENDER STEP																				
12-09-1	STEP, Right	-	-	-	-	-	-	-	1	1	1	-	1	-	1	-	-	-	-	1197 350
	Left	-	-	-	-	-	-	-	1	1	1	-	1	-	1	-	-	-	-	1197 351
	Bolt, 5/16"-18 x 1" (to sill panel)	-	-	-	-	-	-	-	4	4	4	-	4	-	4	-	-	-	-	126 358
	Nut	-	-	-	-	-	-	-	4	4	4	-	4	-	4	-	-	-	-	120 376
	Washer, lock	-	-	-	-	-	-	-	4	4	4	-	4	-	4	-	-	-	-	120 214
	Bolt, 5/16"-24 x 3/4"	-	-	-	-	-	-	-	6	6	6	-	6	-	6	-	-	-	-	120 741
	Nut	-	-	-	-	-	-	-	6	6	6	-	6	-	6	-	-	-	-	120 368
	Washer, plain	-	-	-	-	-	-	-	6	6	6	-	6	-	6	-	-	-	-	120 387
12-09-2	BRACE, Right	-	-	-	-	-	-	-	1	1	1	-	1	-	1	-	-	-	-	1197 229
	Left	-	-	-	-	-	-	-	1	1	1	-	1	-	1	-	-	-	-	1197 230
	Bolt, 5/16"-18 x 1"	-	-	-	-	-	-	-	2	2	2	-	2	-	2	-	-	-	-	126 358
	Nut	-	-	-	-	-	-	-	2	2	2	-	2	-	2	-	-	-	-	120 376
	Washer, lock	-	-	-	-	-	-	-	2	2	2	-	2	-	2	-	-	-	-	120 214
	Bolt, 3/8"-24 x 1"	-	-	-	-	-	-	-	2	2	2	-	2	-	2	-	-	-	-	120 647

★Indicates use as required.

Prices and specifications subject to change without notice.

□Indicates parts not listed in any previous parts books.

Series No. (1 indicates B-1 Series) (2 indicates B-2 Series) (3 indicates B-3 Series) (4 indicates B-4 Series)

Where no Series No. is shown part is for B-1, B-2, B-3 and B-4 Series.

Printed in U.S.A.

CODE	PART NAME AND DESCRIPTION	SERIES NO.	MODEL CODES													PART NO.			
			B	C	D	F	G	H & HH	FM	GM	HM & HMM	J	JM	K	KM		R	T	V
FRONT FENDER STEP - Cont'd																			
12-09-3	Washer, lock	-	-	-	-	-	-	-	2	2	2	-	2	-	2	-	-	-	120 382
	WASHER, to Fender Housing								2	2	2	-	2	-	2	-	-	-	1097 771
	Screw Lock	-	-	-	-	-	-	-	2	2	2	-	2	-	2	-	-	-	1097 771
	To Underbody Sill Panel Screw								4	4	4	-	4	-	4	-	-	-	1097 771
	Lock	-	-	-	-	-	-	-	4	4	4	-	4	-	4	-	-	-	1093 270
	To Cowl Sill Panel Screw Lock .	-	-	-	-	-	-	-	4	4	4	-	4	-	4	-	-	-	1093 270
12-09-4	J/NUT, to Housing Screw (B-1-FM and B-1-HM up to serial No. 83509195. B-1-JM up to serial No. 8738955)	1	-	-	-	-	-	-	2	-	2	-	2	-	-	-	-	-	1197 429
12-09-5	ANTI-SQUEAK (serviced by the foot).	-	-	-	-	-	-	-	★	★	★	-	★	-	★	-	-	-	313 073

REAR FENDERS

Note 5: Used as follows:

B-1-B up to serial No. 82077664 also 82078001 thru 82078113 Detroit Built and up to 9233451 San Leandro Built. B-1-C up to serial No. 83320352 Detroit Built and up to 85503522 San Leandro Built. B-1-D up to serial No. 81261871 Detroit Built and up to 86006371 San Leandro Built.

Note 6: Used as follows:

B-1-B after serial No. 82077664 except 82078001 thru 82078113 Detroit Built and after 9233451 San Leandro Built. B-1-C after serial No. 83320352 Detroit Built and after 85503522 San Leandro Built. B-1-D after serial No. 81261871 Detroit Built and after 86006371 San Leandro Built.

12-18-5	FENDER, Rear (right) (Panel) . .	-	1	-	-	-	-	-	-	-	-	-	-	-	-	-	-	-	1197 564
	(right) (Cowl, Cab and Express)																		
	(see note 5)	1	1	1	1	-	-	-	-	-	-	-	-	-	-	-	-	-	1096 972
	(right) (Cowl, Cab and Express)																		
	(see note 6)	1	1	1	1	-	-	-	-	-	-	-	-	-	-	-	-	-	1199 509
	(right) (Cowl, Cab and Express)	2,3	1	1	1	-	-	-	-	-	-	-	-	-	-	-	-	-	1199 509
	(right) (Cowl, Cab and Express)	4	1	1	1	-	-	-	-	-	-	-	-	-	-	-	-	-	E1397 854
	(right) (Cowl, Cab and Express)																		
	(dual wheels) (up to serial No. 81263902 Det. Built and up to 86006371 S. L. Built) . .	1	-	-	1	-	-	-	-	-	-	-	-	-	-	-	-	-	1096 972
	(right) (Cowl, Cab and Express)																		
	(dual wheels) (after serial No. 81263902 Det. Built and after 86006371 S. L. Built) . .	1	-	-	1	-	-	-	-	-	-	-	-	-	-	-	-	-	1199 509
	(right) (Cowl, Cab and Express)																		
	(dual wheels)	2,3	-	-	1	-	-	-	-	-	-	-	-	-	-	-	-	-	1199 509
	(right) (Cowl, Cab and Express)																		
	(dual wheels)	4	-	-	1	-	-	-	-	-	-	-	-	-	-	-	-	-	E1397 854
	(left) (Panel)	-	1	-	-	-	-	-	-	-	-	-	-	-	-	-	-	-	1197 565
	(left) (Cowl, Cab and Express)																		
	(see note 5)	1	1	1	1	-	-	-	-	-	-	-	-	-	-	-	-	-	1096 973
	(left) (Cowl, Cab and Express)																		
	(see note 6)	1	1	1	1	-	-	-	-	-	-	-	-	-	-	-	-	-	1199 510
	(left) (Cowl, Cab and Express)	2,3	1	1	1	-	-	-	-	-	-	-	-	-	-	-	-	-	1199 510
	(left) (Cowl, Cab and Express)	4	1	1	1	-	-	-	-	-	-	-	-	-	-	-	-	-	E1397 855
	(left) (Cowl, Cab and Express)																		
	(dual wheels) (up to serial No. 81263902 Det. Built and up to 86006371 S. L. Built)	1	-	-	1	-	-	-	-	-	-	-	-	-	-	-	-	-	1096 973

★ Indicates use as required.

E Indicates parts not listed in any previous parts books.

Series No. (1 indicates B-1 Series) (2 indicates B-2 Series) (3 indicates B-3 Series) (4 indicates B-4 Series)

Where no Series No. is shown part is for B-1, B-2, B-3 and B-4 Series.

Prices and specifications subject to change without notice.

CODE	PART NAME AND DESCRIPTION	SERIES NO.	MODEL CODES														PART NO.			
			B	C	D	F	G	H & HH	FM	GM	HM & HHM	J	JM	K	KM	R		T	V	Y
REAR FENDERS - Cont'd																				
12-18-5	FENDER, Rear, (left) (Cowl, Cab and Express) (dual wheels) (after serial No. 81263902 Det. Built and after 86006371 S. L. Built)	1	-	-	1	-	-	-	-	-	-	-	-	-	-	-	-	-	-	1199 510
	(left) (Cowl, Cab and Express) (dual wheels)	2,3	-	-	1	-	-	-	-	-	-	-	-	-	-	-	-	-	-	1199 510
	(left) (Cowl, Cab and Express) (dual wheels)	4	-	-	1	-	-	-	-	-	-	-	-	-	-	-	-	-	-	E1397 855
	Bolt, 5/16"-24 x 1"	-	★	★	★	-	-	-	-	-	-	-	-	-	-	-	-	-	-	121 661
	Nut	-	★	★	★	-	-	-	-	-	-	-	-	-	-	-	-	-	-	120 368
	Washer, plain	-	★	★	★	-	-	-	-	-	-	-	-	-	-	-	-	-	-	120 387
12-18-20	SHIELD, Body to Rear Fender																			
	Front (right) (Express)	2,3	1	-	-	-	-	-	-	-	-	-	-	-	-	-	-	-	-	1276 251
	(right) (Express)	4	1	-	-	-	-	-	-	-	-	-	-	-	-	-	-	-	-	E1398 382
	(right) (Express) (116" W.B.)	3	-	1	1	-	-	-	-	-	-	-	-	-	-	-	-	-	-	1279 261
	(right) (Express) (116" W.B.)	4	-	1	1	-	-	-	-	-	-	-	-	-	-	-	-	-	-	E1398 398
	(left) (Express)	2,3	1	-	-	-	-	-	-	-	-	-	-	-	-	-	-	-	-	1276 252
	(left) (Express)	4	1	-	-	-	-	-	-	-	-	-	-	-	-	-	-	-	-	E1398 383
	(left) (Express) (116" W.B.)	3	-	1	1	-	-	-	-	-	-	-	-	-	-	-	-	-	-	1279 262
	(left) (Express) (116" W.B.)	4	-	1	1	-	-	-	-	-	-	-	-	-	-	-	-	-	-	E1398 399
	Rear (right) (Express)	2,3	1	-	-	-	-	-	-	-	-	-	-	-	-	-	-	-	-	1276 259
	Rear (right) (Express)	4	1	-	-	-	-	-	-	-	-	-	-	-	-	-	-	-	-	E1398 390
	Rear Right (Express) (116" W.B.)	3	-	1	1	-	-	-	-	-	-	-	-	-	-	-	-	-	-	1279 269
	Rear Right (Express) (116" W.B.)	4	-	1	1	-	-	-	-	-	-	-	-	-	-	-	-	-	-	E1398 406
	(left) (Express)	2,3	1	-	-	-	-	-	-	-	-	-	-	-	-	-	-	-	-	1276 260
	(left) (Express)	4	1	-	-	-	-	-	-	-	-	-	-	-	-	-	-	-	-	E1398 391
	Rear (left) (Express) (116" W.B.)	3	-	1	1	-	-	-	-	-	-	-	-	-	-	-	-	-	-	1279 270
	Rear (left) (Express) (116" W.B.)	4	-	1	1	-	-	-	-	-	-	-	-	-	-	-	-	-	-	E1398 407
	Front (right) (Express) (126" W.B.)	4	-	-	1	-	-	-	-	-	-	-	-	-	-	-	-	-	-	E1398 414
	Front (left) (Express) (126" W.B.)	4	-	-	1	-	-	-	-	-	-	-	-	-	-	-	-	-	-	E1398 415
	Rear, Right (Express) (126" W.B.)	4	-	-	1	-	-	-	-	-	-	-	-	-	-	-	-	-	-	E1398 422
	Left (Express) (126" W.B.)	4	-	-	1	-	-	-	-	-	-	-	-	-	-	-	-	-	-	E1398 423
	Bolt or Screw, 1/4" -28 x 1/2".	-	10	10	10	-	-	-	-	-	-	-	-	-	-	-	-	-	-	123 316
	Nut	-	10	10	10	-	-	-	-	-	-	-	-	-	-	-	-	-	-	120 367
	Washer, lock	-	10	10	10	-	-	-	-	-	-	-	-	-	-	-	-	-	-	120 380
12-18-22	BUMPER, Body to Rear fender																			
	Front Shield (Express)	-	4	4	6	-	-	-	-	-	-	-	-	-	-	-	-	-	-	755 675
12-18-23	BRACE, Fender Shield																			
	(right) (Express)	-	1	1	1	-	-	-	-	-	-	-	-	-	-	-	-	-	-	797 892
	(left) (Express)	-	1	1	1	-	-	-	-	-	-	-	-	-	-	-	-	-	-	797 893
	Bolt or Screw, 1/4"-28 x 1/2".	-	4	4	4	-	-	-	-	-	-	-	-	-	-	-	-	-	-	123 316
	Nut	-	4	4	4	-	-	-	-	-	-	-	-	-	-	-	-	-	-	120 367
12-18-25	WASHER, Body to Rear Fender																			
	Front Shield Brace Screw Lock (Express)	-	4	4	4	-	-	-	-	-	-	-	-	-	-	-	-	-	-	1093 270
12-18-32	WASHER, To Running Board																			
	Screw Lock	-	★	★	★	-	-	-	-	-	-	-	-	-	-	-	-	-	-	1093 272
		4	4	4	4	-	-	-	-	-	-	-	-	-	-	-	-	-	-	1093 885
	To Body Screw Lock	-	12	12	12	-	-	-	-	-	-	-	-	-	-	-	-	-	-	1093 272
12-18-34	WASHER, To Body Brace Screw																			
	Lock (Express)	4	4	4	4	-	-	-	-	-	-	-	-	-	-	-	-	-	-	1093 272
12-18-35	WASHER, To Frame Bracket																			
	Screw Lock	-	4	4	4	-	-	-	-	-	-	-	-	-	-	-	-	-	-	1093 272
12-18-40	SCREW, w/WASHER (to body)	-	20	-	-	-	-	-	-	-	-	-	-	-	-	-	-	-	-	1093 840

★Indicates use as required.

Prices and specifications subject to change without notice.

E1Indicates parts not listed in any previous parts books.

Series No. (1 indicates B-1 Series) (2 indicates B-2 Series) (3 indicates B-3 Series) (4 indicates B-4 Series)

Where no Series No. is shown part is for B-1, B-2, B-3 and B-4 Series.

Printed in U.S.A.

CODE	PART NAME AND DESCRIPTION	SERIES NO.	MODEL CODES													PART NO.			
			B	C	D	F	G	H & HH	FM	GM	HM & HHM	J	JM	K	KM		R	T	V
REAR FENDERS - Cont'd																			
12-18-40	SCREW (to body) (Express)	-	10	10	10	-	-	-	-	-	-	-	-	-	-	-	-	-	1097 090
12-18-54	BRACE, to Body (Express)	4	2	2	2	-	-	-	-	-	-	-	-	-	-	-	-	-	E1397 866
	(Express) (dual wheels)	4	-	-	2	-	-	-	-	-	-	-	-	-	-	-	-	-	E1397 881
REAR FENDER WELT-SEALER- ANTI-SQUEAK																			
12-20-4	WELT, to Running Board (Express) (serviced by the foot) (1/16" x 1 3/4")	-	★	★	★	-	-	-	-	-	-	-	-	-	-	-	-	-	356 513
	Extension to Fender (serviced by the foot) (1/16" x 1 3/4")	-	-	-	★	-	-	-	-	-	-	-	-	-	-	-	-	-	356 513
	(serviced by the foot) (1/32" x 1")	-	★	★	★	-	-	-	-	-	-	-	-	-	-	-	-	-	313 073
	To Body (serviced by the foot) (1/16" x 1 3/4")	1	★	★	★	-	-	-	-	-	-	-	-	-	-	-	-	-	356 513
12-20-5	SEALER, to Body (serviced by the foot) (3/8" x 3/32")	-	★	★	★	-	-	-	-	-	-	-	-	-	-	-	-	-	1199 032
12-20-8	FILLER, to Body (Express)	4	★	★	★	-	-	-	-	-	-	-	-	-	-	-	-	-	E1398 694
REAR FENDER BRACKET																			
12-21-1	BRACKET, to Frame (Cowl, Cab and Express)	1, 2, 3	2	-	-	-	-	-	-	-	-	-	-	-	-	-	-	-	1197 569
		4	2	-	-	-	-	-	-	-	-	-	-	-	-	-	-	-	E1398 252
	(low type Express Box)	3, 4	-	2	2	-	-	-	-	-	-	-	-	-	-	-	-	-	1197 569
	Bolt, 5/16"-24 x 1"	-	4	4	4	-	-	-	-	-	-	-	-	-	-	-	-	-	1276 249
	Nut	-	4	4	4	-	-	-	-	-	-	-	-	-	-	-	-	-	121 661
	Washer, lock	-	2	2	2	-	-	-	-	-	-	-	-	-	-	-	-	-	120 368
		-	2	2	2	-	-	-	-	-	-	-	-	-	-	-	-	-	120 214
REAR FENDER EXTENSION																			
12-24-1	EXTENSION (Cowl, Cab and Express) (dual wheels) (up to serial No. 81263902)	1	-	-	2	-	-	-	-	-	-	-	-	-	-	-	-	-	1197 739
	(after serial No. 81263902)	1	-	-	2	-	-	-	-	-	-	-	-	-	-	-	-	-	1199 525
	(Cowl, Cab and Express) (dual wheels)	2, 3	-	-	2	-	-	-	-	-	-	-	-	-	-	-	-	-	1199 525
	(Cowl, Cab and Express) (dual wheels)	4	-	-	2	-	-	-	-	-	-	-	-	-	-	-	-	-	E1397 876
	Bolt, 5/16"-24 x 1"	-	-	-	14	-	-	-	-	-	-	-	-	-	-	-	-	-	121 661
	Nut	-	-	-	14	-	-	-	-	-	-	-	-	-	-	-	-	-	120 368
	Washer, Plain	-	-	-	14	-	-	-	-	-	-	-	-	-	-	-	-	-	120 387
12-24-2	BRACKET (Cowl, Cab and Express) (dual wheels)	1, 2, 3	-	-	2	-	-	-	-	-	-	-	-	-	-	-	-	-	1197 743
	Bolt, 5/16"-24 x 1"	1, 2, 3	-	-	14	-	-	-	-	-	-	-	-	-	-	-	-	-	121 661
	Nut	1, 2, 3	-	-	14	-	-	-	-	-	-	-	-	-	-	-	-	-	120 368
	Washer, plain	1, 2, 3	-	-	14	-	-	-	-	-	-	-	-	-	-	-	-	-	120 387
12-24-4	WASHER, to Fender Screw	-	-	-	14	-	-	-	-	-	-	-	-	-	-	-	-	-	1093 272
RUNNING BOARDS																			
12-26-2	BOARD, Right (Cowl, Cab and Express)	1, 2, 3	1	-	-	-	-	-	-	-	-	-	-	-	-	-	-	-	1096 582
	(Cowl, Cab and Express)	4	1	-	-	-	-	-	-	-	-	-	-	-	-	-	-	-	E1398 273
	(Panel)	-	1	-	-	-	-	-	-	-	-	-	-	-	-	-	-	-	1096 588

★ Indicates use as required.

E Indicates parts not listed in any previous parts books.

Series No. (1 indicates B-1 Series) (2 indicates B-2 Series) (3 indicates B-3 Series) (4 indicates B-4 Series)

Where no Series No. is shown part is for B-1, B-2, B-3 and B-4 Series.

Prices and specifications subject to change without notice.

CODE	PART NAME AND DESCRIPTION	SERIES NO.	MODEL CODES													PART NO.				
			B	C	D	F	G	H & HH	FM	GM	HM & HHM	J	JM	K	KM		R	T	V	Y
RUNNING BOARDS - Cont'd																				
12-26-2	BOARD, Right (short)																			
	(Cowl, Cab and Platform)	-	1	1	1	-	-	-	-	-	-	-	-	-	-	-	-	-	-	*1096 576
	(116" W. B.)																			1096 594
	(Cowl, Cab and Express)	1,2,3	-	1	-	-	-	-	-	-	-	-	-	-	-	-	-	-	-	1096 594
	(116" W. B.)																			1398 283
	(Cowl, Cab and Express)	4	1	1	-	-	-	-	-	-	-	-	-	-	-	-	-	-	-	*1398 283
	(long) (116" W. B.)	1,2,3	-	-	1	-	-	-	-	-	-	-	-	-	-	-	-	-	-	1096 594
	(long) (116" W. B.)	4	-	-	1	-	-	-	-	-	-	-	-	-	-	-	-	-	-	1398 283
	(116" W. B.) (dual wheels)																			
	(Cowl, Cab and Express)	-	-	-	1	-	-	-	-	-	-	-	-	-	-	-	-	-	-	1197 745
	(126" W. B.) (dual wheels)																			
	(Cowl, Cab and Express)	1,2,3	-	-	1	-	-	-	-	-	-	-	-	-	-	-	-	-	-	1096 600
	(126" W. B.) (dual wheels)																			
	(Cowl, Cab and Express)	4	-	-	1	-	-	-	-	-	-	-	-	-	-	-	-	-	-	1398 293
	(126" W. B.) (Express)	1,2,3	-	-	1	-	-	-	-	-	-	-	-	-	-	-	-	-	-	1096 600
	(126" W. B.) (Express)	4	-	-	1	-	-	-	-	-	-	-	-	-	-	-	-	-	-	1398 293
		-	-	-	1	1	1	-	-	-	1	-	1	-	1	1	1	1	1	1096 637
		-	-	-	-	-	1	1	1	-	1	-	1	-	1	-	-	-	-	*1197 380
BOARD, Left																				
	(Cowl, Cab and Express)	1,2,3	1	-	-	-	-	-	-	-	-	-	-	-	-	-	-	-	-	1096 583
	(Cowl, Cab and Express)	4	1	-	-	-	-	-	-	-	-	-	-	-	-	-	-	-	-	1398 274
	(Panel)	-	1	-	-	-	-	-	-	-	-	-	-	-	-	-	-	-	-	1096 589
	(short)																			
	(Cowl, Cab and Platform)	-	1	1	1	-	-	-	-	-	-	-	-	-	-	-	-	-	-	*1096 577
	(long) (116" W. B.)																			
	(Cowl, Cab and Express)	1,2,3	-	1	-	-	-	-	-	-	-	-	-	-	-	-	-	-	-	1096 595
	(long) (116" W. B.)																			
	(Cowl, Cab and Express)	4	1	1	-	-	-	-	-	-	-	-	-	-	-	-	-	-	-	*1398 284
	(long) (116" W. B.)	1,2,3	-	-	1	-	-	-	-	-	-	-	-	-	-	-	-	-	-	1096 595
	(long) (116" W. B.)	4	-	-	1	-	-	-	-	-	-	-	-	-	-	-	-	-	-	1398 284
	(long) (116" W. B.) (dual wheels)																			
	(Cowl, Cab and Express)	1,2,3	-	-	1	-	-	-	-	-	-	-	-	-	-	-	-	-	-	1096 595
	(long) (116" W. B.) (dual wheels)																			
	(Cowl, Cab and Express)	4	-	-	1	-	-	-	-	-	-	-	-	-	-	-	-	-	-	1398 284
	(long) (126" W. B.) (dual wheels)																			
	(Cowl and Cab)	1,2,3	-	-	1	-	-	-	-	-	-	-	-	-	-	-	-	-	-	1096 601
	(long) (126" W. B.) (dual wheels)																			
	(Cowl and Cab)	4	-	-	1	-	-	-	-	-	-	-	-	-	-	-	-	-	-	1398 294
	(long) (126" W. B.) (Express)	1,2,3	-	-	1	-	-	-	-	-	-	-	-	-	-	-	-	-	-	1096 601
	(long) (126" W. B.) (Express)	4	-	-	1	-	-	-	-	-	-	-	-	-	-	-	-	-	-	1398 294
		-	-	-	1	1	1	-	-	-	1	-	1	-	1	1	1	1	1	1096 638
		-	-	-	-	-	1	1	1	-	1	-	1	-	1	-	-	-	-	1197 381
	Bolt, 5/16"-24 x 3/4"	-	*	*	*	*	*	*	*	*	*	*	*	*	*	*	*	*	*	120 741
	Nut	-	*	*	*	*	*	*	*	*	*	*	*	*	*	*	*	*	*	120 368
	Washer, plain	-	*	*	*	*	*	*	*	*	*	*	*	*	*	*	*	*	*	120 387
12-26-10	WASHER, to Side Lower Panel																			
	Screw Lock	-	-	-	-	-	-	4	4	4	-	4	-	4	-	-	-	-	-	1093 272
12-26-26	NUT, Reinforcement Weld	-	*	*	*	*	*	*	*	*	*	*	*	*	*	*	*	*	*	657 413
12-26-50	EXTENSION, Right (Cowl, Cab and Express) (dual wheels)	1,2,3	-	-	1	-	-	-	-	-	-	-	-	-	-	-	-	-	-	1197 758
	(Cowl, Cab and Express) (dual wheels)	4	-	-	1	-	-	-	-	-	-	-	-	-	-	-	-	-	-	1397 884
	Left (Cowl, Cab and Express) (dual wheels)	1,2,3	-	-	1	-	-	-	-	-	-	-	-	-	-	-	-	-	-	1197 759
	(Cowl, Cab and Express) (dual wheels)	4	-	-	1	-	-	-	-	-	-	-	-	-	-	-	-	-	-	1397 885
	Bolt, 5/16"-18 x 1"	-	-	-	4	-	-	-	-	-	-	-	-	-	-	-	-	-	-	126 358
	Nut	-	-	-	4	-	-	-	-	-	-	-	-	-	-	-	-	-	-	120 376
	Washer, lock	-	-	-	4	-	-	-	-	-	-	-	-	-	-	-	-	-	-	120 214

★ Indicates use as required.

□ Indicates parts not listed in any previous parts books.

Series No. (1 indicates B-1 Series) (2 indicates B-2 Series) (3 indicates B-3 Series) (4 indicates B-4 Series)

Where no Series No. is shown part is for B-1, B-2, B-3 and B-4 Series.

April 13, 1953 Supersedes Dec. 31, 1952.

Prices and specifications subject to change without notice.

Printed in U.S.A.

* Indicates change or addition.

CODE	PART NAME AND DESCRIPTION	SERIES NO.	MODEL CODES														PART NO.				
			B	C	D	F	G	H & HH	FM	GM	HM & HHM	J	JM	K	KM	R		T	V	Y	
RUNNING BOARD - Cont'd																					
12-26-66	Washer, plain	-	-	-	4	-	-	-	-	-	-	-	-	-	-	-	-	-	-	120 396	
12-26-66	ANTI-SQUEAK, to Side Lower Panel	-	-	-	-	-	-	-	-	★	★	★	-	★	-	★	-	-	-	313 073	
ENGINE DUST PAN																					
12-31-2	PAN, Right	-	1	1	1	-	-	-	-	-	-	-	-	-	-	-	-	-	-	1195 862	
	(use w/o dual carburetors)	-	-	-	-	1	1	1	1	1	1	1	1	1	1	1	1	1	1	1195 136	
	(use with dual carburetors)	-	-	-	-	-	-	-	-	-	-	-	-	-	-	-	1	1	1	1260 688	
	Left	-	1	1	1	-	-	-	-	-	-	-	-	-	-	-	-	-	-	1267 095	
		-	-	-	1	1	1	1	1	1	1	1	1	1	1	1	1	1	1	1267 095	
		-	-	-	-	1	1	1	1	1	1	1	1	1	1	1	1	1	1	1195 515	
		-	-	-	-	-	1	1	1	1	1	1	1	1	1	1	1	1	1	1195 137	
		-	-	-	-	-	1	1	1	1	1	1	1	1	1	1	1	1	1	1196 495	
		-	-	-	-	-	-	-	-	-	-	-	-	-	1	1	1	1	1	1260 689	
		-	-	-	-	-	-	-	-	-	-	-	-	-	-	-	-	-	1	1267 442	
	Bolt, 1/4"-28 x 1"	-	★	★	★	★	★	★	★	★	★	★	★	★	★	★	★	★	★	★	123 461
	Nut	-	★	★	★	★	★	★	★	★	★	★	★	★	★	★	★	★	★	★	120 367
	Washer, lock	-	★	★	★	★	★	★	★	★	★	★	★	★	★	★	★	★	★	★	120 380
	Plain	-	★	★	★	★	★	★	★	★	★	★	★	★	★	★	★	★	★	★	120 392
	Screw, Tapping (3/8"-16 x 5/8")	-	-	-	-	1	1	1	-	-	-	1	-	1	-	-	-	-	-	271 153	
12-31-17	WASHER, to Crossmember Bracket Bolt Lock	-	-	-	-	-	-	-	1	1	1	-	1	-	1	-	-	-	-	1093 270	
	To Frame Bolt Lock	-	-	-	-	5	5	5	5	5	5	5	5	5	5	5	5	5	5	5	1093 270
12-31-35	BRACKET, to Crossmember	-	-	-	-	-	-	-	1	1	1	-	1	-	1	-	-	-	-	1196 813	
	Bolt, 1/4"-28 x 1"	-	-	-	-	-	-	-	1	1	1	-	1	-	1	-	-	-	-	123 461	
	Nut	-	-	-	-	-	-	-	1	1	1	-	1	-	1	-	-	-	-	120 367	
CAB SUPPORT DUST SHIELD																					
12-34-2	SHIELD, Right Front	-	-	-	-	-	-	-	1	1	1	-	1	-	1	-	-	-	-	1260 528	
	Rear	-	-	-	-	-	-	-	1	1	1	-	1	-	1	-	-	-	-	1260 532	
	Left Front	-	-	-	-	-	-	-	1	1	1	-	1	-	1	-	-	-	-	1260 529	
	Rear	-	-	-	-	-	-	-	1	1	1	-	1	-	1	-	-	-	-	1260 533	
	Rear	-	-	-	-	-	-	-	1	1	1	-	1	-	1	-	-	-	-	1260 535	
	Bolt, 1/4"-28 x 1"	-	-	-	-	-	-	-	★	★	★	-	★	-	★	-	-	-	-	123 461	
	Nut, lock	-	-	-	-	-	-	-	★	★	★	-	★	-	★	-	-	-	-	120 367	
12-34-4	WASHER, Bolt Lock	-	-	-	-	-	-	-	★	★	★	-	★	-	★	-	-	-	-	1093 270	
CAB HEAT SHIELD																					
12-37-2	SHIELD, Cab Underbody Heat	3, 4	-	-	-	-	-	-	-	-	-	-	-	-	-	-	-	-	-	1271 447	
	Bolt, 1/4"-28 x 1 1/4"	-	-	-	-	-	-	-	-	-	-	-	-	-	-	-	-	-	3	123 737	
	Nut	-	-	-	-	-	-	-	-	-	-	-	-	-	-	-	-	-	3	120 367	
12-37-4	WASHER, Cab Underbody Heat Shield Bolt Lock	3	-	-	-	-	-	-	-	-	-	-	-	-	-	-	-	-	3	1093 270	

NOTES

★ Indicates use as required.

Prices and specifications subject to change without notice.

☐ Indicates parts not listed in any previous parts books.

Series No. (1 indicates B-1 Series) (2 indicates B-2 Series) (3 indicates B-3 Series) (4 indicates B-4 Series)

Where no Series No. is shown part is for B-1, B-2, B-3 and B-4 Series.

CODE	PART NAME AND DESCRIPTION	SERIES NO.	MODEL CODES												PART NO.	
			B	C	D	F	G	H & HH	FM	GM	HM & HHM	J	JM	K		KM

NOTES

★Indicates use as required. Prices and specifications subject to change without notice.
 ☐Indicates parts not listed in any previous parts books.
 Series No. (1 indicates B-1 Series) (2 indicates B-2 Series) (3 indicates B-3 Series) (4 indicates B-4 Series)
 Where no Series No. is shown part is for B-1, B-2, B-3 and B-4 Series.
 December 31, 1952 Printed in U.S.A.