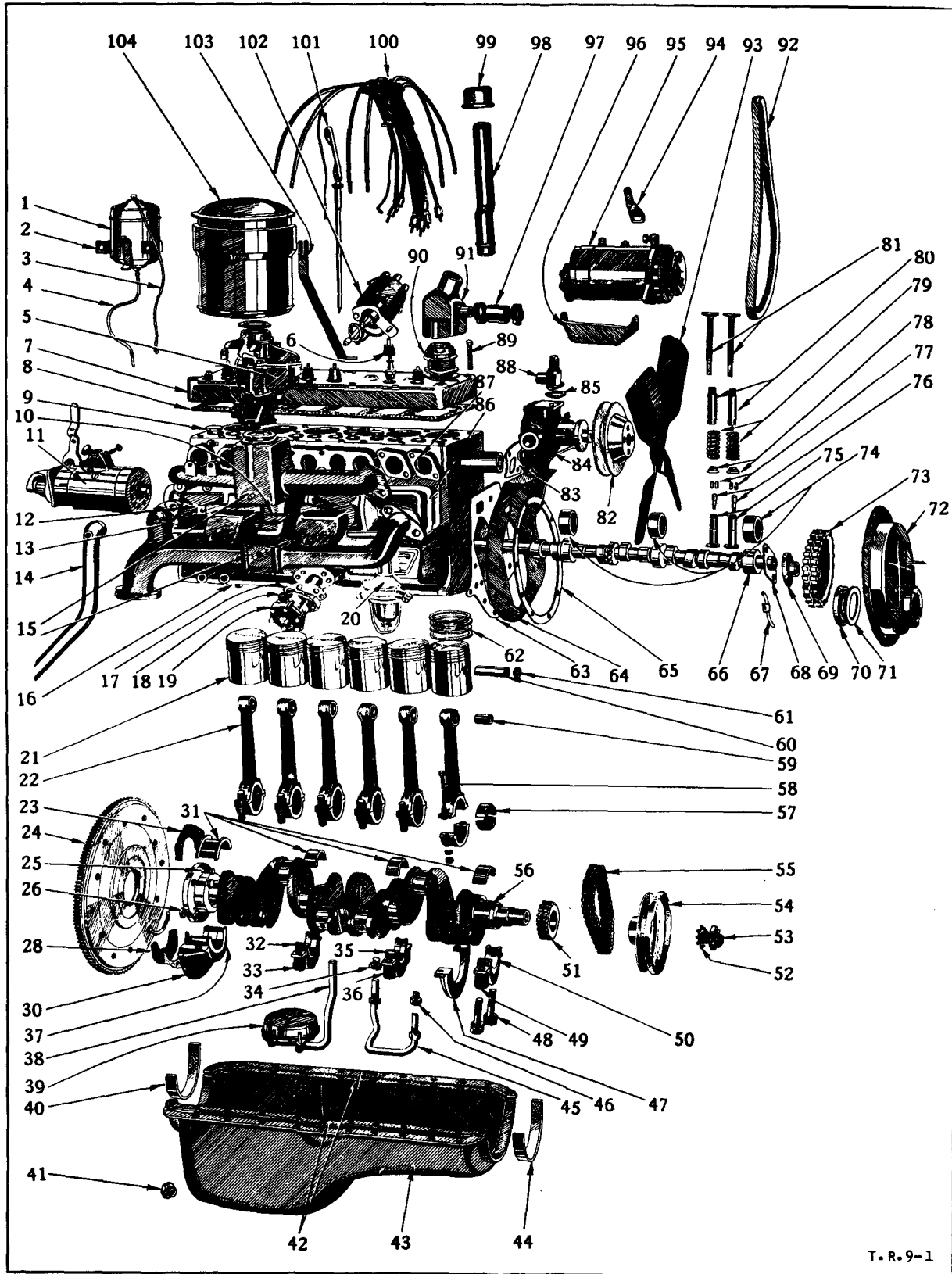

Plate 30.

ENGINE



ENGINE - Cont'd

Plate 30 (Cont'd)

Ref. No.	Part Name	Group	Ref. No.	Part Name	Group
1	Oil filter.....	10-C	53	Crankshaft starting jaw.....	9-E
2	Oil filter clamp.....	10-C	54	Crankshaft pulley.....	7-A
3	Engine to oil filter tube.....	10-C	55	Timing chain.....	9-K
4	Oil filter to engine tube.....	10-C	56	Crankshaft.....	9-E
5	Carburetor.....	14-D	57	Connecting rod bearings.....	9-G
6	Spark plug nipple.....	8-F	58	Connecting rod bolt.....	9-G
7	Cylinder head.....	9-C	59	Connecting rod bushing.....	9-G
8	Cylinder head gasket.....	9-C	60	Piston pin.....	9-I
9	Exhaust valve seat.....	9-L	61	Piston pin lock ring.....	9-I
10	Intake to exhaust manifold gasket.....	9-D	62	Piston rings.....	9-H
11	Starting motor.....	8-D	63	Chain case cover plate gasket.....	9-K
12	Valve spring cover.....	9-L	64	Chain case cover plate.....	9-K
13	Valve spring cover stud.....	9-L	65	Chain case cover gasket.....	9-K
14	Crankcase vent pipe.....	10-A	66	Camshaft.....	9-J
15	Intake and exhaust manifold.....	9-D	67	Camshaft sprocket oil tube.....	9-J
16	Cylinder block assembly.....	9-B	68	Camshaft sprocket thrust plate.....	9-J
17	Oil pump gasket.....	10-D	69	Camshaft sprocket hub.....	9-J
18	Oil pump body.....	10-D	70	Chain case cover oil seal.....	9-K
19	Oil pump cover.....	10-D	71	Chain case cover oil seal gasket.....	9-K
20	Fuel pump.....	14-H	72	Chain case cover.....	9-K
21	Pistons.....	9-H	73	Camshaft sprocket.....	9-J
22	Connecting rods.....	9-G	74	Camshaft bearings.....	9-J
23	Rear bearing oil seal assembly.....	9-E	75	Valve tappets.....	9-L
24	Flywheel.....	9-F	76	Valve tappets adjust screw.....	9-L
25	Flywheel bolt.....	9-F	77	Valve spring retainer lock.....	9-L
26	Flywheel bolt nut.....	9-F	78	Valve spring retainer.....	9-L
27			79	Valve spring.....	9-L
28	Rear bearing oil seal assembly.....	9-E	80	Valve guide.....	9-L
29			81	Valves.....	9-L
30	Crankshaft rear bearing cap.....	9-E	82	Fan pulley.....	7-A
31	Crankshaft bearings.....	9-E	83	Water pump gasket.....	7-D
32	Crankshaft bearings.....	9-E	84	Water pump.....	7-D
33	Crankshaft bearings cap - no. 3.....	9-E	85	By-pass elbow gasket.....	7-D
34	Oil pump outlet pipe nipple.....	10-D	86	Valve cover gasket.....	9-L
35	Crankshaft bearings.....	9-E	87	Manifold gaskets.....	9-D
36	Crankshaft bearings cap - no. 2.....	9-E	88	By-pass elbow.....	7-D
37	Crankshaft bearings no. 4.....	9-E	89	Cylinder head stud.....	9-C
38	Oil pump suction pipe.....	10-E	90	Thermostat.....	7-E
39	Oil strainer.....	10-E	91	Water outlet elbow.....	9-C
40	Oil pan gasket - rear.....	10-F	92	Fan belt.....	7-A
41	Oil pan drain plug.....	10-F	93	Fan.....	7-A
42	Oil pan gaskets.....	10-F	94	Generator adjust strap.....	8-B
43	Oil pan assembly.....	10-F	95	Generator.....	8-B
44	Oil pan gasket - front.....	10-F	96	Generator bracket.....	8-B
45	Oil pump outlet pipe.....	10-D	97	By - pass elbow hose.....	7-D
46	Oil pump outlet pipe nipple.....	10-D	98	Oil filler pipe.....	10-A
47	Oil pan front end oil seal plate.....	10-F	99	Oil filler cap.....	10-A
48	Crankshaft bearing cap screw.....	9-E	100	Ignition cable and tube.....	8-F
49	Crankshaft bearing cap No. 1.....	9-E	101	Oil level indicator.....	10-F
50	Crankshaft bearing.....	9-E	102	Distributor.....	8-E
51	Crankshaft sprocket.....	9-E	103	Air cleaner bracket.....	14-C
52	Crankshaft starting jaw lockwasher.....	9-E	104	Carburetor air cleaner.....	14-C

NOTES:

---



---



---



---



---



---



---



---

# FLUID COUPLING

Plate 31

9-3

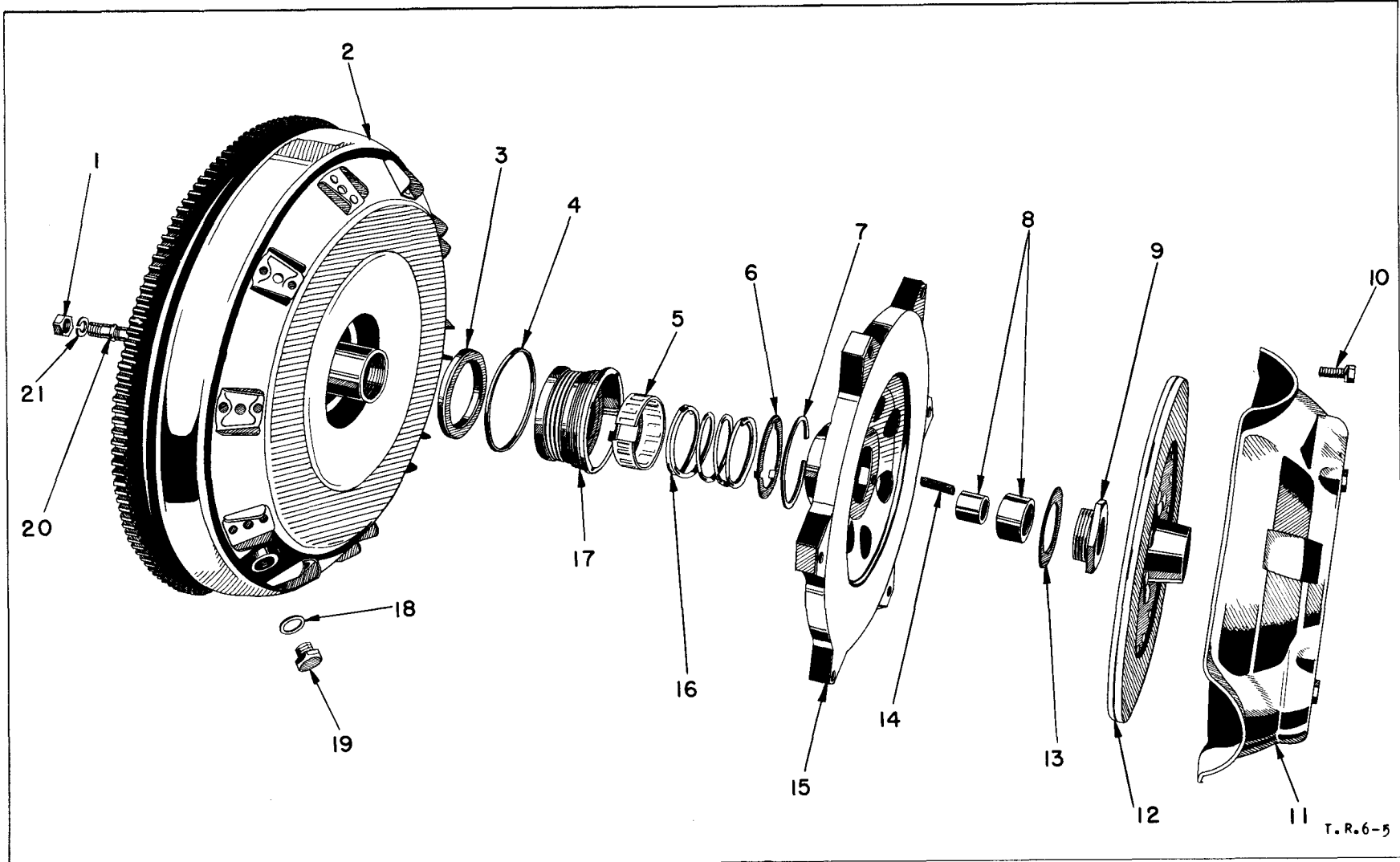

T.R.6-5

GROUP 9 - ENGINE

Ref. No.	Part Name	Group	Ref. No.	Part Name	Group	Ref. No.	Part Name	Group
1	Driver flange stud nut.....	9-F	8	Runner bushing front-rear.....	9-F	15	Driving plate.....	9-F
2	Fluid coupling assy.....	9-F	9	Driving plate nut.....	9-F	16	Seal spring.....	9-F
3	Floating seal ring.....	9-F	10	Clutch cover screw and washer.....	6-C	17	Seal assembly.....	9-F
4	Bellows retainer gasket.....	9-F	11	Clutch cover.....	6-C	18	Filler plug gasket.....	9-F
5	Seal spring damper.....	9-F	12	Clutch disc assy.....	6-B	19	Filler plug.....	9-F
6	Seal spring retainer.....	9-F	13	Driving plate nut, lock plate.....	9-F	20	Driver flange stud.....	9-F
7	Spring retainer snap ring.....	9-F	14	Driving plate key.....	9-F	21	Driver flange stud lockwasher.....	9-F

**GROUP 9-ENGINE**

**NOTE:** Parts referred to "Note 1" were used up to and including:  
 Parts referred to "Note 2" were used after the following Serial Nos. :

DG1 - 90101521  
 DG2 - 91188164

FO1 - 90520284  
 FO2 - 91509027

PART NAME	PART NO.	MODEL CODES											
		DG AND FO					DH AND FP						
		1	2	3	4	5	6	1	2	4	5	6	7
<b>GROUP 9-A POWER PLANT</b>													
<b>Engine Assembly - Less Accessories</b>													
<b>NOTE:</b> An engine assembly less accessories consists of cylinder block assembly with pistons and rings. All valve parts, crankshaft, camshaft, sprockets, chain case cover plate, flywheel, gear case cover, water pump, cylinder head, oil pan and oiling parts, and valve cover, but does not include the manifold assembly. This unit is factory tested.													
Assembly - Chryco model - 401 - - - - -	1400472	1	..	..	..	..	..	..	..	..	..	..	..
Assembly - Chryco model - 402 - - - - -	1533484	..	..	..	..	..	..	1	..	..	..	..	..
Assembly - Chryco model - 421 - - - - -	1400483	..	1	..	..	..	..	..	..	..	..	..	..
Assembly - Chryco model - 422 - - - - -	1533950	..	..	..	..	..	..	..	1	..	..	..	..
Assembly - Chryco model - 441 - - - - -	1400493	..	..	1	1	..	..	..	..	..	..	..	..
Assembly - Chryco model - 462 - - - - -	1533952	..	..	..	..	..	..	..	..	1	..	..	..
Assembly - Chryco model - 471 - - - - -	1400504	..	..	..	..	1	1	..	..	..	..	..	..
Assembly - Chryco model - 492 - - - - -	1533954	..	..	..	..	..	..	..	..	..	1	1	1
<b>Engine Gasket Package - Complete</b>													
Package - - - - -	1106549	1	1	1	1	1	1	1	1	1	1	1	1
<b>Engine Valve Grind Package</b>													
Package - - - - -	1106550	1	1	1	1	1	1	1	1	1	1	1	1
<b>GROUP 9-B CYLINDER BLOCK</b>													
<b>Cylinder Block</b>													
<b>NOTE:</b> A cylinder block assembly with pistons includes the pistons and rings fitted. All cylinder blocks include main bearing caps and valve guides. But do not include main bearings.													
Assembly - - - - -	1327339	1	1	..	..	..	..	1	1	..	..	..	..
Assembly - - - - -	1327232	..	..	1	1	..	..	..	..	..	..	..	..
Assembly - - - - -	1402525	..	..	..	..	..	..	..	..	1	..	..	..
Assembly - - - - -	1329018	..	..	..	..	1	1	..	..	..	..	..	..
Assembly - - - - -	1402526	..	..	..	..	..	..	..	..	..	1	1	1
Plug - core hole - - - - -	117924	5	5	5	5	5	5	5	5	5	5	5	5
Plug - camshaft bearing - - - - -	117923	1	1	1	1	1	1	1	1	1	1	1	1
Plug - front and rear - core plug - - -	140802	2	2	2	2	2	2	2	2	2	2	2	2
Plug - oil level - - - - -	143933	1	1	1	1	1	1	1	1	1	1	1	1
Plug - oil hole - - - - -	143932	3	3	3	3	3	3	3	3	3	3	3	3
Plug - oil distributor - - - - -	143162	2	2	2	2	2	2	2	2	2	2	2	2
Plug - rear face - - - - -	117923	1	1	1	1	1	1	1	1	1	1	1	1
Dowel - clutch housing - - - - -	1122532	2	2	2	2	2	2	2	2	2	2	2	2
Dowel package - over - size - - - - -	1316146	1	1	1	1	1	1	1	1	1	1	1	1
Tube - water distributor - - - - -	1119211	1	1	1	1	1	1	1	1	1	1	1	1
Drain cock - water jacket - - - - -	103647	1	1	1	1	1	1	1	1	1	1	1	1
Oil retainer - ignition distributor - -	41928	1	1	1	1	1	1	1	1	1	1	1	1

Indicates amount used as required.

† Indicates parts included in packages.

**GROUP 9-ENGINE**

PART NAME	PART NO.	MODEL CODES											
		DG AND FO					DH AND FP						
		1	2	3	4	5	6	1	2	4	5	6	7
<b>GROUP 9-C CYLINDER HEAD WITH CORE HOLE PLUG</b>													
<b>Cylinder Head</b>													
Assembly - - - - -	1327336	1	1	..	..	..	..	1	1	..	..	..	..
Assembly - export on DG1/DH1/FO1/FP1 - - - - -	1327235	1	..	1	1	..	..	1	..	..	..	..	..
Assembly - export on DG2/DG3/DG4/DH2/FO2/FO3/FO4/FP2 - - - - -	1327135	..	1	1	1	1	1	..	1	.	..	..	..
Assembly - export on DG6/FO6 - - - - -	1329297	..	..	..	..	..	1	..	..	1	..	..	..
Assembly - - - - -	1534101	..	..	..	..	..	..	..	..	1	1	..	..
Assembly - - - - -	1532611	..	..	..	..	..	..	..	..	..	..	1	1
Assembly - export - - - - -	1401525	..	..	..	..	..	..	..	..	..	..	1	..
Gasket - - - - -	†1327338	1	1	1	1	1	1	1	1	1	1	1	1
Screw - - - - -	666014	21	21	21	21	21	21	21	21	21	21	21	21
Plug - core hole - - - - -	192627	1	1	1	1	1	1	1	1	1	1	1	1
Plug - timing hole - - - - -	143932	1	1	1	1	1	1	1	1	1	1	1	1
Plug - heater hole - - - - -	103867	1	1	1	1	1	1	1	1	1	1	1	1
Plug - screw hole - - - - -	121852	1	1	1	1	1	1	1	1	1	1	1	1
Washer - - - - -	1116246	1	1	1	1	1	1	1	1	1	1	1	1
<b>Water Outlet Connector</b>													
Connector - - - - -	1404700	1	1	1	1	1	1	1	1	1	1	1	1
Gasket - - - - -	† 50082	1	1	1	1	1	1	1	1	1	1	1	1
Screw - - - - -	120233	2	2	2	2	2	2	2	2	2	2	2	2
Lockwasher - - - - -	120382	2	2	2	2	2	2	2	2	2	2	2	2
<b>GROUP 9-D MANIFOLD</b>													
<b>Manifold - Intake And Exhaust</b>													
Assembly - L.H.D. - - - - -	1116806	1	1	..	..	..	..	1	1	..	..	..	..
Assembly - R.H.D. - - - - -	1138040	1	1	..	..	..	..	1	1	..	..	..	..
Assembly - - - - -	1116676	..	..	1	1	1	1	..	..	1	1	..	..
Assembly - - - - -	1532094	..	..	..	..	..	..	..	..	..	..	1	..
Manifold - intake - - - - -	1407907	..	..	..	..	..	..	..	..	..	..	..	1
Manifold - exhaust - front - - - - -	1407905	..	..	..	..	..	..	..	..	..	..	..	1
Manifold - exhaust - rear - - - - -	1407906	..	..	..	..	..	..	..	..	..	..	..	1
Baffle - exhaust manifold - - - - -	1532096	..	..	..	..	..	..	..	..	..	..	1	..
Screw - intake to exhaust manifold - - - - -	1408763	..	..	..	..	..	..	..	..	..	..	..	8
Washer - - - - -	120394	..	..	..	..	..	..	..	..	..	..	..	8
Plug - choke hole - - - - -	121797	2	2	..	..	..	..	2	2	..	..	..	..
Gasket - - - - -	51019	2	2	..	..	..	..	2	2	..	..	..	..
Fuel centralizing ring - - - - -	1122465	..	..	1	1	1	1	..	..	1	1	1	1
<b>Manifold Gaskets</b>													
Gasket - intake to exhaust - - - - -	† 666352	1	1	1	1	1	1	1	1	1	1	1	..
Gasket - end - - - - -	† 666354	4	4	4	4	4	4	4	4	4	4	4	4
Gasket - center - - - - -	† 666353	1	1	1	1	1	1	1	1	1	1	1	1
<b>Manifold Gasket Package</b>													
Package - - - - -	780462	1	1	1	1	1	1	1	1	1	1	1	1
<b>Manifold Attaching Parts</b>													
Bolt - intake to exhaust - L.H.D. - - - - -	191039	4	4	..	..	..	..	4	4	..	..	..	..
Bolt - intake to exhaust - R.H.D. - - - - -	126167	4	4	..	..	..	..	4	4	..	..	..	..
Bolt - intake to exhaust - - - - -	126167	..	..	4	4	4	4	..	..	4	4	4	4
Nut - - - - -	114547	4	4	4	4	4	4	4	4	4	4	4	4
Stud - exhaust - - - - -	623369	4	4	4	4	4	4	4	4	4	4	4	4
Nut - - - - -	623370	4	4	4	4	4	4	4	4	4	4	4	4
Washer - - - - -	623368	4	4	4	4	4	4	4	4	4	4	4	4
Stud - short - - - - -	51561	7	7	7	7	7	7	7	7	7	7	7	7
Nut - - - - -	114547	7	7	7	7	7	7	7	7	7	7	7	7
Screw - exhaust manifold - - - - -	123913	2	2	2	2	2	2	2	2	2	2	2	2
Clamp washer - - - - -	43699	4	4	4	4	4	4	4	4	4	4	4	4
Plug - wiper hole - flat face cowl only - - - - -	143932	1	1	1	1	1	1	1	1	1	1	1	1
Reducer - wiper hole - - - - -	119932	1	1	1	1	..	..	1	1	1	..	..	..

Indicates amount used as required.

† Indicates parts included in packages.

**GROUP 9 - ENGINE**

PART NAME	PART NO.	MODEL CODES											
		DG AND FO					DH AND FP						
		1	2	3	4	5	6	1	2	4	5	6	7
<b>GROUP 9-D MANIFOLD (CONT'D)</b>													
<b>Manifold Heat Control Valve</b>													
Thermostat - - - - -	† 671923	1	1	1	1	1	1	1	1	1	1	..	..
Spacer - - - - -	† 644876	1	1	1	1	1	1	1	1	1	1	..	..
Shield - L.H.D. - - - - -	† 853624	1	1	..	..	..	..	1	1	..	..	..	..
Shield - R.H.D. - - - - -	1066053	1	1	..	..	..	..	1	1	..	..	..	..
Shield - - - - -	† 853624	..	..	1	1	1	1	..	..	1	1	..	..
Bolt - clamp - - - - -	† 862830	1	1	1	1	1	1	1	1	1	1	..	..
Nut - - - - -	120614	1	1	1	1	1	1	1	1	1	1	..	..
Lock - - - - -	† 1409594	1	1	1	1	1	1	1	1	1	1	..	..
Lockwasher - - - - -	138479	1	1	1	1	1	1	1	1	1	1	..	..
Shaft - - - - -	† 666351	1	1	1	1	1	1	1	1	1	1	..	..
Bushing - - - - -	† 651251	2	2	2	2	2	2	2	2	2	2	..	..
Plate - L.H.D. - - - - -	† 666350	1	1	..	..	..	..	1	1	..	..	..	..
Plate - R.H.D. - - - - -	† 1066023	1	1	..	..	..	..	1	1	..	..	..	..
Plate - - - - -	† 1066023	..	..	1	1	1	1	..	..	1	1	..	..
Stop assembly - - - - -	† 683057	1	1	1	1	1	1	1	1	1	1	..	..
Stud - - - - -	† 852271	1	1	1	1	1	1	1	1	1	1	..	..
<b>Manifold Heat Control Valve Package</b>													
Package - L.H.D. - - - - -	1316267	1	1	..	..	..	..	1	1	..	..	..	..
Package - - - - -	1316268	..	..	1	1	1	1	..	1	1	1	..	..
<b>GROUP 9-E CRANKSHAFT - CRANKSHAFT BEARINGS AND CAP</b>													
<b>Crankshaft</b>													
Assembly - - - - -	952145	1	..	..	..	..	..	1	..	..	..	..	..
Assembly - - - - -	955196	..	1	1	1	..	..	..	1	..	..	..	..
Assembly - - - - -	870745	..	..	..	..	1	1	..	..	1	1	..	..
Assembly - - - - -	1400438	..	..	..	..	..	..	..	..	..	1	1	1
Bushing - drive pinion pilot - - - - -	53298	1	1	1	1	1	1	1	1	1	1	1	1
Starting jaw - - - - -	583801	1	1	1	1	1	1	1	1	1	1	1	1
Lockwasher - - - - -	655116	1	1	1	1	1	1	1	1	1	1	1	1
Sprocker - - - - -	601760	1	1	1	1	1	1	1	1	1	1	1	1
Key - - - - -	124551	1	1	1	1	1	1	1	1	1	1	1	1
<b>Crankshaft Bearing Packages</b>													

NOTE: Crankshaft bearings should always be replaced in pairs. Never use an old bearing half with a new bearing half.

For all DG/FO models and DH1-2-4-5 and FP1-2-4-5				For DH6-7 and FP6-7			
Bearing Size	Pair Pkge. No. 1-2-3	Pair Pkge. No. 4	Complete Package	Bearing Size	Pair Pkge. No. 1-2-3	Pair Pkge. No. 4	Complete Package
Std.	1238448	1238449	992557	Std.	1326119	1326127	1511962
.001	1238450	1238451	992558	.001	1326120	1326128	1511963
.002	1238452	1238453	1087851	.002	1326121	1326129	1511964
.003	1450326	1450327	1511980	.003	1450335	1450336	1511965
.010	1238454	1238455	1056025	.010	1326122	1326130	1511966
.012	1238456	1238457	1056026	.012	1326123	1326131	1511967
.020	1311111	1311114	1056027	.020	1326124	1326132	1511968
.030	1311112	1311115	1056028	.030	1326125	1326133	1511969
.040	1311113	1311116	1107308	.040	1326126	1326134	1511970

Indicates amount used as required.

† Indicates parts included in packages.

**GROUP 9 - ENGINE**

PART NAME	PART NO.	MODEL CODES											
		DG AND FO						DH AND FP					
		1	2	3	4	5	6	1	2	4	5	6	7
<b>GROUP 9-E CRANKSHAFT - CRANKSHAFT BEARINGS AND CAPS (CONT'D)</b>													
<b>Crankshaft Bearing Caps</b>													
NOTE: Crankshaft bearing caps are line reamed to each individual engine at the factory. Therefore are not interchangeable. Replacement caps are supplied with stud holes reamed 1/64" larger and the overall length 1/16" shorter and must be fitted by shim or removing metal from the face of the cap as required, when line reaming equipment is not available.													
No. 1 - - - - -	664390	1	1	1	1	1	1	1	1	1	1	1	1
No. 2 - 3 - - - - -	664065	2	2	2	2	2	2	2	2	2	2	2	2
No. 4 - - - - -	891401	1	1	1	1	1	1	1	1	1	1	1	1
Cap screw - - - - -	864118	8	8	8	8	8	8	8	8	8	8	8	8
Lockwasher - - - - -	120384	8	8	8	8	8	8	8	8	8	8	8	8
<b>Crankshaft Rear Bearing Oil Seal Retainer Package</b>													
Package - - - - -	† 891458	1	1	1	1	1	1	1	1	1	1	1	1
Gasket - right - - - - -	† 863012	1	1	1	1	1	1	1	1	1	1	1	1
Gasket - left - - - - -	863013	1	1	1	1	1	1	1	1	1	1	1	1
Screw - to cylinder block - - - - -	44650	6	6	6	6	6	6	6	6	6	6	6	6
Lockwasher - - - - -	121753	6	6	6	6	6	6	6	6	6	6	6	6
<b>GROUP 9-F FLYWHEEL AND RING GEAR AND FLUID COUPLING</b>													
<b>Flywheel And Ring Gear</b>													
Assembly - - - - -	1312138	1	1	..	..	..	..	1	1	..	..	..	..
Assembly - - - - -	1312139	..	..	1	1	1	1	..	..	1	1	1	1
Ring gear - - - - -	1119993	1	1	1	1	1	1	1	1	1	1	1	1
Bolt - - - - -	871685	8	8	8	8	8	8	8	8	8	8	8	8
Nut - - - - -	675594	8	8	8	8	8	8	8	8	8	8	8	8
Lockwasher - - - - -	120383	8	8	8	8	8	8	8	8	8	8	8	8
<b>Fluid Coupling And Driving Plate</b>													
Assembly - - - - -	1321994	1	1	..	..	..	..	..	..	..	..	..	..
Plate - - - - -	1140421	1	1	..	..	..	..	..	..	..	..	..	..
Nut - - - - -	864003	1	1	..	..	..	..	..	..	..	..	..	..
Locking - plate - - - - -	864004	1	1	..	..	..	..	..	..	..	..	..	..
Key - - - - -	956442	1	1	..	..	..	..	..	..	..	..	..	..
Stud - driver flange - - - - -	1061157	8	8	..	..	..	..	..	..	..	..	..	..
Nut - - - - -	675594	8	8	..	..	..	..	..	..	..	..	..	..
Lockwasher - - - - -	136857	1	1	..	..	..	..	..	..	..	..	..	..
Filler plug - - - - -	863986	1	1	..	..	..	..	..	..	..	..	..	..
Gasket - - - - -	863987	1	1	..	..	..	..	..	..	..	..	..	..
Bushing - runner - front - - - - -	868381	1	1	..	..	..	..	..	..	..	..	..	..
Bushing - runner - rear - - - - -	868382	1	1	..	..	..	..	..	..	..	..	..	..
Gasket - seal ring - - - - -	1320556	1	1	..	..	..	..	..	..	..	..	..	..
Retainer - - - - -	1320557	1	1	..	..	..	..	..	..	..	..	..	..
Return spring - - - - -	1320558	1	1	..	..	..	..	..	..	..	..	..	..
Snap ring - return - - - - -	1320559	1	1	..	..	..	..	..	..	..	..	..	..
Seal housing - - - - -	1320560	1	1	..	..	..	..	..	..	..	..	..	..
Gasket - - - - -	854011	1	1	..	..	..	..	..	..	..	..	..	..
Seal ring - - - - -	1320561	1	1	..	..	..	..	..	..	..	..	..	..
<b>Fluid Drive Oil - Imperial Measure</b>													
One quart can - - - - -	830350	*	*	..	..	..	..	..	..	..	..	..	..
One gallon can - - - - -	830351	*	*	..	..	..	..	..	..	..	..	..	..
Five gallon can - - - - -	1103809	*	*	..	..	..	..	..	..	..	..	..	..

Indicates amount used as required.

† Indicates parts included in packages.

**GROUP 9 - ENGINE**

PART NAME	PART NO.	MODEL CODES											
		DG AND FO					DH AND FP						
		1	2	3	4	5	6	1	2	4	5	6	7
<b>GROUP 9-G CONNECTING ROD</b>													
<b>Connecting Rod</b>													
Assembly - - - - -	954446	6	..	..	..	..	..	6	..	..	..	..	..
Assembly - - - - -	1112764	..	6	6	6	..	..	..	6	..	..	..	..
Assembly - - - - -	1112765	..	..	..	..	6	6	..	..	6	6	..	..
Assembly - - - - -	1400242	..	..	..	..	..	..	..	..	..	..	6	6
<b>Connecting Rod Bearing Packages</b>													

For all DG/FO models and DH1-2-4-5 and FP1-2-4-5			For DH6-7 and FP6-7		
Bearing Size	Package For 1 Rod	Package For 6 Rods	Bearing Size	Package For 1 Rod	Package For 6 Rods
Std.	1238558	992559	Std.	1326111	1511971
.001	1238559	992560	.001	1326112	1511972
.002	1238560	1087855	.002	1326113	1511973
.003	1450328	1511981	.003	1450337	1511974
.010	1238561	1150970	.010	1326114	1511975
.012	1238562	1150971	.012	1326115	1511976
.020	1103254	1150972	.020	1326116	1511977
.030	1103255	1150973	.030	1326117	1511978
.040	1311121	1107724	.040	1326118	1511979

PART NAME	PART NO.	MODEL CODES											
		DG AND FO					DH AND FP						
		1	2	3	4	5	6	1	2	4	5	6	7
<b>GROUP 9-H PISTONS AND RINGS</b>													
<b>Connecting Rod Bearing Cap Bolt</b>													
Bolt - - - - -	860343	12	12	12	12	12	12	12	12	12	12	..	..
Bolt - - - - -	1400245	..	..	..	..	..	..	..	..	..	..	12	12
Nut - - - - -	860671	12	12	12	12	12	12	12	12	12	12	12	12
Lockwasher - - - - -	668555	12	12	12	12	12	12	12	12	12	12	12	12
<p><b>IMPORTANT - Check rings for proper gap at top and bottom of ring travel.</b></p> <p><b>NOTE: - Pistons listed below include piston pins which are factory fitted</b></p>													

For DG1-2/DH1-2/FO1-2/FP1-2 - 3 3/8" bore.						For DG3-4-5-6/DH4-5-6-7/FO3-4-5-6 FP4-5-6-7 - 3 7/16" bore.			
Pistons And Pins		Piston Ring Sets				Pistons And Pins		Piston Ring Sets	
Size	Assembly (6 Used)	Re Bore Ring Set	Re Ring Ring Set	Re Ring Alternate Set	2 in 1 Ring Set (Chrome)	Size	Assembly (6 Used)	Re Bore Ring Set	2 in 1 Ring Set (Chrome)
Std.	974084	974096	974108	974103	1107091	Std.	1326094	1104981	1107083
.005	974086	974096	974108	974103	1107091	.005	1326095	1104981	1107083
.020	974089	974098	974110	974105	1107092	.020	1326096	1104982	1107084
.030	974092	974099	974111	974106	1107093	.030	1326097	1104983	1107085
.040	974093	974100	974112	974107	1107094	.040	1326098	1104984	1107086
.060	1326094	974113	-----	-----	-----	.060	1326099	1104985	-----

**Piston Expander Package -** "U" slot pistons - 3 3/8" bore - use part no. 830539  
 "U" slot pistons - 3 7/16" bore - use part no. 1105776

Indicates amount used as required. † Indicates parts included in packages.



**GROUP 9-ENGINE**

PART NAME	PART NO.	MODEL CODES										
		DG AND FO						DH AND FP				
		1	2	3	4	5	6	1	2	4	5	6
<b>GROUP 9-I PISTON PIN</b>												
<b>Piston Pin</b>												
Pin - standard - - - - -	436658	6	6	6	6	6	6	6	6	6	6	6
Pin - .003 - - - - -	203741	6	6	6	6	6	6	6	6	6	6	6
Pin - .008 - - - - -	302560	6	6	6	6	6	6	6	6	6	6	6
Lockwire - - - - -	200434	12	12	12	12	12	12	12	12	12	12	12
<b>GROUP 9-J CAMSHAFT</b>												
<b>Camshaft</b>												
Assembly - - - - -	1067201	1	1	1	1	1	1	1	1	1	1	1
<b>Camshaft Bearing</b>												
No. 1 - - - - -	632465	1	1	1	1	1	1	1	1	1	1	1
No. 2 - - - - -	665786	1	1	1	1	1	1	1	1	1	1	1
No. 3 - - - - -	665787	1	1	1	1	1	1	1	1	1	1	1
<b>Camshaft Sprocket</b>												
Sprocket - - - - -	601757	1	1	1	1	1	1	1	1	1	1	1
Key - - - - -	114813	1	1	1	1	1	1	1	1	1	1	1
Screw - - - - -	601766	3	3	3	3	3	3	3	3	3	3	3
Lockwasher - - - - -	120214	3	3	3	3	3	3	3	3	3	3	3
Hub - - - - -	869998	1	1	1	1	1	1	1	1	1	1	1
Thrust plate - - - - -	600786	1	1	1	1	1	1	1	1	1	1	1
Screw - - - - -	122007	2	2	2	2	2	2	2	2	2	2	2
Lockwasher - - - - -	120214	1	1	1	1	1	1	1	1	1	1	1
Oil tube - - - - -	600787	1	1	1	1	1	1	1	1	1	1	1
-Clip- - - - -	120520	1	1	1	1	1	1	1	1	1	1	1
Screw - - - - -	120628	1	1	1	1	1	1	1	1	1	1	1
Lockwasher - - - - -	121753	1	1	1	1	1	1	1	1	1	1	1
<b>GROUP 9-K TIMING CHAIN - CHAIN CASE COVER AND PLATE</b>												
<b>Timing Chain</b>												
Chain - - - - -	1075001	1	1	1	1	1	1	1	1	1	1	1
<b>Chain Case Cover</b>												
Assembly - - - - -	1121215	1	1	..	..	..	..	1	1	..	..	..
Assembly - - - - -	1090742	..	..	1	1	1	1	..	..	1	1	1
Reinforcement - - - - -	690939	1	1	1	1	1	1	1	1	1	1	1
Gasket - - - - -	† 600752	1	1	1	1	1	1	1	1	1	1	1
Screw - - - - -	122017	7	7	7	7	7	7	7	7	7	7	7
Screw - - - - -	122007	1	1	1	1	1	1	1	1	1	1	1
Lockwasher - - - - -	120214	8	8	8	8	8	8	8	8	8	8	8
Bolt - - - - -	120741	3	3	3	3	3	3	3	3	3	3	3
Nut - - - - -	120368	3	3	3	3	3	3	3	3	3	3	3
Lockwasher - - - - -	120214	3	3	3	3	3	3	3	3	3	3	3
<b>Chain Case Cover Plate</b>												
Plate - - - - -	688311	1	1	..	..	..	..	1	1	..	..	..
Plate - - - - -	1116749	..	..	1	1	1	1	..	..	1	1	1
Gasket - - - - -	† 695441	1	1	1	1	1	1	1	1	1	1	1
Screw - - - - -	122007	4	4	4	4	4	4	4	4	4	4	4
Lockwasher - - - - -	120214	3	3	3	3	3	3	3	3	3	3	3
Lockwasher - - - - -	138486	1	1	1	1	1	1	1	1	1	1	1
Screw - - - - -	133837	1	1	1	1	1	1	1	1	1	1	1
Lockwasher - - - - -	120214	1	1	1	1	1	1	1	1	1	1	1
Lockwasher - - - - -	134512	..	..	1	1	..	..	..	..	1	1	..
Gasket - - - - -	114622	1	1	1	1	1	1	1	1	1	1	1
Dowel - - - - -	606345	2	2	2	2	2	2	2	2	2	2	2

Indicates amount used as required.

† Indicates parts included in packages.

GROUP 9 - ENGINE

PART NAME	PART NO.	MODEL CODES											
		DG AND FO					DH AND FP						
		1	2	3	4	5	6	1	2	4	5	6	7
<b>GROUP 9-K TIMING CHAIN - CHAIN CASE COVER AND PLATE (CONT'D)</b>													
<b>Chain Case Cover Oil Seal Package</b>													
Package - - - - -	1064730	1	1	1	1	1	1	1	1	1	1	1	1
Gasket - - - - -	†1088603	1	1	1	1	1	1	1	1	1	1	1	1
<b>GROUP 9-L VALVES AND TAPPETS</b>													
<b>VALVES</b>													
Intake - - - - -	1109912	6	6	6	6	6	6	6	6	6	6	6	6
Exhaust - - - - -	1319089	6	6	6	6	..	..	6	6	6	..	..	..
Exhaust - - - - -	1319090	..	..	..	..	6	6	..	..	..	6	6	6
Seat - exhaust - std.	1319087	6	6	6	6	6	6	6	6	6	6	6	6
Seat - exhaust - .010	1319088	6	6	6	6	6	6	6	6	6	6	6	6
Stem guide - - - - -	1124959	12	12	12	12	..	..	12	12	12	..	..	..
Stem guide - intake	1124959	..	..	..	..	6	6	..	..	..	6	6	6
Stem guide - exhaust	1139373	..	..	..	..	6	6	..	..	..	6	6	6
<b>Valve Spring</b>													
Spring - - - - -	869449	12	12	12	12	12	12	12	12	12	12	12	12
Retainer - - - - -	1313268	12	12	12	12	12	12	12	12	12	12	12	12
Lock - - - - -	395931	24	24	24	24	24	24	24	24	24	24	24	24
<b>Valve Spring Cover</b>													
Cover - - - - -	665689	2	2	2	2	2	2	2	2	2	2	2	2
Screw - - - - -	693960	4	4	4	4	4	4	4	4	4	4	4	4
Gasket - cover - - - - -	† 871935	2	2	2	2	2	2	2	2	2	2	2	2
Gasket - screw - - - - -	† 693959	4	4	4	4	4	4	4	4	4	4	4	4
<b>Valve Spring Cover Gasket Package</b>													
Package - - - - -	† 980584	1	1	1	1	1	1	1	1	1	1	1	1
<b>Valve Tappets</b>													
Assembly - standard - - - - -	866891	12	12	12	12	12	12	12	12	12	12	12	12
Assembly - .001 - - - - -	866892	12	12	12	12	12	12	12	12	12	12	12	12
Assembly - .008 - - - - -	1123383	12	12	12	12	12	12	12	12	12	12	12	12
Assembly - .030 - - - - -	1123384	12	12	12	12	12	12	12	12	12	12	12	12
Adjust screw - - - - -	681544	12	12	12	12	12	12	12	12	12	12	12	12
<b>GROUP 9-M ENGINE SUPPORTS</b>													
<b>NOTE: For parts not listed see frame Group-13</b>													
<b>Engine Front Support</b>													
Plate - - - - -	852266	1	1	..	..	..	..	1	1	..	..	..	..
Screw - - - - -	123567	2	2	..	..	..	..	2	2	..	..	..	..
Lockwasher - - - - -	120383	2	2	..	..	..	..	2	2	..	..	..	..
Plainwasher - - - - -	79783	2	2	..	..	..	..	2	2	..	..	..	..
Insulator assembly - - - - -	1115744	1	1	..	..	..	..	1	1	..	..	..	..
Insulator assembly - - - - -	1194430	..	..	1	1	1	1	..	..	1	1	1	1
Nut - - - - -	120368	4	4	4	4	4	4	4	4	4	4	4	4
Lockwasher - - - - -	120214	4	4	..	..	..	..	4	4	..	..	..	..
Lockwasher - - - - -	138485	..	..	4	4	4	4	..	..	4	4	4	4
Plainwasher - - - - -	120851	..	..	2	2	2	2	..	..	2	2	2	2
<b>Engine Rear Support</b>													
Bracket - - - - -	1262457	2	2	..	..	..	..	2	2	..	..	..	..
Insulator assembly - upper - Note 1 - - - - -	694164	2	2	..	..	..	..	..	..	..	..	..	..
Insulator assembly - upper - Note 2 - - - - -	1500455	2	2	..	..	..	..	2	2	..	..	..	..
Insulator assembly - lower - Note 1 - - - - -	1312511	2	2	..	..	..	..	..	..	..	..	..	..

Indicates amount used as required.

† Indicates parts included in packages.

