

PROPELLER SHAFT

Plate 36

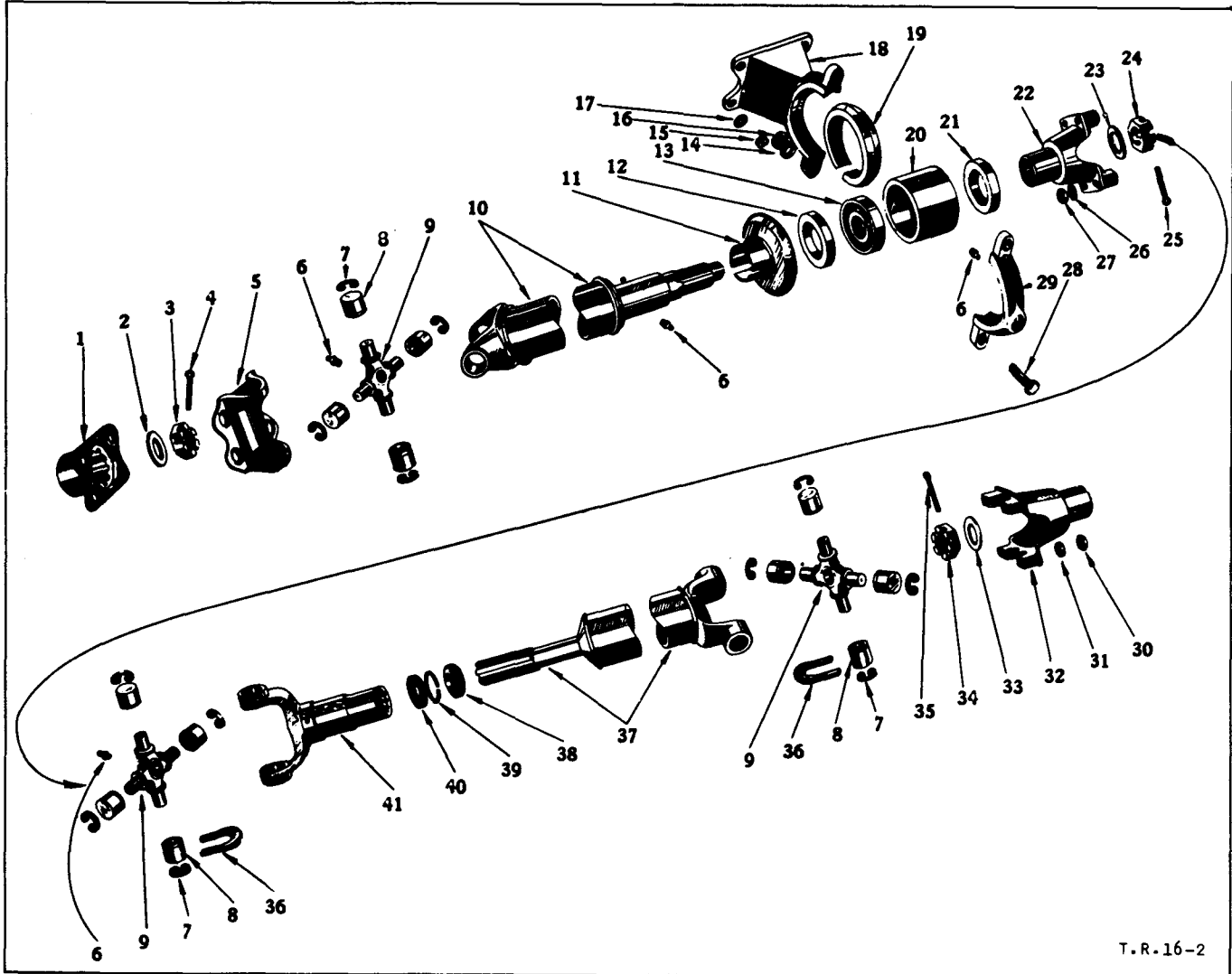

T.R. 16-2

Ref. No.	Part Name	Group	Ref. No.	Part Name	Group
1	Transmission mainshaft flange.....	16-E	21	Centre bearing oil seal.....	16-D
2	Transmission mainshaft nut washer.....	16-E	22	Centre bearing flange.....	16-E
3	Transmission mainshaft nut.....	16-E	23	Front propeller shaft nut washer.....	16-E
4	Transmission mainshaft nut cotter pin.....	16-E	24	Front propeller shaft nut.....	16-E
5	Propeller shaft companion flange or yoke....	16-E	25	Front propeller shaft nut cotter pin.....	16-E
6	Grease nipple.....	16-C	26	Centre bearing flange 'U' bolt lockwasher..	16-F
7	Universal joint cross bushing retainer.....	16-D	27	Centre bearing flange 'U' bolt nut.....	16-F
8	Universal joint cross bushing & roller assembly.....	16-C	28	Centre bearing bracket cap bolt.....	16-D
9	Universal joint cross & seal assy.....	16-C	29	Centre bearing bracket cap.....	16-D
10	Front propeller shaft assembly.....	16-A	30	Drive pinion flange 'U' bolt nut.....	16-F
11	Centre bearing mud slinger.....	16-D	31	Drive pinion flange 'U' bolt lockwasher....	16-F
12	Centre bearing oil seal.....	16-D	32	Drive pinion flange.....	16-E
13	Centre bearing assembly.....	16-D	33	Drive pinion nut washer.....	16-E
14	Centre bearing cap bolt lockwasher.....	16-D	34	Drive pinion nut.....	16-E
15	Centre bearing bracket bolt nut.....	16-D	35	Drive pinion nut cotter pin.....	16-E
16	Centre bearing cap bolt nut.....	16-D	36	Drive pinion flange 'U' bolt.....	16-F
17	Centre bearing bracket bolt lockwasher.....	16-D	37	Rear propeller shaft.....	16-A
18	Centre bearing bracket.....	16-D	38	Sliding yoke cap.....	16-B
19	Centre bearing insulator.....	16-D	39	Sliding yoke dust washer retainer.....	16-B
20	Centre bearing housing.....	16-D	40	Sliding yoke dust washer.....	16-B
			41	Sliding yoke assembly - includes plug.....	16-B



**GROUP 16 - PROPELLER SHAFT**

PART NAME	PART NO.	MODEL CODES										
		DG AND FO					DH AND FP					
		1	2	3	4	5	6	1	2	4	5	6
<b>GROUP 16-A PROPELLER SHAFT - (Cont'd)</b>												
<b>Center Propeller Shaft Tube</b>												
Assy - 192" W.B. - - - - -	1272729	..	..	..	1	..	..	..	..	..	..	..
Assy - 212" W.B. - - - - -	914725	..	..	..	..	..	1	..	..	..	..	..
<b>Rear Propeller Shaft Tube</b>												
Assy - 128" W.B. - single speed axle- - - -	1195344	..	..	1	1	..	..	..	..	..	..	..
Assy - 152" - 192" W.B. single speed axle -	914692	..	..	1	1	..	..	..	1	..	..	..
Assy - 170" W.B. single speed axle- - - -	1190116	..	..	..	1	..	..	..	..	..	..	..
Assy - 128" W.B. 2 speed axle - - - - -	1264627	..	..	..	1	..	..	..	..	..	..	..
Assy - 152" - 192" W.B. 2 speed axle- - - -	1264628	..	..	..	1	..	..	..	..	..	..	..
Assy - 170" W.B. 2 speed axle - - - - -	1264632	..	..	..	1	..	..	..	..	..	..	..
Assy - 128" W.B. single speed axle - Note 3	1195344	..	..	..	1	..	..	..	..	..	..	..
Assy - 128" W.B. single speed axle - Note 4	1390717	..	..	..	1	..	..	..	..	..	..	..
Assy - 152" W.B. single speed axle - Note 3	914692	..	..	..	1	..	..	..	..	..	..	..
Assy - 152" W.B. single speed axle - Note 4	1390718	..	..	..	1	..	..	..	..	..	..	..
Assy - 170" W.B. single speed axle - Note 3	1190116	..	..	..	1	..	..	..	..	1	..	..
Assy - 170" W.B. single speed axle - Note 4	1390719	..	..	..	1	..	..	..	..	1	..	..
Assy - 128" W.B. 2 speed axle - Note 3- - -	1264627	..	..	..	1	..	..	..	..	..	..	..
Assy - 128" W.B. 2 speed axle - Note 4- - -	1390720	..	..	..	1	..	..	..	..	..	..	..
Assy - 152" W.B. 2 speed axle - Note 3- - -	1264628	..	..	..	1	..	..	..	..	..	..	..
Assy - 152" W.B. 2 speed axle - Note 4- - -	914731	..	..	..	1	..	..	..	..	1	..	..
Assy - 170" W.B. 2 speed axle - Note 3- - -	1264632	..	..	..	1	..	..	..	..	..	..	..
Assy - 170" W.B. 2 speed axle - Note 4- - -	914732	..	..	..	1	..	..	..	..	1	..	..
Assy - 128" W.B. single speed axle- - - -	1196259	..	..	..	..	1	..	..	..	..	..	..
Assy - 140" W.B. single speed axle- - - -	914730	..	..	..	..	1	..	..	..	..	..	..
Assy - 152" W.B. single speed axle- - - -	914731	..	..	..	..	1	..	..	..	..	1	..
Assy - 170" W.B. single speed axle- - - -	914732	..	..	..	..	1	..	..	..	..	1	..
Assy - 212" W.B. single speed axle- - - -	914733	..	..	..	..	1	..	..	..	..	..	..
Assy - 128" W.B. Note "Y" - - - - -	1264644	..	..	..	..	1	..	..	..	..	..	..
Assy - 128" W.B. Note "Z" - - - - -	1196277	..	..	..	..	1	..	..	..	..	..	..
Assy - 140" W.B. Note "Y" 4 - - - - -	1264645	..	..	..	..	1	..	..	..	..	..	..
Assy - 140" W.B. Note "Z" - - - - -	1196278	..	..	..	..	1	..	..	..	..	..	..
Assy - 152" W.B. Note "Y" - - - - -	1264646	..	..	..	..	1	..	..	..	..	1	..
Assy - 152" W.B. Note "Z" - - - - -	1196279	..	..	..	..	1	..	..	..	..	..	..
Assy - 170" W.B. Note "Y" - - - - -	1264647	..	..	..	..	1	..	..	..	..	1	..
Assy - 170" W.B. Note "Z" - - - - -	1196280	..	..	..	..	1	..	..	..	..	..	..
Assy - 212" W.B. Note "Y" - - - - -	1264648	..	..	..	..	1	..	..	..	..	..	..
Assy - 212" W.B. Note "Z" - - - - -	1196281	..	..	..	..	1	..	..	..	..	..	..
Assy - 152" W.B. single speed axle- - - -	1390718	..	..	..	..	..	..	..	..	..	..	1
Assy - 170" W.B. single speed axle- - - -	1390719	..	..	..	..	..	..	..	..	..	..	1
Assy - 152" W.B. 2 speed axle - - - - -	1196279	..	..	..	..	..	..	..	..	..	..	1
Assy - 170" W.B. 2 speed axle - - - - -	1196280	..	..	..	..	..	..	..	..	..	..	1
<b>Propeller Shaft Guard-Rod Type-School Bus</b>												
Guard - front - - - - -	1264434	..	..	..	1	..	1	..	..	..	..	..
Guard - intermediate - short - 152" W.B.- -	1264434	..	..	..	1	..	..	..	..	..	..	..
Guard - intermediate - long - 152" W.B. - -	1264436	..	..	..	1	..	..	..	..	..	..	..
Guard - intermediate - 192" - 212" W.B. - -	1264434	..	..	..	4	..	4	..	..	..	..	..
Guard - rear - - - - -	1264436	..	..	..	1	..	1	..	..	..	..	..
Support - 4 on 152" W.B. - - - - -	1264437	..	..	..	5	..	4	..	..	..	..	..
Support - inter. guard - - - - -	1264808	..	..	..	1	..	2	..	..	..	..	..
Bolt- - - - -	121615	..	..	..	*	..	*	..	..	..	..	..
Bolt- - - - -	120677	..	..	..	*	..	*	..	..	..	..	..
Nut - - - - -	120369	..	..	..	*	..	*	..	..	..	..	..
Lockwasher- - - - -	120382	..	..	..	*	..	*	..	..	..	..	..
Nut - guard- - - - -	121358	..	..	..	*	..	*	..	..	..	..	..
Lockwasher- - - - -	121574	..	..	..	*	..	*	..	..	..	..	..
Check nut- - - - -	121358	..	..	..	*	..	*	..	..	..	..	..
<b>GROUP 16-B SLIDING YOKE</b>												
<b>Sliding Yoke</b>												
Assy - Note 1 - - - - -	1122693	1	..	..	..	..	..	..	..	..	..	..

Indicates amount used as required.

† Indicates parts included in packages.

**GROUP 16 - PROPELLER SHAFT**

PART NAME	PART NO.	MODEL CODES										
		DG AND FO					DH AND FP					
		1	2	3	4	5	6	1	2	4	5	6
<b>GROUP 16-B SLIDING YOKE (Cont'd)</b>												
<b>Sliding Yoke (Cont'd)</b>												
Assy - Note 2- - - - -	1270192	1	..	..	..	..	..	..	..	..	..	..
Assy - - - - -	914986	..	1	1	1	..	..	..	1	1	..	..
Assy - Note 3- - - - -	914986	..	..	..	..	1	..	..	..	..	..	..
Assy - Note 4- - - - -	582632	..	..	..	..	1	..	..	..	1	..	..
Assy - - - - -	582632	..	..	..	..	..	1	..	..	..	1	1
Cap - oil seal - Note 1 - - - - -	627250	1	..	..	..	..	..	..	..	..	..	..
Cap - oil seal - Note 2 - - - - -	1122677	1	..	..	..	..	..	1	..	..	..	..
Cap - dust washer - - - - -	582526	..	1	1	1	1	1	..	1	1	1	1
Oil seal - Note 1 - - - - -	627248	1	..	..	..	..	..	..	..	..	..	..
Oil seal - Note 2 - - - - -	604596	1	..	..	..	..	..	1	..	..	..	..
Dust seal - - - - -	582524	..	1	1	1	1	1	1	1	1	1	1
Washer - Note 1 - - - - -	627249	1	..	..	..	..	..	..	..	..	..	..
Washer - - - - -	582525	..	1	1	1	1	1	..	1	1	1	1
Plug - - - - -	582634	..	1	1	1	1	1	..	1	1	1	1
Grease nipple - - - - -	145433	..	1	1	1	1	1	..	1	1	1	1
Grease nipple - Note 1- - - - -	145433	1	..	..	..	..	..	..	..	..	..	..
Grease nipple - Note 2- - - - -	110347	1	..	..	..	..	..	1	..	..	..	..
<b>GROUP 16-C UNIVERSAL JOINT PACKAGE</b>												
<b>Universal Joint Package</b>												
Package - Note 1 - - - - -	1150809	1	..	..	..	..	..	..	..	..	..	..
Package - Note 2 - - - - -	1150810	1	..	..	..	..	..	1	..	..	..	..
Package - 4 used on 192" W.B.- - - - -	1057273	..	2	3	3	..	..	2	3	3	..	..
Package - Note 3 - - - - -	1057273	..	..	..	..	3	..	..	..	..	..	..
Package - Note 4 - - - - -	1106125	..	..	..	..	3	..	..	..	3	..	..
Package - 4 used on 212" W.B.- - - - -	1106125	..	..	..	..	..	3	..	..	..	3	3
Package - 128" W.B. - single prop shaft- - - - -	1106125	..	..	..	..	..	..	..	..	..	2	2
Dust seal - - - - -	604594	8	..	..	..	..	..	8	..	..	..	..
Dust seal - 16 used on 192" - 212" W.B. - - - - -	920487	..	8	12	12	12	12	..	8	12	12	12
Dust seal - 128" W.B. single prop shaft - - - - -	920487	..	..	..	..	..	..	..	..	..	8	8
Retainer - - - - -	604595	8	..	..	..	..	..	8	..	..	..	..
Retainer - 16 used on 192" - 212" W.B. - - - - -	920491	..	8	12	12	12	12	..	8	12	12	12
Retainer - 128" W.B.-single prop shaft - - - - -	920491	..	..	..	..	..	..	..	..	..	8	8
Bushing & roller - Note 1 - - - - -	†1122698	8	..	..	..	..	..	..	..	..	..	..
Bushing & roller - Note 2 - - - - -	†1122680	8	..	..	..	..	..	8	..	..	..	..
Bushing & roller - 16 used on 192" W.B. - - - - -	† 920488	..	8	12	12	..	..	8	12	12	..	..
Bushing & roller - Note 3 - - - - -	† 920488	..	..	..	..	12	..	..	..	..	..	..
Bushing & roller - Note 4 - - - - -	†1271284	..	..	..	..	12	..	..	..	12	..	..
Bushing & roller - 16 used on 212" W.B. - - - - -	†1271284	..	..	..	..	..	12	..	..	..	12	12
Bushing & roller - 128" W.B. single prop shaft- - - - -	†1271284	..	..	..	..	..	..	..	..	..	8	8
Retainer - - - - -	† 604593	6	..	..	..	..	..	6	..	..	..	..
Retainer - 16 used on 192" - 212" W.B. - - - - -	† 582520	..	6	12	12	12	12	..	6	12	12	12
Retainer - 128" W.B. single prop shaft - - - - -	† 582520	..	..	..	..	..	..	..	..	..	8	8
Grease nipple - 4 used on 192" - 212" W.B. - - - - -	110347	2	2	3	3	3	3	2	2	3	3	3
Relief valve assy - 4 used on 192" W.B. - - - - -	1091161	..	2	3	3	..	..	..	..	..	..	..
Relief valve assy - Note 3 - - - - -	1091161	..	..	..	..	3	..	..	..	..	..	..
<b>GROUP 16-D CENTER BEARINGS</b>												
<b>Center Bearing</b>												
Bearing - 2 used on 192" W. B. - - - - -	619166	..	..	1	1	..	..	..	..	..	..	..
Bearing - Note 3 - - - - -	619166	..	..	..	..	1	..	..	..	..	..	..
Bearing - Note 4 - - - - -	564728	..	..	..	..	1	..	..	..	..	..	..
Bearing - 2 used on 212" W.B.- - - - -	564728	..	..	..	..	..	1	..	..	1	1	1
Housing - 2 used on 192" W.B.- - - - -	562118	..	..	1	1	..	..	..	..	..	..	..
Housing - Note 3 - - - - -	562118	..	..	..	..	1	..	..	..	..	..	..
Housing - Note 4 - - - - -	564721	..	..	..	..	1	..	..	..	..	..	..
Housing - 2 used on 212" W.B.- - - - -	564721	..	..	..	..	..	1	..	..	..	..	..

Indicates amount used as required.

† Indicates parts included in packages.

**GROUP 16 - PROPELLER SHAFT**

PART NAME	PART NO.	MODEL CODES											
		DG AND FO				DH AND FP							
		1	2	3	4	5	6	1	2	4	5	6	7
<b>GROUP 16-D CENTER BEARING (Cont'd)</b>													
<b>Center Bearing (Cont'd)</b>													
Housing - - - - -	1394084	..	..	..	..	..	..	..	..	1	1	1	1
Insulator - 2 used on 192" - 212" W.B. - -	562119	..	..	1	1	1	1	..	..	..	..	..	..
Insulator- - - - -	1319902	..	..	..	..	..	..	..	..	2	2	2	2
Bracket - - - - -	1262652	..	..	1	1	1	..	..	..	..	..	..	..
Bracket - 128" W.B. - - - - -	1262652	..	..	..	..	..	1	..	..	..	..	..	..
Bracket - front - 192" - 212" W.B.- - - -	562120	..	..	..	1	..	1	..	..	..	..	..	..
Spacer - 192" W.B. - - - - -	1268691	..	..	..	2	..	..	..	..	..	..	..	..
Bracket - rear - 192" W.B.- - - - -	1262652	..	..	..	1	..	..	..	..	..	..	..	..
Bracket - 140" 152" 170" 212" W.B.- - - -	590443	..	..	..	..	..	1	..	..	..	..	..	..
Bracket - front - - - - -	1501128	..	..	..	..	..	..	..	..	1	1	1	1
Bracket - rear- - - - -	1501129	..	..	..	..	..	..	..	..	1	1	1	1
Cap - 2 used on 192" - 212" W.B. - - - -	562117	..	..	1	1	1	1	..	..	..	..	..	..
Bolt- - - - -	124133	..	..	*	*	*	*	..	..	..	..	..	..
Nut - - - - -	120370	..	..	*	*	*	*	..	..	..	..	..	..
Lockwasher- - - - -	120383	..	..	*	*	*	*	..	..	..	..	..	..
Bolt - brkt. to frame-8 used on 212" W.B.-	123852	..	..	4	4	4	4	..	..	..	..	..	..
Bolt - brkt. to frame-front 192" W.B.- -	124133	..	..	..	4	..	..	..	..	..	..	..	..
Bolt - brkt. to frame-rear 192" W.B. - - -	123852	..	..	..	4	..	..	..	..	..	..	..	..
Nut - - - - -	120370	..	..	*	*	*	*	..	..	..	..	..	..
Bolt - brkt. to frame- - - - -	123567	..	..	..	..	..	..	..	..	4	4	4	4
Plainwasher - - - - -	120395	..	..	*	*	*	*	..	..	4	4	4	4
Bolt - housing to brkt. - - - - -	124180	..	..	..	..	..	..	..	..	2	2	2	2
Nut - - - - -	126016	..	..	..	..	..	..	..	..	2	2	2	2
Spacer- - - - -	1394086	..	..	..	..	..	..	..	..	2	2	2	2
Oil seal - 4 used on 192" - 212" W.B.- - -	556939	..	..	2	2	2	2	..	..	2	2	2	2
Mud slinger - 2 used on 192" - 212" W.B. -	509977	..	..	1	1	1	1	..	..	..	..	..	..
Mud slinger- - - - -	1394087	..	..	..	..	..	..	..	..	1	1	1	1
Screw - - - - -	123316	..	..	*	*	*	*	..	..	..	..	..	..
Lockwasher- - - - -	121753	..	..	*	*	*	*	..	..	..	..	..	..
Plainwasher - - - - -	120392	..	..	*	*	*	*	..	..	..	..	..	..
Grease nipple- - - - -	145433	..	..	*	*	*	*	..	..	*	*	*	*
<b>GROUP 16-E FLANGES OR YOKES</b>													
<b>Rear Axle End Flange</b>													
Flange- - - - -	1270196	1	..	..	..	..	..	1	..	..	..	..	..
Flange- - - - -	1260889	..	1	..	..	..	..	..	1	..	..	..	..
Flange - single speed axle- - - - -	914695	..	..	1	1	..	..	..	..	1	..	..	..
Flange - 2 speed axle - - - - -	1264803	..	..	..	1	..	..	..	..	1	..	..	..
Flange - single speed axle - Note 3 - - - -	914595	..	..	..	1	..	..	..	..	..	..	..	..
Flange - single speed axle - Note 4 - - - -	1390721	..	..	..	..	1	..	..	..	1	..	..	..
Flange - 2 speed axle - Note 3- - - - -	1264803	..	..	..	..	1	..	..	..	..	..	..	..
Flange - 2 speed axle - Note 4- - - - -	1264709	..	..	..	..	1	..	..	..	1	..	..	..
Flange - Single speed axle- - - - -	914735	..	..	..	..	..	1	..	..	..	..	..	..
Flange - Note "Y" - - - - -	1264709	..	..	..	..	..	1	..	..	..	..	1	..
Flange - Note "Z" - - - - -	1196287	..	..	..	..	..	1	..	..	..	..	..	..
Flange- - - - -	1196287	..	..	..	..	..	..	..	..	..	..	..	1
Nut- - - - -	53553	1	..	..	..	..	..	1	..	..	..	..	..
Nut- - - - -	855094	..	1	..	..	..	..	..	1	..	..	..	..
Nut - use with 9 5/8" ring gear- - - - -	926228	..	1	..	..	..	..	..	1	..	..	..	..
Nut - single speed axle- - - - -	595988	..	..	1	1	1	..	..	..	1	1	..	..
Nut - 2 speed axle - - - - -	1192175	..	..	1	1	1	..	..	..	1	1	..	..
Nut - single speed axle- - - - -	571300	..	..	..	..	..	1	..	..	..	..	1	..
Nut - 2 speed axle - - - - -	1192175	..	..	..	..	..	1	..	..	..	..	1	1
Nut - single speed axle- - - - -	568526	..	..	..	..	..	..	..	..	..	..	..	1
Washer- - - - -	308466	..	1	..	..	..	..	1	1	..	..	..	..
Washer - single speed axle- - - - -	571301	..	..	1	1	1	1	..	..	1	1	1	..
Washer - 2 speed axle - - - - -	1390355	..	..	..	1	1	1	..	..	1	1	1	1
Cotter- - - - -	119209	1	1	1	1	1	1	1	1	1	1	1	1
<b>Center Bearing Flange</b>													
Flange- - - - -	914694	..	..	1	1	..	..	..	..	1	..	..	..
Flange - Note 3 - - - - -	914694	..	..	..	..	1	..	..	..	1	..	..	..

Indicates amount used as required.

† Indicates parts included in packages.

**GROUP 16 - PROPELLER SHAFT**

PART NAME	PART NO.	MODEL CODES										
		DG AND FO					DH AND FP					
		1	2	3	4	5	6	1	2	4	5	6
<b>GROUP 16-E FLANGES OR YOKES - (Cont'd)</b>												
<b>Center Bearing Flange (Cont'd)</b>												
Flange - Note 4 - - - - -	914734	..	..	..	..	1	..	..	..	1	..	..
Flange- - - - -	914734	..	..	..	..	..	1	..	..	..	1	1
Nut- - - - -	571300	..	..	1	1	1	1	..	..	1	1	1
Washer- - - - -	571301	..	..	1	1	1	1	..	..	1	1	1
Cotter- - - - -	119209	..	..	1	1	1	1	..	..	1	1	1
<b>Transmission End Flange</b>												
Flange- - - - -	1321325	1	..	..	..	..	..	1	..	..	..	..
Flange- - - - -	1191427	..	1	..	..	..	..	..	1	..	..	..
Flange - with 4 speed trans.- - - - -	582504	..	1	1	1	1	..	..	1	1	1	..
Flange - with 5 speed trans.- - - - -	596763	..	..	..	1	1	1	..	..	1	1	1
Nut- - - - -	600366	1	1	..	..	..	..	1	1	..	..	..
Nut - with 4 speed trans.- - - - -	562536	..	1	1	1	1	..	..	1	1	1	..
Nut - with 5 speed trans.- - - - -	564214	..	..	..	1	1	1	..	..	1	1	1
Washer- - - - -	308466	1	1	..	..	..	..	1	1	..	..	..
Washer - with 4 speed trans.- - - - -	556940	..	1	1	1	1	..	..	1	1	1	..
Cotter- - - - -	119209	1	1	1	1	1	1	1	1	1	1	1
<b>Companion Yoke or Flange</b>												
Yoke or flange- - - - -	1122682	1	..	..	..	..	..	1	..	..	..	..
Yoke or flange- - - - -	596845	..	1	1	1	..	..	..	1	1	..	..
Yoke or flange - Note 3 - - - - -	596845	..	..	..	..	1	..	..	..	..	..	..
Yoke or flange - Note 4 - - - - -	582509	..	..	..	..	1	..	..	..	1	..	..
Yoke or flange- - - - -	582509	..	..	..	..	..	1	..	..	..	1	1
<b>GROUP 16-F PROPELLER SHAFT ATTACHING PARTS</b>												
<b>Attaching Parts</b>												
U-Bolt- - - - -	1122683	2	..	..	..	..	..	2	..	..	..	..
U-Bolt - 6 on 192" - 212" W.B.- - - - -	914708	..	2	4	4	4	4	..	2	4	4	4
Nut- - - - -	120368	4	..	..	..	..	..	4	..	..	..	..
Nut- - - - -	120369	..	4	8	8	8	8	..	4	8	8	8
Lockwasher- - - - -	120382	4	4	8	8	8	8	4	4	8	8	8
Bolt - trans. end - - - - -	651470	4	..	..	..	..	..	4	..	..	..	..
Bolt - trans. end - - - - -	582512	..	4	4	4	4	4	..	4	4	4	4
Nut- - - - -	125913	4	..	..	..	..	..	4	..	..	..	..
Nut- - - - -	120370	..	4	4	4	4	4	..	4	4	4	4
Lockwasher- - - - -	138489	4	..	..	..	..	..	4	..	..	..	..
Lockwasher- - - - -	136857	..	4	4	4	4	4	..	4	4	4	4

**NOTES:**

Indicates amount used as required.

† Indicates parts included in packages.